

**WATER WELL RECORD (WWC-5)**

KOLAR DOC ID \_\_\_\_\_ WELL ID \_\_\_\_\_

**LOCATION OF WATER WELL**

Latitude		Longitude		Section		Township		Range		E W	Fraction	¼	¼	¼
Datum		Elevation		County										

**WATER WELL OWNER**

Name	
Business	
Address	
Well location  at owner's address	

**WELL WATER USE**

--

**WELL INFORMATION**

Depth of well: _____ ft.
Dry well
Static water level in well: _____ ft. measured below land surface on (mm/dd/yy): _____ measured above land surface on (mm/dd/yy): _____

**PERMIT & ID NUMBERS (AS REQUIRED)**

DWR Application No.: _____
KDHE / EPA Project Code: _____
Site Name: _____
KDHE UIC Class V Form Completed:    Yes    No
County Permit:    Yes    No    Permit ID: _____
Lease Name & Well #: _____
# of boreholes: _____    # of dewatering wells: _____

**CASING**

Type of blank casing used: _____
Casing type details: _____
Blank casing diameter: _____ inches
Was casing removed?    Yes    No
Top of casing is currently _____ feet _____ ground
Reason required if top of casing is now less than 5 feet below ground surface for a hand dug well or less than 3 feet below ground surface for all other types of wells.

**GROUT & PLUGGING MATERIALS**

Grout or Plugging interval (ft.)		Material	Description
From	To		

**COMMENTS**

--

**CONTRACTOR'S OR LANDOWNERS CERTIFICATION**

<p>This water well was plugged pursuant to the stated water well contractor's license and was completed on _____. I certify that this record is true to the best of my knowledge and belief. This water well record was completed on _____ under the business name of _____, Kansas Water Well Contractor's License No. _____ under the authority of the designated person as defined in K.A.R. 28-30-2(j) and signed and certified by the electronic signature of the designated person at its submittal _____.</p>
--

Send one copy to WATER WELL OWNER and retain one for your records.

NOTE: Figures exhibited within this report are only to be used within the context of this report. Placement of property lines, wells, structures, and roads is based on the available information from county appraiser maps, surveys, site visits, and/or previous vendor reports and should be considered approximate.

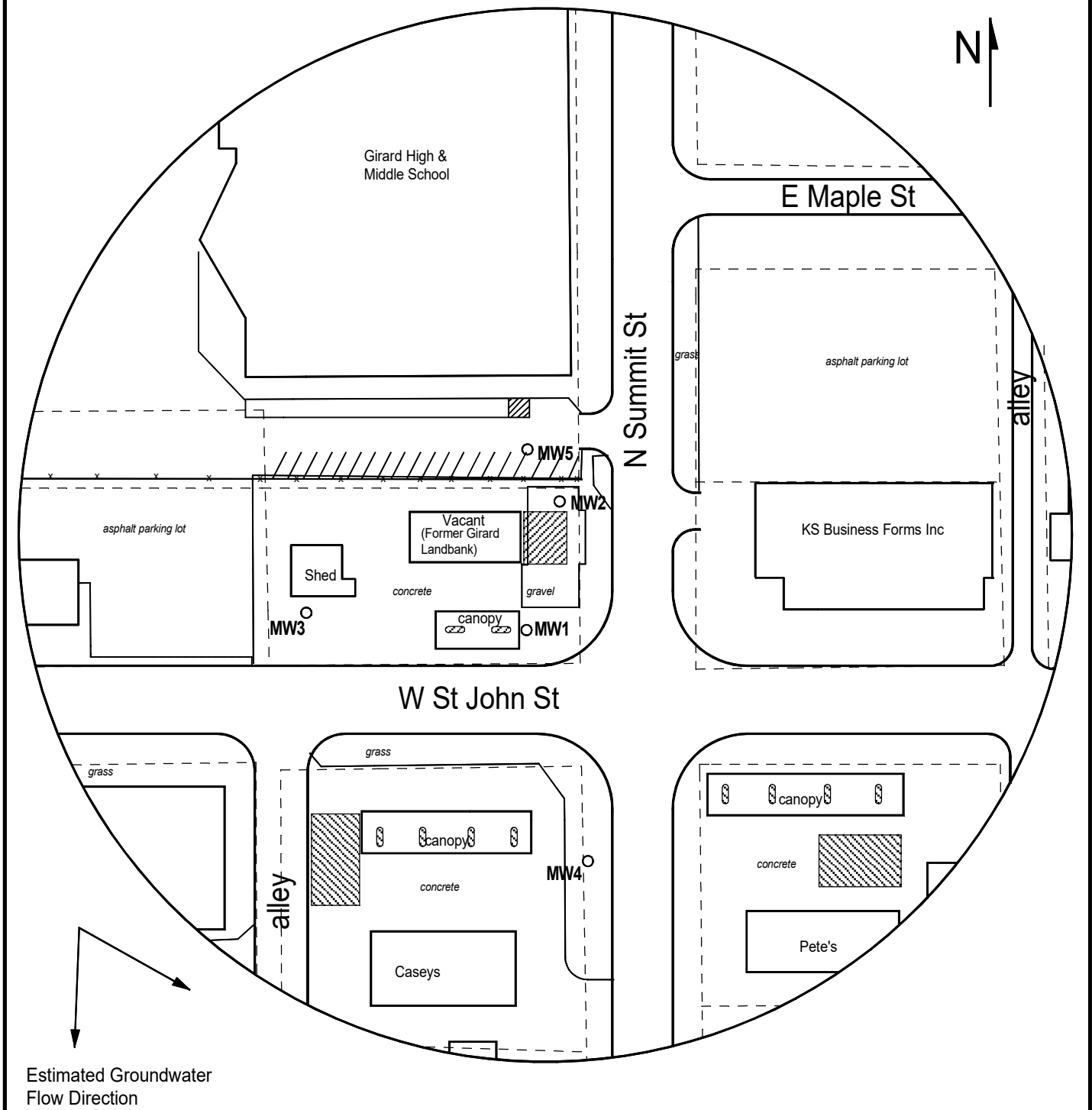

**FIGURE 1 - 350 FT RADIUS AREA BASE MAP**

**LEGEND:**

- Approximate Location of Former UST Basin and Pump Island
- Approximate Location of Active UST Basin and Pump Island
- Plugged Monitoring Well



**PROJECT:**

Girard Landbank  
100 W St. John  
Girard, KS  
U3-019-15488  
Date: 8/12/25

1311 E 25th St., Suite B (785) 841-8707 office  
Lawrence, KS 66046

0 100 ft