

**WATER WELL RECORD (WWC5.2)**

Constructed

KOLAR DOC ID \_\_\_\_\_ WELL ID \_\_\_\_\_

**LOCATION OF WATER WELL**

County	Section	Township	Range	<sup>E</sup> / <sub>W</sub> Fraction	¼	¼	¼
Latitude	Longitude	Datum	Elevation				

**WATER WELL LOCATION** \_\_\_\_\_ at owner's address

**WATER WELL OWNER**

Name	
Business	
Address	

**PERMIT & ID NUMBERS (AS REQUIRED)**

DWR Application No.: \_\_\_\_\_  
 KDHE / EPA Project Code: \_\_\_\_\_  
 Site Name: \_\_\_\_\_  
 KDHE UIC Class V Form Completed: Yes No  
 County/Local Permit Required? Yes No  
 Permit Obtained? Yes No Permit ID: \_\_\_\_\_  
 Oil/Gas Lease Name & Well #: \_\_\_\_\_

**CONSTRUCTION**

**Casing:** Height above land surface: \_\_\_\_\_ in.  
 Is casing height less than 12 inches? Yes No

Blank Casing type: \_\_\_\_\_  
 1st interval: \_\_\_\_\_ ft. to \_\_\_\_\_ ft.; Diameter \_\_\_\_\_ in.  
 Casing Joint: : \_\_\_\_\_ Weight: \_\_\_\_\_ lbs/ft  
 Wall thickness or gauge no.: \_\_\_\_\_  
 2nd interval: \_\_\_\_\_ ft. to \_\_\_\_\_ ft.; Diameter \_\_\_\_\_ in.  
 Casing Joint: : \_\_\_\_\_ Weight: \_\_\_\_\_ lbs/ft  
 Wall thickness or gauge no.: \_\_\_\_\_  
 3rd interval: \_\_\_\_\_ ft. to \_\_\_\_\_ ft.; Diameter \_\_\_\_\_ in.  
 Casing Joint: : \_\_\_\_\_ Weight: \_\_\_\_\_ lbs/ft  
 Wall thickness or gauge no.: \_\_\_\_\_

**Screen / Perforation material:** \_\_\_\_\_  
 Specify if other: \_\_\_\_\_  
 Screen / Perforation openings: \_\_\_\_\_  
 1st interval \_\_\_\_\_ ft. to \_\_\_\_\_ ft. Slot Size \_\_\_\_\_  
 2nd interval \_\_\_\_\_ ft. to \_\_\_\_\_ ft. Slot Size \_\_\_\_\_  
 3rd interval \_\_\_\_\_ ft. to \_\_\_\_\_ ft. Slot Size \_\_\_\_\_

**DESIGNATED PERSON**

**CONTRACTOR BUSINESS NAME**

**WELL WATER USE**

Additional info if required:  
 # of Boreholes \_\_\_\_\_ # of Dewatering Wells \_\_\_\_\_

**COMPLETION**

Depth of completed well: \_\_\_\_\_ ft.  
 Depth(s) groundwater encountered: Dry Well  
 (1) \_\_\_\_\_ ft.; (2) \_\_\_\_\_ ft.; (3) \_\_\_\_\_ ft.;  
 Static water level in well: \_\_\_\_\_ ft.  
 Date measured: \_\_\_\_\_  
 Measured from: Top of Casing or Ground Surface  
 Measured: Above or Below Land Surface

Estimated yield: \_\_\_\_\_ gpm  
 Pump Test Date: Water level was:  
 \_\_\_\_\_ ft. after \_\_\_\_\_ hours pumping \_\_\_\_\_ gpm  
 \_\_\_\_\_ ft. after \_\_\_\_\_ hours pumping \_\_\_\_\_ gpm

**Pump Information:**

Pump Installed? Yes No Date: \_\_\_\_\_  
 Pump Type: \_\_\_\_\_ Horsepower: \_\_\_\_\_ Volts: \_\_\_\_\_  
 Drop Pipe Diameter: \_\_\_\_\_ in. Drop Pipe Length: \_\_\_\_\_ ft.

Water well disinfected? Yes No  
 Date disinfected (mm/dd/yy): \_\_\_\_\_

**CONSTRUCTION**

<b>Borehole interval:</b> from _____ to _____ ft.	<b>Borehole diameter:</b> _____ in.
from _____ to _____ ft.	
from _____ to _____ ft..	

**Grout:**  
 1st Interval: \_\_\_\_\_ ft. to \_\_\_\_\_ ft. Grout material: \_\_\_\_\_  
 2nd Interval: \_\_\_\_\_ ft. to \_\_\_\_\_ ft. Grout material: \_\_\_\_\_  
 3rd Interval: \_\_\_\_\_ ft. to \_\_\_\_\_ ft. Grout material: \_\_\_\_\_

**Gravel pack:** \_\_\_\_\_ Not Used  
 1st Interval: \_\_\_\_\_ ft. to \_\_\_\_\_ ft. Gravel Size: \_\_\_\_\_  
 2nd Interval: \_\_\_\_\_ ft. to \_\_\_\_\_ ft. Gravel Size: \_\_\_\_\_  
 3rd Interval: \_\_\_\_\_ ft. to \_\_\_\_\_ ft. Gravel Size: \_\_\_\_\_

**WELL COMPLETION DATE**



# DENNIS L HANDKE

1820 NW 59th Terrace  
TOPEKA, KANSAS 66618  
785-286-4047 Home

Jess Chapman  
Larsen & Associates  
1311 E. 25<sup>th</sup> Street, Suite B  
Lawrence, Kansas, 66046

January 6, 2026

RE: Monitor Well Elevation Survey  
1601 Main St., Hays, Kansas

Proj. 26-00A  
Costal Mart #2504  
U6-026-11791

Bench Mark: Chisled Sq. on curb on the storm inlet on the Northwest corner of 16<sup>th</sup> & Main.  
Elev: 2001.23      North 1858.21      West 2824.04      (from SE Cor. Sec. 33-13-18W)

MW-13	rim	2005.60	North	2045.51	SE1/4,NE1/4,NE1/4,SW1/4
	top pipe	2005.20	West	2541.72	Lat= 38.87663 Long = 99.32680
MW-14	rim	2003.33	North	1912.22	SW1/4,SE1/4,NE1/4,SW1/4
	top pipe	2003.08	West	3034.57	Lat= 38.87626 Long = 99.32853

Lat & Long derived from Hays South 7.5 quad map. WGS84.

Elevation established from existing project.

If you have any questions, please feel free to call me. Thank you for the opportunity to be of service to you.

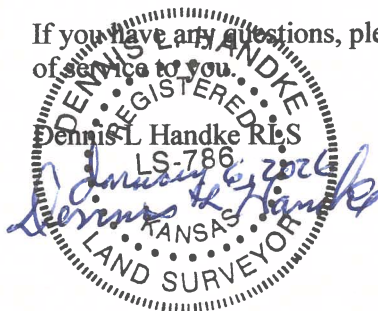

NOTE: Figures exhibited within this report are only to be used within the context of this report. Placement of property lines, wells, structures, and roads is based on the available information from county appraiser maps, surveys, site visits, and/or previous vendor reports and should be considered approximate.

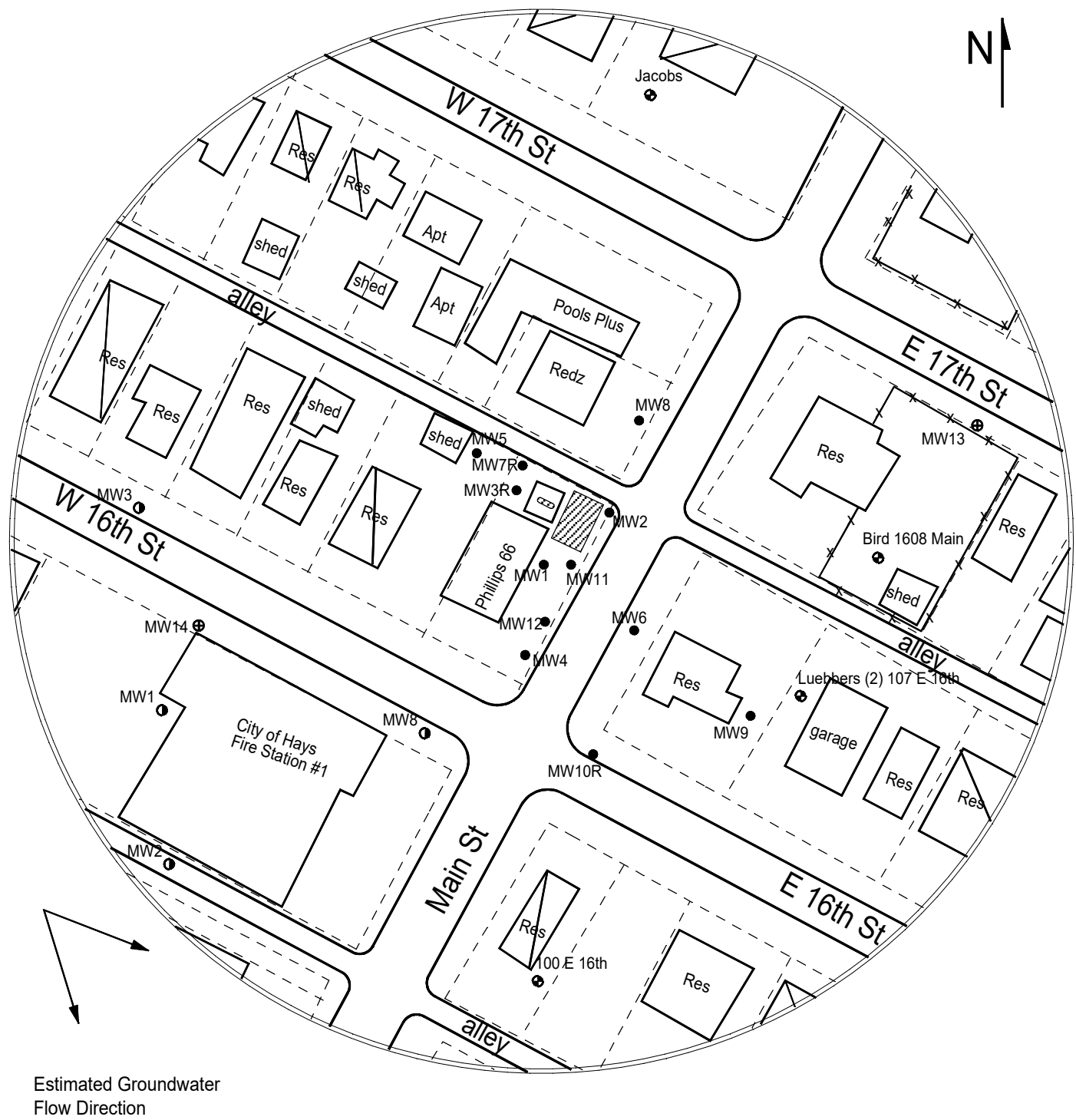
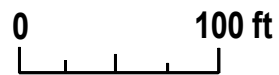

FIGURE 3 - 350 FT RADIUS AREA BASE MAP



1311 E 25th St., Suite B,  
Lawrence, KS 66046  
Office: (785) 841-8707

**PROJECT:**  
Coastal Mart #2504  
1601 Main Street,  
Hays, KS  
KDHE ID: U6-026-11791  
Date: 12/19/25



**LEGEND:**

- Approximate Location of Active UST Basin & Pump Island
  - Building with Basement
  - Approximate Location of Property Line
  - Existing Monitoring Well
  - Plugged Monitoring Well
  - Lawn & Garden Well
  - Monitoring Well (Hays Fire Dept)
  - New Monitoring Well (first year 15 x 47 ft bgs)
  - Soil Boring (Drilled 12/16-18/20) (1.5 - 3 ft bgs)
  - Sewer Lines (2 - 6 ft bgs)
  - Overhead Lines (25'-40' high)
  - Telephone (2 - 6 ft bgs)
  - Water Lines (1.5 - 3 ft bgs)
- NOTE: SB7 & SB8 will be drilled to collect hydrologic samples.  
NOTE: Utility depths, heights and locations are approximate.