

**KANSAS DRILLERS LOG**

API No. 15 — 063 — 20,395  
 County Number

S. 26 T. 15 R. 26 <sup>K</sup>/<sub>W</sub>

Loc. SW NW

Operator  
Exeter Exploration Co.

County Gove

Address  
2300 Lincoln Center Bldg. Denver, Colo 80264

Well No. #5-26 Lease Name McKinley

Footage Location  
660 feet from ~~XX~~(S) line 660 feet from ~~XX~~(W) line NW/4

Principal Contractor Blue Goose Drilling Geologist Al Hallock

Spud Date November 13, 1978 Total Depth 4570 P.B.T.D. N. A.

Date Completed November 20, 1978 Oil Purchaser N. A.

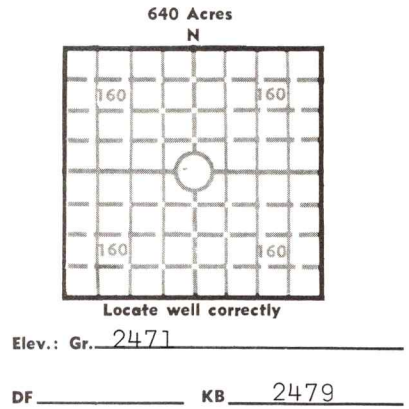

**CASING RECORD**

Report of all strings set — surface, intermediate, production, etc.

Purpose of string	Size hole drilled	Size casing set (in O.D.)	Weight lbs/ft.	Setting depth	Type cement	Sacks	Type and percent additives
Surface	12 1/4	8 5/8	28	308'	60-40 poz	220	3% CaCl

**LINER RECORD**

**PERFORATION RECORD**

Top, ft.	Bottom, ft.	Sacks cement	Shots per ft.	Size & type	Depth interval

Size	Setting depth	Packer set at

**ACID, FRACTURE, SHOT, CEMENT SQUEEZE RECORD**

Amount and kind of material used	Depth interval treated

**INITIAL PRODUCTION**

Date of first production		Producing method (flowing, pumping, gas lift, etc.)			
RATE OF PRODUCTION PER 24 HOURS	Oil	Gas	Water	Gas-oil ratio	
	bbls.	MCF	bbls.	CFPB	
Disposition of gas (vented, used on lease or sold)			Producing interval (s)		

INSTRUCTIONS: As provided in KCC Rule 82-2-125, within 90 days after completion of a well, one completed copy of this Drillers Log shall be transmitted to the State Geological Survey of Kansas, 4150 Monroe Street, Wichita, Kansas 67209. Copies of this form are available from the Conservation Division, State Corporation Commission, 3830 So. Meridian (P.O. Box 17027), Wichita, Kansas 66217. Phone AC 316-522-2206. If confidential custody is desired, please note Rule 82-2-125. Drillers Logs will be on open file in the Oil and Gas Division, State Geological Survey of Kansas, Lawrence, Kansas 66044.

Operator Exeter Exploration Company DESIGNATE TYPE OF COMP.: OIL, GAS, DRY HOLE, SWDW, ETC.:

Well No. 5-26 Lease Name McKinley Dry Hole

S T R E W

**WELL LOG**  
 Show all important zones of porosity and contents thereof; cored intervals, and all drill-stem tests, including depth interval tested, cushion used, time tool open, flowing and shut-in pressures, and recoveries. SHOW GEOLOGICAL MARKERS, LOGS RUN, OR OTHER DESCRIPTIVE INFORMATION.

FORMATION DESCRIPTION, CONTENTS, ETC.	TOP	BOTTOM	NAME	DEPTH
No Cores, No Tests			Stone Corral	1921
			Base St Corral	1957
			Heebner	3758
			Toronto	3781
			Lansing-KC	3798
			Base L-KC	4158
			Pawnee	4253
			Fort Scott	4318
			Cherokee	4345
			Mississippian	4412
		Great Guns	RA Guard	

USE ADDITIONAL SHEETS, IF NECESSARY, TO COMPLETE WELL RECORD.

Date Received \_\_\_\_\_  
 \_\_\_\_\_  
 Signature  
 District Geologist  
 Title  
 November 21, 1978  
 Date