

JUN 12 1972

27-15-26W

KANSAS DRILLERS LOG

S. 27 T. 15 R. 26W ^E/_W

API No. 15 — 063 Gove County — 20119 Number

Loc. C SE SE

County Gove

Operator
Chief Drilling Co., Inc. & Bill J. Porter

Address
Suite 905 Century Plaza, Wichita, Kansas 67202

Well No. _____ Lease Name
G. A. Wells

Footage Location
feet from (N) (S) line _____ feet from (E) (W) line _____

Principal Contractor
Company Tools Geologist
Robert Lewellyn

Spud Date
4/21/72 Total Depth
4477' P.B.T.D. _____

Date Completed
5/2/72 Oil Purchaser
Koch

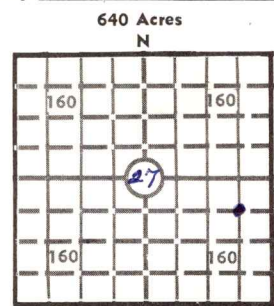

Elev.: Gr. 2532

DF 2534 KB 2537

CASING RECORD

Report of all strings set — surface, intermediate, production, etc.

Purpose of string	Size hole drilled	Size casing set (in O.D.)	Weight lbs/ft.	Setting depth	Type cement	Sacks	Type and percent additives
	12 1/4"	8 5/8"	28 Lb.	253'	quick set	175	
	7 7/8"	5 1/2"	15 1/2 Lb.	636'			
	7 7/8"	5 1/2"	14 1/2 Lb.	3805'	60/40 Pos.	250	10 Bbls. salt flush

LINER RECORD

PERFORATION RECORD

Top, ft.	Bottom, ft.	Sacks cement	Shots per ft.	Size & type	Depth interval

Size	Setting depth	Packer set at
2 3/8 O.D.	4445	None

ACID, FRACTURE, SHOT, CEMENT SQUEEZE RECORD

Amount and kind of material used	Depth interval treated
500 gal. 15% w/mud additive	open hole
2000 gal. 28%	

INITIAL PRODUCTION

Date of first production <u>June 1, 1972</u>		Producing method (flowing, pumping, gas lift, etc.) <u>Pumping</u>			
RATE OF PRODUCTION PER 24 HOURS	Oil <u>40</u> bbls.	Gas MCF	Water <u>2%</u> bbls.	Gas-oil ratio	CFPB
Disposition of gas (vented, used on lease or sold) <u>None</u>			Producing interval (s) <u>4441 - 4477'</u>		

INSTRUCTIONS: As provided in KCC Rule 82-2-125, within 90 days after completion of a well, one completed copy of this Drillers Log shall be transmitted to the State Geological Survey of Kansas, 4150 Monroe Street, Wichita, Kansas 67209. Copies of this form are available from the Conservation Division, State Corporation Commission, 3830 So. Meridian (P.O. Box 17027), Wichita, Kansas 66217. Phone AC 316-522-2206. If confidential custody is desired, please note Rule 82-2-125. Drillers Logs will be on open file in the Oil and Gas Division, State Geological Survey of Kansas, Lawrence, Kansas 66044.

DESIGNATE TYPE OF COMP.: OIL, GAS, DRY HOLE, SWDW, ETC.:

Operator
 Chief Drilling Co., Inc. & Bill J. Porter

Well No. 1 Lease Name G. A. Wells

Oil

S 27 T 15 R 26 W E W

WELL LOG

Show all important zones of porosity and contents thereof; cored intervals, and all drill-stem tests, including depth interval tested, cushion used, time tool open, flowing and shut-in pressures, and recoveries.

SHOW GEOLOGICAL MARKERS, LOGS RUN, OR OTHER DESCRIPTIVE INFORMATION.

FORMATION DESCRIPTION, CONTENTS, ETC.	TOP	BOTTOM	NAME	DEPTH
DST #1 3962 - 3980' Open 1 Hr. Weak blow for 30" Rec. 65' very slightly oil cut mud IBHP: 460# - 30" FBHP: 102# - 30" FP: 25 - 44#	3962	3980	Anhy. Base Anhy. Heeb. Tor. Lans. K. C. Base K. C. Pawnee	1954 1989 3671 3691 3811 3972 4112 4253
DST #2 4000 - 4075' Open 1 1/2 Hrs. Strong blow diminished to good Rec. 240' muddy water w/few specks oil 800' water w/scum of oil 400' water 2500' gas on top of test IBHP: 1205# - 30" FBHP: 1185# - 30" FP: 135 - 745#	4000	4075	Ft. Scott Miss. L. T. D.	4320 4413 4476
DST #3 4296 - 4342' Open 1 1/2 Hrs. Strong blow, gas to surface in 90" Rec. 300' clean oil 450' muddy gassy oil 42° IBHP: 970# - 30" FBHP: 810# - 30" FP: 61 - 345#	4296	4342		
DST #4 4386 - 4442' Open 30"; 30"; 30"; & 60" Weak blow for 5" Rec. 5' rotary mud IBHP: 75# - 30" FBHP: 70# - 30" FP: 35 - 40#	4386	4442		
DST #5 4437 - 4452' Open 2 Hrs. Weak Blow for 20" Rec. 65' rotary mud IBHP: 1277# - 30" FBHP: 995# - 30" FP: 25 - 62#			4437	4452
DST #6 4452 - 4467' Open 2 1/2 Hrs. Weak blow throughout Rec. 60' gas in drill pipe 35' clean gassy oil 100' muddy gassy oil IBHP: 1285# - 30" FBHP: 1005# - 60" FP: 30 - 95#			4452	4467

