

4-15-27W

API # 15-063-20,121

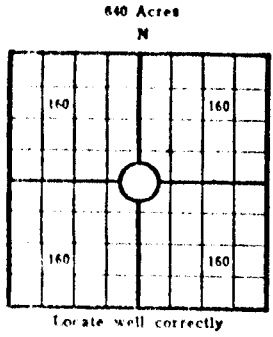

Lease Name: MAHONEY Well No. 1  
 Well Located: C. NW SE Some City  
SEC 4 TWP 15S RGE. 27W  
 Operator: Petroleum, Inc.  
 Address: 300 West Douglas, Wichita, Kansas  
 Elevation: Ground 2456' D.F. 2458' K.B. 2461'  
 Type Well: (Oil, gas, dry hole) Dry Hole A  
 Contractor: Gervey Drilling Company

Drilling Commenced: May 4 1972 Drilling Completed: May 13 1972  
 Well Completed: May 13 1972 Total Depth RTD 4315'  
 Initial Production: \_\_\_\_\_

Casing Record

Size: 8-5/8" Set at 246' Size: \_\_\_\_\_ Set at \_\_\_\_\_  
 Size: \_\_\_\_\_ Set at \_\_\_\_\_ Size: \_\_\_\_\_ Set at \_\_\_\_\_

Liner Record

Size: \_\_\_\_\_ Set from \_\_\_\_\_ To \_\_\_\_\_

Cementing

Casing Size	Sacks	Type Cement and Additives
<u>8-5/8"</u>	<u>175 sx.</u>	<u>2% cc, 2% gel</u>
_____	_____	_____
_____	_____	_____

Perforations

Formation	Perforated Interval and Number Shots
_____	_____
_____	_____
_____	_____

Electric Log Run. (Show type log and depths covered)

Snyder, Inc. Gamma Ray Log (4315 - 0)

4-15-27w

Show Drill Stem Tests,  
Well Stimulation and  
Production Tests

Formation            Top            Bottom

E. L. TOPS:

Heebner	3636	-1175
Toronto	3658	-1197
Lansing	3675	-1214
Fort Scott	4174	-1713
Mississippi	4272	-1811
ELTD	4315	-1854

DST #1: 3858-79: Packer Failure

DST #2: 3866-79: 30-30-30-30; very weak  
blow 30"; 70' drilling mud; LFP 35#-35#,  
1BHP 1160#, 2FP 35#-35#, 2BHP 1102#

DST #3: 3909-70: 30-30-30-30; fair to good  
blow; 180' muddy salt water with a slight  
show of oil; LFP 35#-71#, 1BHP 939#,  
2FP 95#-118#, 2BHP 904#

- 40' Surface Soil
- 247' Clay & Shale
- 1115' Shale
- 1460' Shale & Shells
- 1655' D-Sand
- 1712' Shale & Red Bed
- 1942' Anhydrite
- 2135' Shale & Shells
- 2398' Shale & Lime
- 2500' Lime & Shale
- 3765' Lime
- 4315' Lime
- 4315' RTD

LOG TOPS

* ANHY	1896
HEEB	3636
TOR	3658
LANS	3675
FT SC	4174
MISS	4272
LTD & RTD	4315

\*SMP TOP

