

KANSAS

WELL COMPLETION REPORT AND
DRILLER'S LOG

State Geological Survey
WICHITA BRANCH

S. 19 T. 15 R. 26W E

Loc. N/2 NE NE

County Gove

API No. 15 — 63 — 20,462
County Number

Operator
Kansas Oil Corporation

Address
250 N. Rock Rd, Suite 300, Wichita, KS 67206

Well No. #1 Lessee Name Garvey Ranch

Footage Location
330 feet from (N) (S) line 660 feet from (E) (W) line

Principal Contractor Spartan Geologist Bob Laymon

Spud Date 5-26-80 Date Completed 6-8-80 Total Depth 4435' P.B.T.D.

Directional Deviation None Oil and/or Gas Purchaser D & A

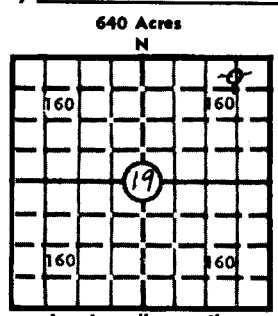

Elev.: Gr. 2496'

DF 2502' KB 2504'

CASING RECORD

Report of all strings set — surface, intermediate, production, etc.

Purpose of string	Size hole drilled	Size casing set (in O.D.)	Weight lbs/ft.	Setting depth	Type cement	Sacks	Type and percent additives
Surface		8 5/8"		334'	common	185	2% gel 3% CaCl

LINER RECORD

PERFORATION RECORD

Top, ft.	Bottom, ft.	Sacks cement	Shots per ft.	Size & type	Depth interval

TUBING RECORD

Size	Setting depth	Packer set at

ACID, FRACTURE, SHOT, CEMENT SQUEEZE RECORD

Amount and kind of material used	Depth interval treated

INITIAL PRODUCTION

D & A

Date of first production	Producing method (flowing, pumping, gas lift, etc.)				
RATE OF PRODUCTION PER 24 HOURS	Oil bbls.	Gas MCF	Water bbls.	Gas-oil ratio CFPB	
Disposition of gas (vented, used on lease or sold)			Producing interval (s)		

INSTRUCTIONS: As provided in KCC Rule 82-2-125, within 90 days after completion of a well, one completed copy of this Drillers Log shall be transmitted to the State Geological Survey of Kansas, 4150 Monroe Street, Wichita, Kansas 67209. Copies of this form are available from the Conservation Division, State Corporation Commission, 245 No. Water, Wichita, Kansas 67202. Phone AC 316-522-2206. If confidential custody is desired, please note Rule 82-2-125. Drillers Logs will be on open file in the Oil and Gas Division, State Geological Survey of Kansas, Lawrence, Kansas 66044.

Operator
 Kansas Oil Corporation

DESIGNATE TYPE OF COMP.: OIL, GAS,
 DRY HOLE, SWDW, ETC.:

Well No. #1 Lease Name Garvey Ranch Dry Hole

S 19 T 15 R26W E W

WELL LOG

Show all important zones of porosity and contents thereof; cored intervals, and all drill-stem tests, including depth interval tested, cushion used, time tool open, flowing and shut-in pressures, and recoveries.

SHOW GEOLOGICAL MARKERS, LOGS RUN, OR OTHER DESCRIPTIVE INFORMATION.

FORMATION DESCRIPTION, CONTENTS, ETC.	TOP	BOTTOM	NAME	DEPTH
Anhydrite	1924			
Heebner	3738			
Lansing	3781			
Lansing "H" Zone	3947			
Lansing "J" Zone	4007			
B/KC	4074			
Pawnee	4217			
Ft. Scott	4280			
Cherokee	4308			
Mississippian	4372			
No DST's run.				

USE ADDITIONAL SHEETS, IF NECESSARY, TO COMPLETE WELL RECORD.

Date Received	<i>Michael R Bryan</i> Signature
	Michael R Bryan Title
	7-30-81 Date