

SIDE ONE

STATE CORPORATION COMMISSION OF KANSAS
OIL & GAS CONSERVATION DIVISION
WELL COMPLETION FORM
ACO-1 WELL HISTORY
DESCRIPTION OF WELL AND LEASE

Operator: License # 5886

Name: Chief Drilling Co., Inc.

Address 224 E. Douglas, #530

City/State/Zip Wichita, KS 67202

Purchaser: None

Operator Contact Person: Douglas W. Thimesch

Phone (316) 262-3791

Contractor: Name: Warrior Drilling Co.

License: 5883

Wellsite Geologist: Ron Dulos

Designate Type of Completion
 New Well Re-Entry Workover
 Oil SWD Temp. Abd.
 Gas Inj Delayed Comp.
 Dry Other (Core, Water Supply, etc.)

If OWMO: old well info as follows:
Operator: _____

Well Name: _____

Comp. Date _____ Old Total Depth _____

Drilling Method:
 Mud Rotary Air Rotary Cable

12-14-89 12-21-89 12-21-89
Spud Date Date Reached TD Completion Date

API NO. 15- 063-21,303

County Gove

NW SE NW Sec. 26 Twp. 15S Rge. 27 East West

3630 Ft. North from Southeast Corner of Section

3630 Ft. West from Southeast Corner of Section
(NOTE: Locate well in section plat below.)

Lease Name Ownes Well # 1-26

Field Name Whitney West

Producing Formation none

Elevation: Ground 2484 KB 2491

Total Depth 4400 PBTD ----

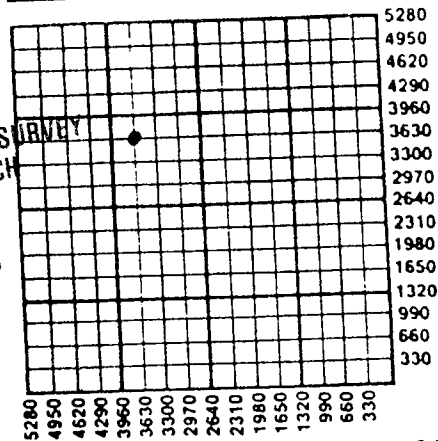

KANSAS GEOLOGICAL SURVEY
WICHITA BRANCH

JAN 03 1990

Amount of Surface Pipe Set and Cemented at 259 Feet

Multiple Stage Cementing Collar Used? Yes No

If yes, show depth set _____ Feet

If Alternate II completion, cement circulated from _____

feet depth to _____ w/ _____ sx cmt.

INSTRUCTIONS: This form shall be completed in triplicate and filed with the Kansas Corporation Commission, 200 Colorado Derby Building, Wichita, Kansas 67202, within 120 days of the spud date of any well. Rule 82-3-130, 82-3-107 and 82-3-106 apply. Information on side two of this form will be held confidential for a period of 12 months if requested in writing and submitted with the form. See rule 82-3-107 for confidentiality in excess of 12 months. One copy of all wireline logs and drillers time log shall be attached with this form. ALL CEMENTING TICKETS MUST BE ATTACHED. Submit CP-4 form with all plugged wells. Submit CP-111 form with all temporarily abandoned wells. Any recompletion, workover or conversion of a well requires filing of ACO-2 within 120 days from commencement date of such work.

All requirements of the statutes, rules and regulations promulgated to regulate the oil and gas industry have been fully complied with and the statements herein are complete and correct to the best of my knowledge.

Signature Douglas W. Thimesch
Title Vice Pres. Exploration Date 12-29-89

Subscribed and sworn to before me this 29 day of December, 19 89.

Notary Public Betty M. Abbott
Date Commission Expires 1-22-91

BETTY M. ABBOTT
NOTARY PUBLIC
STATE OF KANSAS
My Appt. Exp. 1-22-91

K.C.C. OFFICE USE ONLY
 Letter of Confidentiality Attached
 Wireline Log Received
 Drillers Timelog Received
Distribution
 KCC SWD/Rep NGPA
 KGS Plug Other (Specify)