

KANSAS DRILLERS LOG

API No. 15 — 063 — 20,378
County Number

S. 14 T. 15 R. 28 ^X W

Loc. SE SW NE

County Gove

Operator

T & D Oil Company

Address

Box 278 Victoria, Kansas 67671

Well No.

#1

Lease Name

Bentley "A-1"

Footage Location

330 feet from (M) (S) line 330 feet from (E) (W) line

Principal Contractor

Lawbanco

Geologist

Kenneth Vehige

Spud Date

7-16-78

Total Depth

4310

P.B.T.D.

4269

Date Completed

7-28-78

Oil Purchaser

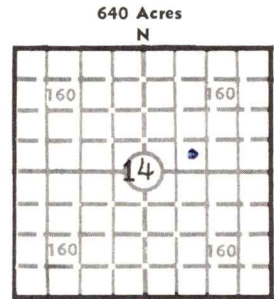

Locate well correctly

Elev.: Gr. 2494

DF 2496 KB 2499

CASING RECORD

Report of all strings set — surface, intermediate, production, etc.

Purpose of string	Size hole drilled	Size casing set (in O.D.)	Weight lbs/ft.	Setting depth	Type cement	Sacks	Type and percent additives
Surface	12 1/4	8 5/8	28	205	Common	150	
Production	7 7/8	4 1/2	9 1/2	4295	Common	225	10% Salt

LINER RECORD

PERFORATION RECORD

Top, ft.	Bottom, ft.	Sacks cement	Shots per ft.	Size & type	Depth interval
			Four	D.P.	3901-06

Size	Setting depth	Packer set at
2 3/8	4264	

ACID, FRACTURE, SHOT, CEMENT SQUEEZE RECORD

Amount and kind of material used	Depth interval treated
500 gal. 15% non-e	3901-06

INITIAL PRODUCTION

Date of first production 8-20-78	Producing method (flowing, pumping, gas lift, etc.) Pumping			
RATE OF PRODUCTION PER 24 HOURS	Oil 50 bbls.	Gas MCF	Water bbls.	Gas-oil ratio CFPB
Disposition of gas (vented, used on lease or sold)		Producing interval(s) 3901-06		

INSTRUCTIONS: As provided in KCC Rule 82-2-125, within 90 days after completion of a well, one completed copy of this Drillers Log shall be transmitted to the State Geological Survey of Kansas, 4150 Monroe Street, Wichita, Kansas 67209. Copies of this form are available from the Conservation Division, State Corporation Commission, 3830 So. Meridian (P.O. Box 17027), Wichita, Kansas 66217. Phone AC 316-522-2206. If confidential custody is desired, please note Rule 82-2-125. Drillers Logs will be on open file in the Oil and Gas Division, State Geological Survey of Kansas, Lawrence, Kansas 66044.

Operator T&D Oil Company		DESIGNATE TYPE OF COMP.: OIL, GAS, DRY HOLE, SWDW, ETC.: Oil
Well No. A-1	Lease Name Bentley	
S 14 T 15 R 28 E W		

WELL LOG

Show all important zones of porosity and contents thereof; cored intervals, and all drill-stem tests, including depth interval tested, cushion used, time tool open, flowing and shut-in pressures, and recoveries.

SHOW GEOLOGICAL MARKERS, LOGS RUN, OR OTHER DESCRIPTIVE INFORMATION.

FORMATION DESCRIPTION, CONTENTS, ETC.	TOP	BOTTOM	NAME	DEPTH
DST#1 Recovered: 780' Salt Water Pressure: IFP:27-153# in 30 min. ISIP:1054# in 30 min. FFP:156-303# in 30 min. FSIP:1051# in 30 min.	3666	3690	Log Tops; Anhydrite Heebner Toronto Lansing BKC Marmanton *Ft. Scott *Mississippi *RTD	1932 (+567) 3631 (-1132) 3651 (-1152) 3669 (-1170) 3983 (-1484) 4009 (-1510) 4169 (-1670) 4269 (-1770) 4310 (-1811)
DST#2 Recovered: 20' SOCM with FSFO. Pressure: IFP:14-14# in 20 min. ISIP:123# in 30 min. FFP:14-14# in 15 min. FSIP:55# in 20 min.	3746	3761		
DST#3 Recovered 15' Mud with FSO Pressure: IFP:14-14# in 30 min. ISIP:68# in 30 min. FFP&FSIP: Not Taken	4016	4085	*Sample Tops	
DST#4 Recovered: 245' Gassy Oil, 120' (Straddle) Muddy gassy oil, 590' HOGCM, 20' water. Pressure: IFP:109-342# in 15 min. ISIP:1268# in 30 min. FFP:369#-437# in 15 min. FSIP:1241# in 30 min.	3878	3937		
Completion: MICT, Swabbed hole dry, Perf. 3901-06 20shots. 2700' FU/12hrs. all oil. Swabbed 4.23 BOPH for 6 hrs. natural. 2100' FU/12hrs. all oil. Acidized with 500 gals. Swabbed back load, Swabbed 16.21 BOPH 1000' above Perfs. for 3hrs. 2900 FU/12hrs. POP. WOST				

USE ADDITIONAL SHEETS, IF NECESSARY, TO COMPLETE WELL RECORD.

Date Received	 Signature
	Operator Title
	8-15-78 Date