

State Geological Survey  
WICHITA, BRANCH

**KANSAS DRILLERS LOG**

S. 5 T. 15 R. 29 <sup>R</sup>/<sub>W</sub>  
 Loc. W2 NW NW  
 County Gove

API No. 15 — 063 — 20,309  
 County Number

Operator  
Energy Reserves Group, Inc.

Address  
1022 Hoover Great Bend, Kansas 67530

Well No. #4 Lease Name D. A. Phelps

Footage Location  
500 feet from (N) ~~X~~ line 500 feet from ~~X~~ (W) line

Principal Contractor Slawson Drlg. Co. Geologist Robert Hammond

Spud Date 8-24-76 Total Depth 4350' P.B.T.D. 4325'

Date Completed 9-30-76 Oil Purchaser

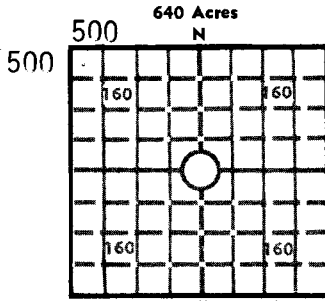

Elev.: Gr. 2611  
 DF 2613 KB 2616

**CASING RECORD**

Report of all strings set — surface, intermediate, production, etc.

Purpose of string	Size hole drilled	Size casing set (in O.D.)	Weight lbs/ft.	Setting depth	Type cement	Sacks	Type and percent additives
Surface	12 1/4"	8-5/8		282'	50-50 poz	175	2% gel & 2% CC

**LINER RECORD**

**PERFORATION RECORD**

Top, ft.	Bottom, ft.	Sacks cement	Shots per ft.	Size & type	Depth interval

**TUBING RECORD**

Size	Setting depth	Packer set at

**ACID, FRACTURE, SHOT, CEMENT SQUEEZE RECORD**

Amount and kind of material used	Depth interval treated

**INITIAL PRODUCTION**

Date of first production <u>9-30-76</u>	Producing method (flowing, pumping, gas lift, etc.) <u>pump</u>		
RATE OF PRODUCTION PER 24 HOURS	Oil <u>10 BOPD</u> bbis.	Gas <u>198 BWPD</u> bbis.	Water <u>198 BWPD</u> bbis.
Disposition of gas (vented, used on lease or sold)		Producing interval (s)	

INSTRUCTIONS: As provided in KCC Rule 82-2-125, within 90 days after completion of a well, one completed copy of this Drillers Log shall be transmitted to the State Geological Survey of Kansas, 4150 Monroe Street, Wichita, Kansas 67209. Copies of this form are available from the Conservation Division, State Corporation Commission, 3830 So. Meridian (P.O. Box 17027), Wichita, Kansas 66217. Phone AC 316-522-2206. If confidential custody is desired, please note Rule 82-2-125. Drillers Logs will be on open file in the Oil and Gas Division, State Geological Survey of Kansas, Lawrence, Kansas 66044.

Operator **ERG** DESIGNATE TYPE OF COMP.: OIL, GAS, DRY HOLE, SWDW, ETC.: **oil well**

Well No. **4** Lease Name **D. A. Phelps**

S **5** T **15** R **29** <sup>KX</sup>  
W

**WELL LOG**

Show all important zones of porosity and contents thereof; cored intervals, and all drill-stem tests, including depth interval tested, cushion used, time tool open, flowing and shut-in pressures, and recoveries. SHOW GEOLOGICAL MARKERS, LOGS RUN, OR OTHER DESCRIPTIVE INFORMATION.

FORMATION DESCRIPTION, CONTENTS, ETC.	TOP	BOTTOM	NAME	DEPTH
DST #1 4080-4125, 30-60-60-120" weak blow, dead 8", rec. 15' mud, FP 50-63 & 63-63, SIP 463-463#			ANHYDRITE	2006 + 610
			Heebner	3632 -1016
			Lansing	3669 -1053
			BC 2N	3700 -1084
			Muncie Sh	3823 -1207
			Stark Sh	3906 -1290
DST #2 4250-90, 30-60-60-120" weak blow, dead 22", Rec. 25' Very Slight oil cut mud, about 1" free oil on top tool. FP 50-63 & 63-33, SIP 1152-1104			Hushpuckney	
			sh.	3940 -1324
			Base KC	3984 -1374
DST #3 - Tool didn't open.			Marmaton	4006 -1390
			Pawnee	4096 -1480
DST #4 Packer failure			Ft. Scott	4161 -1535
			Cherokee	4186 -1570
DST #5 4280-4307, 30-60-60-120, GBTT, Rec. 120' OCM (30% Oil), 60' OC wtry mud, FP 50-75 & 88-113, SIP 1092-1068, Hydro 2188-2163 Temp. 126 deg.			Johnson	4244 -1628
			Miss. Dolo	4269 -1653
			Drlg. break)	4291 -1675
			)	4305 -1689

USE ADDITIONAL SHEETS, IF NECESSARY, TO COMPLETE WELL RECORD.

Date Received	<i>Robert W. Patton</i>
	Robert W. Patton <small>Signature</small>
	Mid-Continent District Exploration Mgr. <small>Title</small>
	Nov. 22, 1976 <small>Date</small>