

PT

State Geological Survey
WICHITA BRANCH

WELL COMPLETION REPORT AND
DRILLER'S LOG

S.14 T.6S R.3 E.
WX

API No. 15 — 027 — 20,014
County Number

Loc. SE SW-SW

County Clay

Operator
Pendleton Land and Exploration, Inc.

Address
23 Inverness Way East, Englewood, CO 80112

Well No. 1 Lease Name Musselman

Footage Location
330 feet from (X) (S) line 990 feet from (X) (W) line

Principal Contractor Materi Drig. Rig 44 Geologist Perry Hand

Spud Date 4 May Date Completed 10 May 1980 Total Depth 2165 P.B.T.D.

Directional Deviation None Taken Oil and/or Gas Purchaser D + A

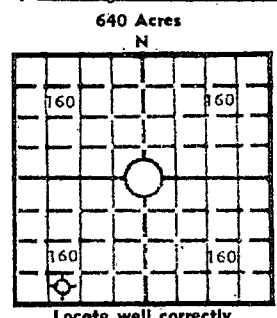

Elev.: Gr. 1304

DF 1307 KB 1309

CASING RECORD

Report of all strings set — surface, intermediate, production, etc.

Purpose of string	Size hole drilled	Size casing set (in O.D.)	Weight lbs/ft.	Setting depth	Type cement	Sacks	Type and percent additives
Surface	8 3/4"	7"	20	220	Common	60	

LINER RECORD

PERFORATION RECORD

Top, ft.	Bottom, ft.	Sacks cement	Shots per ft.	Size & type	Depth interval

Size	Setting depth	Packer set at

ACID, FRACTURE, SHOT, CEMENT SQUEEZE RECORD

Amount and kind of material used	Depth interval treated
Plugged 25 Sx at 250'	Gilbert Toman, S.C.C.
10 Sx at 50'	

INITIAL PRODUCTION

Date of first production	Producing method (flowing, pumping, gas lift, etc.)				
RATE OF PRODUCTION PER 24 HOURS	Oil	Gas	Water	Gas-oil ratio	CFPB
Disposition of gas (vented, used on lease or sold)	bbls.	MCF	bbls.		
				Producing interval(s)	D + A

INSTRUCTIONS: As provided in KCC Rule 82-2-125, within 90 days after completion of a well, one completed copy of this Drillers Log shall be transmitted to the State Geological Survey of Kansas, 4150 Monroe Street, Wichita, Kansas 67209. Copies of this form are available from the Conservation Division, State Corporation Commission, 245 No. Water, Wichita, Kansas 67202. Phone AC 316-522-2206. If confidential custody is desired, please note Rule 82-2-125. Drillers Logs will be on open file in the Oil and Gas Division, State Geological Survey of Kansas, Lawrence, Kansas 66044.

Operator **Pendleton Land and Exploration, Inc.** DESIGNATE TYPE OF COMP.: OIL, GAS, DRY HOLE, SWDW, ETC.:

Well No. **1** Lease Name **Musselman** Dry Hole

S 14 T 6SR 3 E

WELL LOG
 Show all important zones of porosity and contents thereof; cored intervals, and all drill-stem tests, including depth interval tested, cushion used, time tool open, flowing and shut-in pressures, and recoveries. SHOW GEOLOGICAL MARKERS, LOGS RUN, OR OTHER DESCRIPTIVE INFORMATION.

FORMATION DESCRIPTION, CONTENTS, ETC.	TOP	BOTTOM	NAME	DEPTH
No core, No DST				KB 1309
			Heeb	1527-218
			Lansing	1616-307
			BKC	1943-634
			Miss CHT	2046-737
			Miss 1st Line	2064-755
			Kind. SH	2098-789
			Driller TD	2154-845
			ELog TD	2165-856
				Petrolog CD-N IES BHC
			SmpIs delivered to K,G,S	

USE ADDITIONAL SHEETS, IF NECESSARY, TO COMPLETE WELL RECORD.

Date Received _____

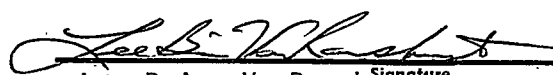
 Lee Brian VanRamshorst
 Manager of Operations
 Title
 June 11, 1981
 Date

REVISION