

**WELL COMPLETION REPORT AND DRILLER'S LOG**

WICHITA BRANCH  
S. WICHITA T. 28 R. 5 E XX  
Loc. 150 FEL 2460 FSL SW $\frac{1}{4}$

County Wilson

API No. 15 — 205 — 20,919  
County Number

Operator  
Tech-American Kansas

Address  
Box 467 Moran, Kansas 66755

Well No. 21 Lease Name Keith

Footage Location  
2460 feet from ~~XX~~ (S) line 150 feet from (E) ~~XX~~ line SW $\frac{1}{4}$

Principal Contractor Geologist

Spud Date ~~5-25-80~~ 7-26-80 Date Completed 8-8-80 Total Depth ~~1050~~ 1075 P.B.T.D.

Directional Deviation Oil and/or Gas Purchaser  
Oil

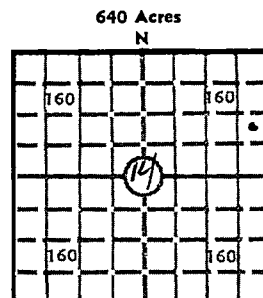

Elev.: Gr. 920  
DF            KB           

**CASING RECORD**

Report of all strings set — surface, intermediate, production, etc.

Purpose of string	Size hole drilled	Size casing set (in O.D.)	Weight lbs/ft.	Setting depth	Type cement	Sacks	Type and percent additives
surface	8 $\frac{1}{4}$	<del>4</del> 6 $\frac{1}{2}$	11	45	Portland	3	3% Cal.
producing	5 $\frac{1}{4}$	2 $\frac{1}{2}$	6.4	1055	Portland A	109	4sx Prem. Gel

**LINER RECORD**

**PERFORATION RECORD**

Top, ft.	Bottom, ft.	Sacks cement	Shots per ft.	Size & type	Depth interval
			2 per ft.	glass & alum. strip jets	<del>XXXX</del> 1014-1034

**TUBING RECORD**

Size	Setting depth	Packer set at
2 $\frac{1}{2}$ " <del>REG</del> <del>REG</del>	1055	

**ACID, FRACTURE, SHOT, CEMENT SQUEEZE RECORD**

Amount and kind of material used	Depth interval treated
60 sacks 100# water gel 185 Bdl. water	1014-1034

**INITIAL PRODUCTION**

Date of first production <u>10-30-80</u>	Producing method (flowing, pumping, gas lift, etc.) <u>pumping</u>
RATE OF PRODUCTION PER 24 HOURS	Oil <u>20</u> bbls. Gas <u>very little</u> MCF Water <u>10</u> bbls. Gas-oil ratio <u>          </u> CFPB
Disposition of gas (vented, used on lease or sold) <u>vented thru lead line</u>	Producing interval (s) <u>full time</u>

INSTRUCTIONS: As provided in KCC Rule 82-2-125, within 90 days after completion of a well, one completed copy of this Drillers Log shall be transmitted to the State Geological Survey of Kansas, 4150 Monroe Street, Wichita, Kansas 67209. Copies of this form are available from the Conservation Division, State Corporation Commission, 245 No. Water, Wichita, Kansas 67202. Phone AC 316-522-2206. If confidential custody is desired, please note Rule 82-2-125. Drillers Logs will be on open file in the Oil and Gas Division, State Geological Survey of Kansas, Lawrence, Kansas 66044.

Operator Tech-American Kansas		DESIGNATE TYPE OF COMP.: OIL, GAS, DRY HOLE, SWDW, ETC.:
Well No. 21	Lease Name Keith	Oil
S 14 T 28 R 15 E XX		

### WELL LOG

Show all important zones of porosity and contents thereof; cored intervals, and all drill-stem tests, including depth interval tested, cushion used, time tool open, flowing and shut-in pressures, and recoveries.

SHOW GEOLOGICAL MARKERS, LOGS RUN, OR OTHER DESCRIPTIVE INFORMATION.

FORMATION DESCRIPTION, CONTENTS, ETC.	TOP	BOTTOM	NAME	DEPTH
20 lime	0	20		
109 shale	20	129		
27 lime	129	156		
72 shale	156	228		
14 lime	228	242		
52 shale	242	294		
27 lime	294	321		
16 shale	321	337		
36 limey shale	337	373		
74 lime	373	447		
3 sandy shale	447	450		
66 lime	450	516		
14 shale	516	530		
28 lime	530	558		
46 shale	558	604		
5 lime	604	609		
31 shaley lime	609	640		
8 lime	640	648		
109 shale	648	756		
2 lime	756	758		
9 shale	758	767		
22 lime	767	789		
20 shale	789	809		
16 lime	809	825		
6 shale	825	831		
7 lime	831	838		
6 shale	838	844		
6 lime	844	850		
154 shale	850	1004		
2 coal	1004	1006		
oil sand T.D.	1006	1075 T.I.		

USE ADDITIONAL SHEETS, IF NECESSARY, TO COMPLETE WELL RECORD.

Date Received	Signature <i>Daniel M. Debuschle</i> Title <i>Field Sup.</i> Date <i>1-16-51</i>
---------------	---