

NO LOG p1

16-31-JE 1/10/85

KANSAS

WELL COMPLETION REPORT AND DRILLER'S LOG

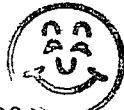

S. 16 T. 31S R. 21 E XX

Loc. SW SE SE

County Labette

API No. 15 — 099 — 21,309
County Number

Operator

Hickory Creek Oil Company

Address

P. O. Box 379, Parsons, KS

JAN 10 1985

Well No. #4

Lease Name V. McKinzie

CONSERVATION DIVISION
Wichita, Kansas

Footage Location

475 feet from (N) (S) line 1300 feet from (E) (W) line

Principal Contractor

V W & B Drilling

Geologist

M. R. Gray

Spud Date

10/7/80

Date Completed

10/9/80

Total Depth

301'

P.B.T.D.

Directional Deviation

Oil and/or Gas Purchaser

Eureka Crude Purchasing

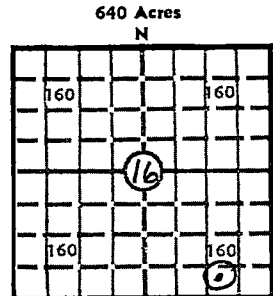

Locate well correctly

Elev.: Gr. _____

DF _____

KB _____

CASING RECORD

Report of all strings set — surface, intermediate, production, etc.

Purpose of string	Size hole drilled	Size casing set (in O.D.)	Weight lbs/ft.	Setting depth	Type cement	Sacks	Type and percent additives
surface	9"	7"	20 lbs.	41'	portland	seven	14 lbs. CaCl
production	6 1/4"	4 1/2"	9 lbs.	284'	portland A	35	prem gel (2 sks)

LINER RECORD

PERFORATION RECORD

Top, ft.	Bottom, ft.	Sacks cement	Shots per ft.	Size & type	Depth interval

Size	Setting depth	Packer set at

ACID, FRACTURE, SHOT, CEMENT SQUEEZE RECORD

Amount and kind of material used	Depth interval treated

JAN 28 1985

State Geological Survey
WICHITA BRANCH

INITIAL PRODUCTION

Date of first production		Producing method (flowing, pumping, gas lift, etc.)			
RATE OF PRODUCTION PER 24 HOURS	Oil bbls.	Gas MCF	Water bbls.	Gas-oil ratio	CFPB
Disposition of gas (vented, used on lease or sold)			Producing interval (s)		

INSTRUCTIONS: As provided in KCC Rule 82-2-125, within 90 days after completion of a well, one completed copy of this Drillers Log shall be transmitted to the State Geological Survey of Kansas, 4150 Monroe Street, Wichita, Kansas 67209. Copies of this form are available from the Conservation Division, State Corporation Commission, 245 No. Water, Wichita, Kansas 67202. Phone AC 316-522-2206. If confidential custody is desired, please note Rule 82-2-125. Drillers Logs will be on open file in the Oil and Gas Division, State Geological Survey of Kansas, Lawrence, Kansas 66044.

Operator Hickory Creek Oil Company DESIGNATE TYPE OF COMP.: OIL, GAS, DRY HOLE, SWDW, ETC.:

Well No. 4 Lease Name V. McKinzie

S 16 T 31 R 21 E
 XX

WELL LOG

Show all important zones of porosity and contents thereof; cored intervals, and all drill-stem tests, including depth interval tested, cushion used, time tool open, flowing and shut-in pressures, and recoveries.

SHOW GEOLOGICAL MARKERS, LOGS RUN, OR OTHER DESCRIPTIVE INFORMATION.

FORMATION DESCRIPTION, CONTENTS, ETC.	TOP	BOTTOM	NAME	DEPTH
Top soil	0	1		
Brown clay	1	27		
River gravel	27	30		
Gray shale	30	37		
Sandstone	37	41		
Sandy shale	41	102		
Gray shale	102	110		
Streak of coal	110			
Gray shale	110	119		
Lime	119	120		
Lt. shale	120	121		
Lime	121	124		
Dark shale	124	129		
Light shale	129	133		
Sandstone	133	137		
or CORE	134	191		
Gray shale	137	142		
Sandstone	142	143		
Gray shale	143	145		
Sandstone	145	151		
Gray shale	151	154		
Sandstone	154	160		
Gray shale	160	162		
Sandstone	162	171		
Light shale	171	178		
Dark shale	178	182		
Streak of coal	182			
Light shale	182	200		
Sandstone	200	208		
Gray shale	208	230		
Dark shale	230	238		
Light shale	238	252		
Gray shale	252	257		
Light shale	257	279		
Gray shale	279	297		
Light shale	297	301		

USE ADDITIONAL SHEETS, IF NECESSARY, TO COMPLETE WELL RECORD.

Date Received	Signature
	Title
	Date

10-31-91E

16-31-21E



STATE CORPORATION COMMISSION OF KANSAS
OIL & GAS CONSERVATION DIVISION
WELL COMPLETION OR RECOMPLETION FORM
ACO-1 WELL HISTORY
DESCRIPTION OF WELL AND LEASE

API NO. 15-099-21,309
County Labette
SW SE SE Sec 16 Twp 31S Rge 21 XX East West

Operator: License # 5115
Name REESE EXPLORATION, INC.
Address 5540 Raytown Rd.
City/State/Zip Raytown, MO 64133

4805 NA
3980
Ft North from Southeast Corner of Section
Ft West from Southeast Corner of Section
(Note: Locate well in section plat below)

Purchaser ~~Vanguard Pipeline~~ ENRON
~~Heard~~ Chanute, KS

Lease Name McKINZIE Well # 4

Field Name Strauss

Operator Contact Person Patty Eichman
Phone 816/356-1970

Producing Formation Skinner

Elevation: Ground Unk KB

Contractor: License # Unk
Name V.W. & B. Drilling

Section Plat

Wellsite Geologist M. R. Gray
Phone Unk

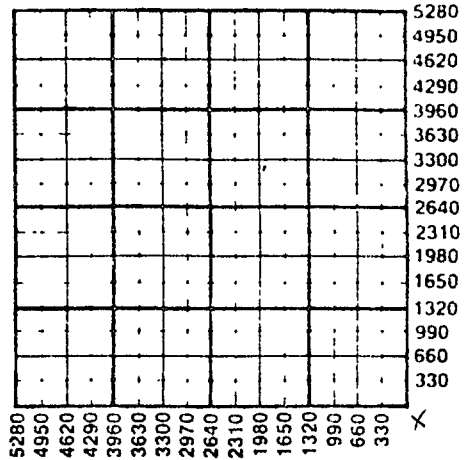

Designate Type of Completion
 New Well Re-Entry Workover

Oil SWD Temp Abd
 Gas Inj Delayed Comp.
 Dry Other (Core, Water Supply etc.)

If OWO: old well info as follows:
Operator
Well Name
Comp. Date Old Total Depth

WATER SUPPLY INFORMATION

Disposition of Produced Water: Disposal
Docket # Repressuring

WELL HISTORY

Drilling Method:
 Mud Rotary Air Rotary Cable
10-7-80 10-9-80 6-8-87
Spud Date Date Reached TD Completion Date
301 284
Total Depth PBT

Questions on this portion of the ACO-1 call:
Water Resources Board (913) 296-3717

Source of Water:
Division of Water Resources Permit #
Groundwater.....Ft North from Southeast Corner (Well)Ft West from Southeast Corner of Sec Twp Rge East West
Surface Water.....Ft North from Southeast Corner (Stream,pond etc).....Ft West from Southeast Corner Sec Twp Rge East West

Amount of Surface Pipe Set and Cemented at 41 feet
Multiple Stage Cementing Collar Used? Yes No
If yes, show depth set.....feet
If alternate 2 completion, cement circulated from.....feet depth to.....w/.....SX cmt
Cement Company Name Unk

Other (explain) Unknown
Gas Water Gas-Oil Ratio Gravity
no 1
MCF Bbls CFPB

No production	Oil
Estimated Production Per 24 Hours	1 Bbls

METHOD OF COMPLETION

Production Interval

Disposition of gas: Vented Open Hole Perforation
 Solid Other (Specify)

278 - 283

316-1E-21

Operator Name REESE EXPLORATION, INC. Lease Name McKINZIE Well # 4

Sec. 16 Twp. 31S Rge. 21E East West County Labette

WELL LOG

INSTRUCTIONS: Show important tops and base of formations penetrated. Detail all cores. Report all drill stem tests giving interval tested, time tool open and closed, flowing and shut-in pressures, whether shut-in pressure reached static level, hydrostatic pressures, bottom hole temperature, fluid recovery, and flow rates if gas to surface during test. Attach extra sheet if more space is needed. Attach copy of log.

Drill Stem Tests Taken Yes No
 Samples Sent to Geological Survey Yes No
 Cores Taken Yes No

Formation Description
 Log Sample

Name	Top	Bottom
Top soil & gravel		30
Shale	30	37
Sandstone	37	41
Shale & Lime	41	133
Sandstone	133	137
Shale	137	142
Sandstone	142	143
Shale & sandstone	143	182
Coal	182	183
Shale	183	200
Sandstone	200	208
Shale	208	301
TD		301

CASING RECORD New Used
 Report all strings set-conductor, surface, intermediate, production, etc.

Purpose of String	Size Hole Drilled	Size Casing Set (In O.D.)	Weight Lbs/Ft.	Setting Depth	Type of Cement	#Sacks Used	Type and Percent Additives
Surface	9"	7"	20#	41'	portland	7	14# CaCl
Production	6 1/2"	4 1/2"	9#	284'	portland	35	prem gel 2

Shots Per Foot	Specify Footage of Each Interval Perforated	Acid, Fracture, Shot, Cement Squeeze Record (Amount and Kind of Material Used)	Depth
2	278 - 283	Natural Comp	
		60 sx sand & gel water	300

TUBING RECORD Size 2" Set At 284 Packer at None Liner Run Yes No

Date of First Production Shut-in Producing Method Flowing Pumping Gas Lift Other (explain)

V W & B DRILLING CO.Box 7 N. Hwy. 169
CHERRYVALE, KS 67335

McKinzie Farm Well #4

Sec. 16 31 21
Loc. SE $\frac{1}{4}$ SE $\frac{1}{4}$
County: LabetteDrilled for Hickory Creek
Commenced Drilling 10-7-80
Completed Drilling 10-9-80Figures indicate the bottom
of the formation

1	Top Soil	1	3	Gray Shale	154
26	Brn Clay	27	6	Sandstone	160
3	River Gravel	30	2	Gray Shale	162
7	Gray Shale	37	9	Sandstone	171
4	Sandstone	41	7	Lt. Shale	178
61	Sandy Shale	102	4	Dk. Shale	182
8	Gray Shale	110		Streak of Coal	182
	Streak of Coal	110	18	Lt. Shale	200
9	Gray Shale	119	8	Sandstone	208
1	Lime	120	22	Gray Shale	230
1	Lt. Shale	121	8	Dk. Shale	238
3	Lime	124	14	Lt. Shale	252
5	Dk. Shale	129	5	Gray Shale	257
4	Lt. Shale	133	22	Lt. Shale	279
4	Sandstone	137	18	Gray Shale	297
	Start Core	134	4	Lt. Shale	301
	Stop Core	191			
5	Gray Shale	142			
1	Sandstone	143			
2	Gray Shale	145			
6	Sandstone	151			

41 feet of 7 inch casing set with 7 sacks of cement, 14 lbs. calcium chloroxide. 284 of 4 inch set with float shoe. Bottom centerlizer set at 198 feet. Top centerlizer set at 99 feet. Bottom cement basket set at 196 feet. Top cement basket set at 112 feet.