

KANSAS

WELL COMPLETION REPORT AND DRILLER'S LOG



(X)

16-31-21E
NO LOG
1/10/85
★

S. 16 T. 31S R. 21 E
WX

Loc. NE NE NE

County Labette

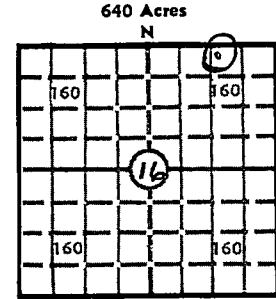

640 Acres N

Elev.: Gr. _____

DF _____ KB _____

API No. 15 — 099 — 21,312
County Number

Operator Hickory Creek Oil Company RECEIVED STATE CORPORATION COMMISSION

Address P. O. Box 379, Parsons, KS JAN 10 1985

Well No. #7 Lease Name R. Wamsley CONSERVATION DIVISION

Footage Location 150 feet from (N) (S) line 1245 feet from (E) (W) line Wichita, Kansas

Principal Contractor V W & B Drilling Geologist M. R. Gray

Spud Date 9/25/80 Date Completed 9/29/80 Total Depth 301' P.B.T.D.

Directional Deviation Oil and/or Gas Purchaser Eureka Crude Purchasing

CASING RECORD

Report of all strings set — surface, intermediate, production, etc.

Table with 8 columns: Purpose of string, Size hole drilled, Size casing set (in O.D.), Weight lbs/ft., Setting depth, Type cement, Sacks, Type and percent additives. Rows include surface and production data.

LINER RECORD

PERFORATION RECORD

Tables for Liner Record (Top, Bottom, Sacks cement) and Perforation Record (Shots per ft., Size & type, Depth interval). Tubing Record table below with columns: Size, Setting depth, Packer set at.

ACID, FRACTURE, SHOT, CEMENT SQUEEZE RECORD

Table with 2 columns: Amount and kind of material used, Depth interval treated. Includes handwritten date JAN 28 and State Geologist Survey WICHITA BRANCH.

INITIAL PRODUCTION

Table for Initial Production with columns: Date of first production, Producing method, Rate of production per 24 hours (Oil, Gas, Water), Gas-oil ratio, Disposition of gas, Producing interval(s).

INSTRUCTIONS: As provided in KCC Rule 82-2-125, within 90 days after completion of a well, one completed copy of this Drillers Log shall be transmitted to the State Geological Survey of Kansas, 4150 Monroe Street, Wichita, Kansas 67209. Copies of this form are available from the Conservation Division, State Corporation Commission, 245 No. Water, Wichita, Kansas 67202. Phone AC 316-522-2206. If confidential custody is desired, please note Rule 82-2-125. Drillers Logs will be on open file in the Oil and Gas Division, State Geological Survey of Kansas, Lawrence, Kansas 66044.

Operator Hickory Creek Oil Company		DESIGNATE TYPE OF COMP.: OIL, GAS, DRY HOLE, SWDW, ETC.:
Well No. 7	Lease Name R. Wamsley	
S 16 T 31 R 21 E Wk		

WELL LOG

Show all important zones of porosity and contents thereof; cored intervals, and all drill-stem tests, including depth interval tested, cushion used, time tool open, flowing and shut-in pressures, and recoveries.

SHOW GEOLOGICAL MARKERS, LOGS RUN, OR OTHER DESCRIPTIVE INFORMATION.

FORMATION DESCRIPTION, CONTENTS, ETC.	TOP	BOTTOM	NAME	DEPTH
Top soil	0	1		
Brown clay	1	5		
Yellow clay	5	13		
River gravel	13	15		
Lime	15	28		
Black shale	28	32		
Lime	32	36		
Sandstone	36	42		
Light shale	42	44		
Gray shale	44	48		
Sandstone	48	50		
Gray, sandy shale	50	130		
Dark shale	130	132		
Lime	132	133		
Coal	133	134		
Gray shale	134	149		
Light shale	149	150		
Dark shale	150	178		
CORE	161	201		
Sandstone	178	184		
Gray shale	184	185		
Sandstone	185	197		
Coal	197	198		
Lime	198	199		
Coal	199	200		
Gray shale	200	202		
Coal	202	203		
Light shale	203	213		
Sandstone	213	216		
CORE	216	236		
Gray shale	236	252		
Light shale	252	260		
Gray shale	260	269		
Light shale	269	286		
Gray shale	286	294		
Dark shale	294	301		

USE ADDITIONAL SHEETS, IF NECESSARY, TO COMPLETE WELL RECORD.

Date Received	Signature
	Title
	Date

1P-21-916

Operator Name **REESE EXPLORATION, INC.** Lease Name **WAMSLEY** Well # **7**

Sec. **16** Twp. **31S** Rge. **21E** East West County **Labette**

WELL LOG

INSTRUCTIONS: Show important tops and base of formations penetrated. Detail all cores. Report all drill stem tests giving interval tested, time tool open and closed, flowing and shut-in pressures, whether shut-in pressure reached static level, hydrostatic pressures, bottom hole temperature, fluid recovery, and flow rates if gas to surface during test. Attach extra sheet if more space is needed. Attach copy of log.

Drill Stem Tests Taken Yes No
 Samples Sent to Geological Survey Yes No
 Cores Taken Yes No

Formation Description
 Log Sample

Name	Top	Bottom
Soil & clay	1	13
River gravel	13	15
Lime & shale	15	36
Sandstone	36	42
Shale	42	48
Sandstone	48	50
Shale & lime	50	133
Coal	133	134
Shale	134	178
Sandstone	178	184
Gray shale	184	185
Sandstone	185	197
Lime & Shale	197	213
Sandstone	213	216
Shale	216	301
TD		301

CASING RECORD New Used

Report all strings set-conductor, surface, intermediate, production, etc.

Purpose of String	Size Hole Drilled	Size Casing Set (in O.D.)	Weight Lbs/Ft.	Setting Depth	Type of Cement	#Sacks Used	Type and Percent Additives
Surface	9"	7"	20 lbs.	20'	portland	5	10% CaCl ₂
Production	6 1/4"	4 1/2"	9 lbs.	283'	portland	39	prem gel 1 sx

PERFORATION RECORD

Acid, Fracture, Shot, Cement Squeeze Record

Shots Per Foot	Specify Footage of Each Interval Perforated	(Amount and Kind of Material Used)	Depth
2	275-280	Natural Comp	250
		60 sx sand & Gel water	

TUBING RECORD Size **2"** Set At **surf to 284** Packer at **None** Liner Run Yes No

Date of First Production **7-4-87** Producing Method Flowing Pumping Gas Lift Other (explain)

VW & B DRILLING CO.
 Box 7 N. Hwy. 169
 CHERRYVALE, KS 67335

Wamsley Farm Well # 7

Sec. 16 T31S R21E
 NE $\frac{1}{4}$
 County: Labette

Drilled for Hickory Creek
 Commenced Drilling 9-25-80
 Completed Drilling 9-9-29-80

Figures indicate the bottom
 of the formation

1	Top Soil	1	28	Dk. Shale	178
4	Brn Clay	5		Start Core 161'	
8	Yellow Clay	13		Stop Core 201'	
2	River Gravel	15	6	Sandstone	184
13	Lime	28	1	Gray Shale	185
4	Blk. Shale	32	12	Sandstone	197
4	Lime	36	1	Coal	198
6	Sandstone	42	1	Lime	199
2	Lt. Shale	44	1	Coal	200
4	Gray Shale	48	2	Gray Shale	202
2	Sandstone	50	1	Coal	203
80	Gray Sandy Shale	130	10	Lt. Shale	213
2	Dk. Shale	132	3	Sandstone	216
1	Lime	133		Start core 216'	
1	Coal	134		Stop Core 236'	
15	Gray Shale	149	36	Gray Shale	252
1	Lt. Shale	150	8	Lt. Shale	260
			9	Gray Shale	269
			17	Lt. Shale	286
			8	Gray Shale	294
			7	Dk. Shale	301

Hole size 6 $\frac{1}{2}$ "
 20 feet of 7" casing set with 5 sacks
 of cement 10 lbs. calcium chloroxide.
 283'3" of 4 inch casing set with float
 shoe. Bottom centerlizer set at 231'
 Top centerlizer set at 132'.