

KANSAS

WELL COMPLETION REPORT AND DRILLER'S LOG

16-31-21E 5/31/85



API No. 15 — 099 — 21,359
County Number

S. 16 T. 31SR. 21 E W
Loc. SW NE NE
County Labette

Operator Hickory Creek Oil Company

Address P.O. Box 379, Parsons, Kansas 67357

Well No. # 16 Lease Name R. Wamsley

Footage Location 1100 feet from (N) (SX) line 1325 feet from (E) (WX) line

Principal Contractor V W & B Drilling Geologist M. R. Gray

Spud Date 11/22/80 Date Completed 1/24/80 Total Depth 281' P.B.T.D.

Directional Deviation Oil and/or Gas Purchaser Square Deal

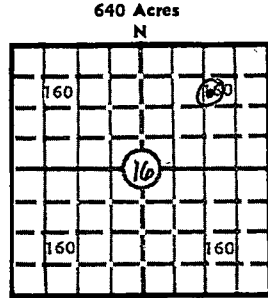

Locate well correctly Elev.: Gr. est. +840 topog.

DF KB

JUN 1 0 1985

CASING RECORD

Report of all strings set — surface, intermediate, production, etc.

Table with 8 columns: Purpose of string, Size, Grilled, Casing set (in O.D.), Weight lbs/ft., Setting depth, Type cement, Sacks, Type and percent additives. Rows include Surface and Production data.

LINER RECORD

PERFORATION RECORD

Tables for Liner Record and Perforation Record. Liner Record columns: Top, ft., Bottom, ft., Sacks cement. Perforation Record columns: Shots per ft., Size & type, Depth interval.

ACID, FRACTURE, SHOT, CEMENT SQUEEZE RECORD

Table with 2 columns: Amount and kind of material used, Depth interval treated. Entry: 1500# 16-30 sand + 26,500 SCF nitrogen + clay control inhibitor, 172-193'.

INITIAL PRODUCTIONS

Table with 4 columns: Date of first production, Producing method, Rate of production per 24 hours (Oil, Gas, Water), Gas-oil ratio. Includes Skinner Sand producing interval.

INSTRUCTIONS: As provided in KCC Rule 82-2-125, within 90 days after completion of a well, one completed copy of this Drillers Log shall be trans-

Operator Hickory Creek Oil Company		DESIGNATE TYPE OF COMP.: OIL, GAS, DRY HOLE, SWDW, ETC.:
Well No. 16	Lease Name R. Wamsley	OIL
S 16 T 31 R 21 E W		

**WELL LOG**

Show all important zones of porosity and contents thereof; cored intervals, and all drill-stem tests, including depth interval tested, cushion used, time tool open, flowing and shut-in pressures, and recoveries.

SHOW GEOLOGICAL MARKERS, LOGS RUN, OR OTHER DESCRIPTIVE INFORMATION.

FORMATION DESCRIPTION, CONTENTS, ETC.	TOP	BOTTOM	NAME	DEPTH
Top Soil		1		
Yellow Clay	1	10		
River Gravel	10	11		
Lime	11	21		
Blk Shale	21	25		
Lime	25	29		
Limestone	29	37		
Silty Shale	37	103		
Gray Shale	103	121		
Dark Gray Shale	121	127		
Streak of Coal	127	127		
Gray Shale	127	136		
Lime Brn.	136	137		
Gray Shale	137	140		
Lime	140	142		
Lime	142	143		
Blk Shale	143	147		
Gray Shale	147	149		
Streak of Coal	149	149		
Gray Shale	149	152		
Sandy Shale Gray	152	170		
Sandstone	170	194		
Coal	194	195		
Gray Shale	195	200		
Sandy Shale	200	220		
Silty Shale	220	238		
Blk Shale	238	241		
Gray Shale	241	281		
Bottom of hole		281		

(Radioactivity log is attached)

USE ADDITIONAL SHEETS, IF NECESSARY, TO COMPLETE WELL RECORD.

Date Received	 Signature
	Title
	5/31/85 Date

12-31-91E

16-31-2/E  
 State Geological Survey  
 WICHITA BRANCH

TYPE

AFFIDAVIT OF COMPLETION FORM

ACO-1 WELL HISTORY

Compt.

SIDE ONE

(Rules 82-3-130 and 82-3-107)

DOCKET NO. NP

This form shall be filed with the Kansas Corporation Commission, 200 Colorado Derby Building, Wichita, Kansas 67202, within ninety (90) days after the completion of a well, regardless of how the well was completed.

FOR INFORMATION REGARDING THE NUMBER OF COPIES TO BE FILED AND APPLICATIONS REQUIRING COPIES OF ACO-1 FORMS SEE PAGE TWO (2), SIDE TWO (2) OF THIS FORM.

F Letter requesting confidentiality attached.

C Attach ONE COPY of EACH wireline log run (i.e. electrical log, sonic log, gamma ray neutron log etc.)\*\*\*Check here if NO logs were run X. Will run gamma ray- Neutron and cement bond log.

PLEASE FILL IN ALL INFORMATION. IF NOT AVAILABLE, INDICATE. IF INFORMATION LATER BECOMES AVAILABLE, SUBMIT BY LETTER.

LICENSE # 5279 EXPIRATION DATE 6/30/84

OPERATOR INCO Energy, Inc. API NO. 15 099-21,359

ADDRESS P. O. Box 379 COUNTY Labette

Parsons, Ks. 67357 FIELD McCune West

\*\* CONTACT PERSON E. H. Hare, Jr. PROD. FORMATION Skinner Sand  
 PHONE 316-421-0910 Indicate if new pay.

PURCHASER Eureka Crude Purchasing LEASE L. Wamsley

ADDRESS P. O. Box 190 WELL NO. 16

Eureka, Ks. 67045 WELL LOCATION

DRILLING V W & B Drilling Co. 1120 Ft. from N Line and

CONTRACTOR Box 7, North Hwy 169 1280 Ft. from E Line of (E)

ADDRESS Cherryvale, Kansas 67335 the NE (Qtr.) SEC 16 TWP 31 RGE 21

PLUGGING CONTRACTOR ADDRESS

WELL PLAT

(Office Use Only)

			⊙
		16	

KCC  
 KGS

SWD/REP  
 PLG.

NGPA

TOTAL DEPTH 281 PBTD

SPUD DATE 11/22/80 DATE COMPLETED 11/23/80

ELEV: GR DF KB

DRILLED WITH (CABLE) (ROTARY) (AIR) TOOLS.

DOCKET NO. OF DISPOSAL OR REPRESSURING WELL BEING USED TO DISPOSE OF WATER FROM THIS LEASE

Amount of surface pipe set and cemented 20 DV Tool Used?

TYPE OF COMPLETION THIS AFFIDAVIT APPLIES TO: (Circle ONE) - Oil, Shut-in Gas, Gas, Dry, Disposal, Injection Temporarily Abandoned. If OWWO, indicate type of re-completion. Other completion. NGPA filing

NOTE: This well was previously classified as temporarily abandoned. ALL REQUIREMENTS OF THE STATUTES, RULES AND REGULATIONS PROMULGATED TO REGULATE THE OIL AND GAS INDUSTRY HAVE BEEN FULLY COMPLIED WITH.

A F F I D A V I T

E. H. Hare, Jr., being of lawful age, hereby certifies that:

I am the Affiant, and I am familiar with the contents of the foregoing Affidavit. The statements and allegations contained therein are true and correct.

12-31-91

ACO-1 Well History

Side TWO

OPERATOR INCO Energy, Inc. LEASE NAME L. Wamsley SEC 16 TWP 31 RGE 21 (E) ~~XX~~  
 WELL NO 16

FILL IN WELL INFORMATION AS REQUIRED:

Show all important zones of porosity and contents thereof; cored intervals, and all drill-stem tests, including depth interval tested, cushion used, time tool open, flowing and shut-in pressures, and recoveries.

Show Geological markers, logs run, or other Descriptive information.

Formation description, contents, etc.	Top	Bottom	Name	Depth
<input checked="" type="checkbox"/> Check if no Drill Stem Tests Run. <input type="checkbox"/> Check if samples sent Geological Survey.  See Attached Sheet				

If additional space is needed use Page 2

Report of all strings set — surface, intermediate, production, etc. CASING RECORD (New) or (Used)

Purpose of string	Size hole drilled	Size casing set (in O.D.)	Weight lbs/ft.	Setting depth	Type cement	Sacks	Type and percent additives
Surface	9	7"		20	Portland	5	
Production	6 1/2	4 1/2"		264	Portland	30	1 sk. prem gel

LINER RECORD			PERFORATION RECORD		
Top, ft.	Bottom, ft.	Sacks cement	Shots per ft.	Size & type	Depth interval

TUBING RECORD		
Size	Setting depth	Packer set at

16-31-21E P7

State Geological Survey  
WICHITA BRANCH

ACO-1 WELL HISTORY

PAGE 2 (Side One)

OPERATOR INCO Energy, Inc. LEASE NAME L. Wamsley  
WELL NO. #16

SEC 16 TWP 31 RGE 21

FILL IN WELL INFORMATION AS REQUIRED.

Show all important zones of porosity and contents thereof; cored intervals, and all drill-stem tests, including depth interval tested, cushion used, time tool open, flowing & Shut-in pressures, and recoveries.

Show Geological markers, logs run, or Other Descriptive information.

FORMATION DESCRIPTION, CONTENTS, ETC.	TOP	BOTTOM	NAME	DEPTH
Top Soil		1		
Yellow Clay		10		
River Gravel		11		
Lime		21		
Blk. Shale		25		
Lime		29		
Limestone		37		
Silty Shale		103		
Gray Shale		121		
Dk. Gray Shale		127		
Streak of coal		127		
Gray Shale		136		
Lime Brn.		137		
Gray Shale		139		
Lime		140		
Gray Shale		142		
Lime		143		
Blk. Shale		147		
Gray Shale		149		
Streak of Coal		149		
Gray Shale		152		
Sandy Shale Gray		170		
Sandstone		194		
Coal		195		
Gray Shale		200		
Sandy Shale		220		
Silty Shale		238		
Blk. Shale		241		
Gray Shale		281		
Bottom of hole		281		

**V W & B DRILLING CO.**

Box 7 N. Hwy. 169  
CHERRYVALE, KS 67335

Wamsley Farm Well # 16

Ne Ne  
Loc. 16 T31S R 21E  
County Labette

Drilled for Hickory Creek Oil  
Commenced Drilling 11-22-80  
Completed Drilling 11-23-80

Figures indicate the bottom  
of the formation

1	Top Soil	1	1	Lime	143
9	Yellow Clay	10	4	Blk. Shale	147
1	River Gravel	11	2	Gray Shale	149
10	Lime	21		Streak of Coal 1	149
4	Blk. Shale	25	3	Gray Shale	152
4	Lime	29	18	Sandy Shale Gray	170
8	Limestone	37	24	Sandstone	194
66	Silty Shale	103	1	Coal	195
18	Gray Shale	121	5	Gray Shale	200
6	Dk. Gray Shale	127	20	Sandy Shale	220
	Streak of coal	127	18	Silty Shale	238
9	Gray Shale	136	3	Blk. Shale	241
1	Lime Brn.	137	40	Gray Shale	281
2	Gray Shale	139		Bottom of hole	281
1	Lime	140			
2	Gray Shale	142			

Hole size  $6\frac{1}{4}$  inch . 20 feet of 7 inch casing set with 5 sacks of cement, 10 lbs. calcium chloroxide. 30 feet of 7 inch casing brought to hole. 264 feet of 4 inch set with float shoe. Top cement basket set at 155 feet bottom cement basket set at 210 feet. Bottom centerlizer set at 231 feet, top centerlizer set at 132 feet.  $1\frac{1}{3}$  sacks of KCI used in drilling fluid. Start Core 161 feet. Stop core at 196 feet.