

KANSAS

NO LOG 21-4-NE 1/10/85

WELL COMPLETION REPORT AND DRILLER'S LOG

API No. 15 — 099 — 21,239  
County Number

S. 21 T. 31 R. 21 E W

Loc. NE NE

County Labette

Operator Hickory Creek Oil Co. RECEIVED

Address P. O. Box 379 Parsons, Kansas 67357 STATE CORPORATION COMMISSION

Well No. #3 Lease Name Barnes JAN 18 1985

Footage Location 175 feet from (N) line 675 feet from line CONSERVATION DIVISION

Principal Contractor Lamampco Drilling Geologist D. A. Zemo

Spud Date 6/5/80 Date Completed 6-6-80 Total Depth 275 P.B.T.D.

Directional Deviation Oil and/or Gas Purchaser

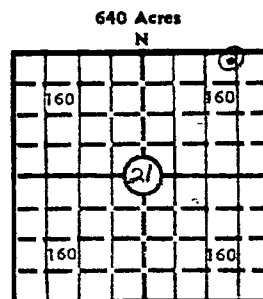

Elev.: Gr. \_\_\_\_\_

DF \_\_\_\_\_ KB \_\_\_\_\_

CASING RECORD

Report of all strings set — surface, intermediate, production, etc.

Purpose of string	Size hole drilled	Size casing set (in O.D.)	Weight lbs/ft.	Setting depth	Type cement	Sacks	Type and percent additives
Surface	9"	7"	20 lbs	41	Portland	8	60 lb CaCl
Productio	6½"	4½"	9 lbs	199	Portland A	30	prem gel (2 sks)

LINER RECORD

PERFORATION RECORD

Top, ft.	Bottom, ft.	Sacks cement	Shots per ft.	Size & type	Depth interval

TUBING RECORD

Size	Setting depth	Packer set at

ACID, FRACTURE, SHOT, CEMENT SQUEEZE RECORD

Amount and kind of material used	Depth interval treated
JAN 25 1985	

INITIAL PRODUCTION

Date of first production		Producing method (flowing, pumping, gas lift, etc.)			
RATE OF PRODUCTION PER 24 HOURS	OIL	Gas	Water	Gas-oil ratio	
	bbfs.	MCF	bbfs.	CFPB	
Disposition of gas (vented, used on lease or sold)			Producing interval(s)		

State Geological Survey WICHITA BRANCH

INSTRUCTIONS: As provided in KCC Rule 82-2-125, within 90 days after completion of a well, one completed copy of this Drillers Log shall be transmitted to the State Geological Survey of Kansas, 4150 Monroe Street, Wichita, Kansas 67209. Copies of this form are available from the Conservation Division, State Corporation Commission, 245 No. Water, Wichita, Kansas 67202. Phone AC 316-522-2206. If confidential custody is desired, please note Rule 82-2-125. Drillers Logs will be an open file in the Oil and Gas Division, State Geological Survey of Kansas, Lawrence, Kansas 66044.

Operator Hickory Creek Oil Company		DESIGNATE TYPE OF COMP.: OIL, GAS, DRY HOLE, SWDW, ETC.:
Well No. 3	Lease Name R. Barnes	Dry Hole
S 21 T 31 R 21 E WX		Plugged 12-9-81

### WELL LOG

Show all important zones of porosity and contents thereof; cored intervals, and all drill-stem tests, including depth interval tested, cushion used, time tool open, flowing and shut-in pressures, and recoveries.

SHOW GEOLOGICAL MARKERS, LOGS RUN,  
OR OTHER DESCRIPTIVE INFORMATION.

FORMATION DESCRIPTION, CONTENTS, ETC.	TOP	BOTTOM	NAME	DEPTH
Soil	0	2		
Clay	2	21		
Sand Gravel	21	38		
Sand Shaley	38	41		
Shale	41	94		
Pit Show no odor	94	95		
Shale	95	105		
Lime	105	106		
Lime	106	110		
Coal	110	112		
Shale	112	121		
Lime	121	123		
Lime Shaley	123	131		
Coal	131	132		
Shale	132	149		
Oil Sand Cored	149	169		
Oil sand Cored	169	180		
Sand	180	185		
Shale	185	192		
Coal	192	193		
Shale	193	241		
Coal	241	243		
Shale	243	261		
Limey Shale	261	268		
Shaley Sand	268	280		
TD		280		

USE ADDITIONAL SHEETS, IF NECESSARY, TO COMPLETE WELL RECORD.

Date Received	_____ Signature
	_____ Title
	_____ Date

31-2-715