

14-28-15E

STATE CORPORATION COMMISSION OF KANSAS  
OIL & GAS CONSERVATION DIVISION  
WELL COMPLETION OR RECOMPLETION FORM  
ACO-1 WELL HISTORY  
DESCRIPTION OF WELL AND LEASE

Operator: License # 8135  
Name Miller Oil Co  
Address PO Box 145  
City/State/Zip Benedict Ks 66714

Purchaser Fairway Claude  
Ucanote Ks

Operator Contact Person Doug Miller  
Phone 1-316-431-6516

Contractor: License # NA  
Name NA

Wellsite Geologist NA  
Phone NA

Designate Type of Completion  
 New Well  Re-Entry  Workover  
 Oil  SWD  Temp Abd  
 Gas  Inj  Delayed Comp.  
 Dry  Other (Core, Water Supply etc.)

If ONWO: old well info as follows:  
Operator NA  
Well Name NA  
Comp. Date Old Total Depth

WELL HISTORY

Drilling Method:  
 Mud Rotary  Air Rotary  Cable  
1-14-81 1-16-81 Oct. 30, 1985  
Spud Date Date Reached TD Completion Date

1322 NA  
Total Depth PBTD

Amount of Surface Pipe Set and Cemented at 2' foot  
Multiple Stage Cementing Collar Used?  Yes  No  
If yes, show depth set NA feet  
If alternate 2 completion, cement circulated from 0 foot depth to 1200 ft. SX cont.  
Cement Company Name 2222 S. 5th St. Okla. City, Mo.  
Invoice # 55735

API No. 15- 20521583A  
County Wilson  
SW SE SE Sec. 14 Twp. 28 Rge. 15 West



730 Ft North from Southeast Corner of Section  
990 Ft West from Southeast Corner of Section  
(Note: Locate well in section plat below)

Lease Name Weather Well # 19

Field Name unnamed field

Producing Formation Pocahontas

Elevation: Ground 800 NA

Section Plat

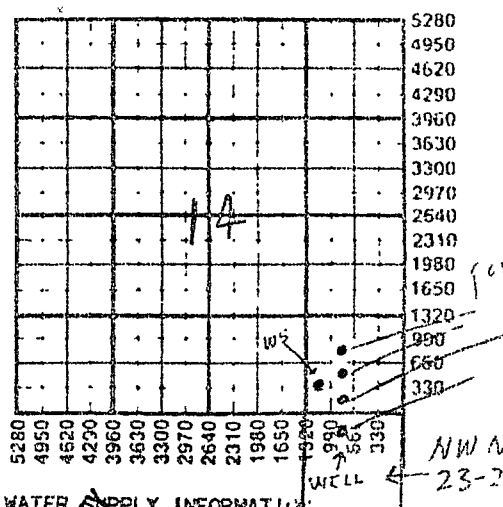

Disposition of Produced Water:  
Docket E 20521583A  Repressuring

Questions: This portion of the ACO-1 call:  
Water Resources Board (913) 296-3717

Source of Water:  
Division of Water Resources Permit # NA

NA Groundwater.....Ft North from Southeast Corner  
(Well) .....Ft West from Southeast Corner of  
Sec Twp Rge East West

NA Surface Water.....Ft North from Southeast Corner  
(Stream, pond etc).....Ft West from Southeast Corner  
Sec Twp Rge East West

Other (explain) R.W.D. # 5 AITONA, Ks.  
(purchased from city, R.W.D. #)

INSTRUCTIONS: This form shall be completed in duplicate and filed with the Kansas Corporation Commission, 200 Colorado Derby Building, Wichita, Kansas 67202, within 90 days after completion or recompletion of any well. Rule 82-3-130 and 82-3-107 apply.  
Information on side two of this form will be held confidential for a period of 12 months if requested in writing and submitted with the form. See rule 82-3-107 for confidentiality in excess of 12 months.  
One copy of all wireline logs and drillers time log shall be attached with this form. Submit CP-4 form with all plugged wells. Submit CP-111 form with all temporarily abandoned wells.

Operator Name Mulken Oil Co. Lease Name Spenthe Well # 19

Sec. 14 Twp. 21 Rge. 15  East  West County Wilson

BEST COPY AVAILABLE

WELL LOG

INSTRUCTIONS: Show important tops and base of formations penetrated. Detail all cores. Report all drill stem tests giving interval tested, time tool open and closed, flowing and shut-in pressures, whether shut-in pressure reached static level, hydrostatic pressures, bottom hole temperature, fluid recovery, and flow rates if gas to surface during test. Attach extra sheet if more space is needed. Attach copy of log.

Drill Stem Tests Taken  Yes  No  
 Samples Sent to Geological Survey  Yes  No  
 Cores Taken  Yes  No

Formation Description  
 Log  Sample

Name Top Bottom  
 Drilled into Mississippi Lime,  
 For water to be used for water flow

JUN 11 1996  
 KANSAS GEOLOGICAL SURVEY  
 WICHITA BRANCH

CASING RECORD <input type="checkbox"/> New <input checked="" type="checkbox"/> Used							
Report all strings set-conductor, surface, intermediate, production, etc.							
Purpose of String	Size Hole Drilled	Size Casing Set (in O.D.)	Weight Lbs/Ft.	Setting Depth	Type of Cement	#Sacks Used	Type and Percent Additives
Surface casing	12"	8"	NA	25'	Portland	NA	NA
Production string	4 1/2"	2 3/8"	NA	1200'	Portland	0-1200'	NA
PERFORATION RECORD				Acid, Fracture, Shot, Cor	Squeeze Record		
Shots Per Foot	Specify Footage of Each Interval Perforated			(Amount and Kind of Mate	Used)	Depth	
NONE	NA			NA		NA	
OPEN HOLE							
TUBING RECORD							
Size	Set At	Packer at	Liner Run		<input type="checkbox"/> Yes <input checked="" type="checkbox"/> No		
2 7/8"	1200'	1200'					
Date of First Production		Producing Method		WATER FLOOD WELL			
NA		<input type="checkbox"/> Flowing <input type="checkbox"/> Pumping <input type="checkbox"/> Gas Lift <input type="checkbox"/> Other (explain).....					