

5-9-206



STATE CORPORATION COMMISSION OF KANSAS
OIL & GAS CONSERVATION DIVISION

WELL COMPLETION OR RECOMPLETION FORM
ACO-1 WELL HISTORY

DESCRIPTION OF WELL AND LEASE

Operator: license # 5115
name Reese Exploration, Inc.
address PO Box 11598
City/State/Zip K. C. Mo. 64138

Operator Contact Person Patty Eichman
Phone 8163-56-1970

Contractor: license # 5685
name Michael Drilling

Wellsite Geologist Deacon Geology
Phone 913-272-4383

Type of Completion
 New Well Re-Entry Workover

Oil SWD Temp Abd
 Gas Inj Delayed Comp.
 Dry Other (Core, Water Supply etc.)

OWWO: old well info as follows:
Operator
Well Name
Comp. Date Old Total Depth

WELL HISTORY

Drilling Method: Mud Rotary Air Rotary Cable

10-23-84 10-26-84 10-26-84
Date Date Reached TD Completion Date

1527 1525
Total Depth PBTD

Depth of Surface Pipe Set and Cemented at 40 feet

Multiple Stage Cementing Collar Used? Yes No

If Yes, Show Depth Set feet

Alternate 2 completion, cement circulated
from surf feet depth to 1525 w/ 234 SX cmt

API NO. 15 - 087-20,117

County Jefferson

NE NE SW Sec 5 Twp 9 Rge 20
(location)

2310 Ft North from Southeast Corner of Section
2970 Ft West from Southeast Corner of Section
(Note: locate well in section plat below)

Lease Name Sedlak Well# 1-84

Field Name McLouth NW

Producing Formation Cherokee

Elevation: Ground 1035 KB

Section Plat

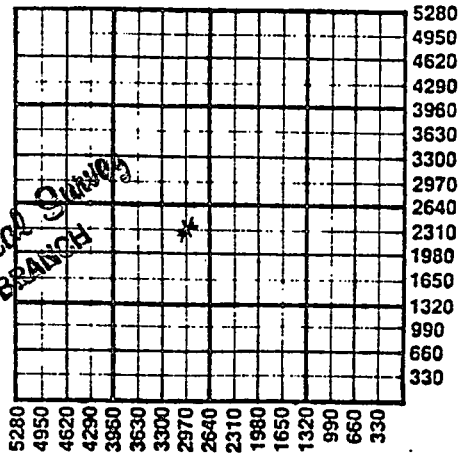

WATER SUPPLY INFORMATION

Source of Water:

Division of Water Resources Permit #

Groundwater Ft North From Southeast Corner of (Well) Ft West From Southeast Corner of Section Twp Rge East West

Surface Water Ft North From Southeast Corner of (Stream, Pond etc.) Ft West From Southeast Corner of Section Twp Rge East West

Other (explain) (purchased from city, R.W.D.#)

Disposition of Produced Water: Disposal Repressuring

Docket #

INSTRUCTIONS: This form shall be completed in duplicate and filed with the Kansas Corporation Commission, 200 Colorado Derby Building, Wichita, Kansas 67202, within 90 days after completion or recompletion of any well. Rules 82-3-130 and 82-3-107 apply.

Information on side two of this form will be held confidential for a period of 12 months if requested in writing and submitted with the form. See rule 82-3-107 or confidentiality in excess of 12 months.

One copy of all wireline logs and drillers time log shall be attached with this form. Submit CP-4 form with all plugged wells. Submit CP-111 form with all temporarily abandoned wells.

SIDE TWO

Operator Name Reese Exploration Lease Name Sedlak Well # 1-84 SEC. 5 TWP. 9 RGE. 20

WELL LOG

INSTRUCTIONS: Show important tops and base of formations penetrated. Detail all cores. Report all drill stem tests giving interval tested, time tool open and closed, flowing and shut-in pressures, whether shut-in pressure reached stat level, hydrostatic pressures, bottom hole temperature, fluid recovery, and flow rates if gas to surface during test. Attach extra sheet if more space is needed. Attach copy of log.

Drill Stem Tests Taken Yes No
 Samples Sent to Geological Survey Yes No
 Cores Taken Yes No

Formation Description
 Log Sample

Name	Top	Bottom
Base KC Gp	754	
Marmaton	844	
Cherokee	986	
U McLouth Sd	1442	
L McLouth Sd	1474	
Mississippian Lm	1483	
TD	1527	

TUBING RECORD size set at packer at Liner Run Yes No

Date of First Production Jan. 2, 1986 Producing method flowing pumping gas lift Other (explain)

Estimated Production Per 24 Hours	Oil Bbls	Gas MCF	Water Bbls	Gas-Oil Ratio CFPB	Gravity
		250			

Disposition of gas: vented sold used on lease
METHOD OF COMPLETION open hole perforation other (specify)
 Dually Completed. Commingled
PRODUCTION INTERVAL 1442 - 1450

CASING RECORD new used

Report all strings set - conductor, surface, intermediate, production, etc.

Purpose of string	size hole drilled	size casing set (In O.D.)	weight lbs/ft.	setting depth	type of cement	# sacks used	type and percent additives
surface casing	9-3/4	7"		40	portland	10	none
	6-1/2	4 1/2"		1525	"	234	2% Gel

PERFORATION RECORD

shots per foot specify footage of each interval perforated

2 1442 - 1450

Acid, Fracture, Shot, Cement Squeeze Record

(amount and kind of material used)

200 gal acid

Depth

prod