

UNION NATIONAL BANK BLDG, WICHITA, KANSAS

Location C NL SW ST NT NE Sec. 23 T. 26 R. 14E

Casing Record
 20" 10" 668 Farm- C. Lauber No. 5 County Woodson
 15 1/8" 8 1/2" 1008 Company- Peerless Oil & Rfg. Co.
 12 1/8" 65/8" 1193 Contr.- Ellenberger Drlg. Co.
 53/16" 53/16" Comm.- 6/5/26. Comp.- 6/18/26.

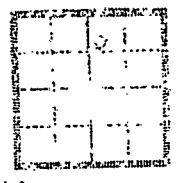

Total Depth 1303'
 Correspondence Regarding This Well Should Be Referred to

Elevation 7
 Initial Production 300 bbls

Figures Indicate Bottom of Formations.
 Date Issued: 2/11/28.

Formation	Depth
soil	11
shale	170
lime	260
shale	270
lime	350
shale	370
lime W. 2 B.	430
shale	510
lime	675
shale	785
lime	795
shale	901
sand 6 BW 905'	923
lime	945
shale	1000
lime	1015
sandy shale	1181
black slate	1193
white slate	1210
sand 1st oil 1215'	1222 1/2
sand Fair	1234
sand Good	1244
sand "	1255
sand "	1262
sand	1266
slate	1303
Total Depth	1303'