

KANSAS
WELL COMPLETION REPORT AND State Geological Survey
DRILLER'S LOG WICHITA BRANCH

S. 13 T. 16 R. 17W E
 W
 Loc. NE SE NW
 County Rush

API No. 15 — 165 — 20,852
 County Number

Operator Aspen Oil, Inc.

Address 7701 E. Kellogg, Suite 575 Wichita, Kansas 67207

Well No. #1 Lease Name Urban *Added Completion Info.*

Footage Location
 feet from (N) (S) line feet from (E) (W) line

Principal Contractor Aspen Oil, Inc. Exploration Geologist Lee Cornell

Spud Date 3-18-81 Date Completed 3-28-81 Total Depth 3580' P.B.T.D.

Directional Deviation Oil and/or Gas Purchaser

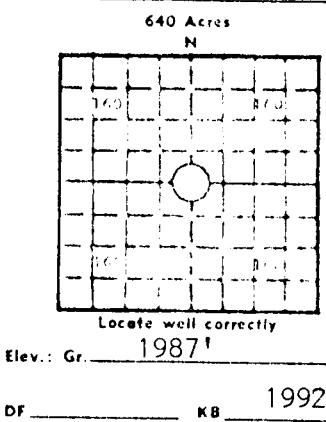

CASING RECORD

Report of all strings set — surface, intermediate, production, etc.

Purpose of string	Size hole drilled	Size casing set (in O.D.)	Weight lbs/ft.	Setting depth	Type cement	Sacks	Type and percent additives
Surface	12 1/4"	8 5/8"		450'	common		
Production	7 7/8"	4 1/2"		3580'	60/40 Poz	175	10% salt 0.75% CFR-2
(Cemented to protect casing below surface)--					60/40 Poz	250	2% c.c.

LINER RECORD

PERFORATION RECORD

Top, ft.	Bottom, ft.	Sacks cement	Shots per ft.	Size & type	Depth interval
			2		3474' - 3478'

Size	Setting depth	Packer set at

ACID, FRACTURE, SHOT, CEMENT SQUEEZE RECORD

Amount and kind of material used	Depth interval treated
Acidize 500 gallons 15% mud acid	3474' - 3478'
Re-acidize (later date) 3000 gallons 15% NE	3474' - 3478'

INITIAL PRODUCTION

Date of first production Producing method (flowing, pumping, gas lift, etc.)
 Pumping

RATE OF PRODUCTION PER 24 HOURS	Oil	Gas	Water	Gas-oil ratio
	bbls.	MCF	bbls.	CFPB

Disposition of gas (vented, used on lease or sold) Producing interval(s)

INSTRUCTIONS: As provided in KCC Rule 82-2-125, within 90 days after completion of a well, one completed copy of this Drillers Log shall be transmitted to the State Geological Survey of Kansas, 4150 Monroe Street, Wichita, Kansas 67202. Copies of this form are available from the Conservation Division, State Corporation Commission, 215 No. Water, Wichita, Kansas 67202. Phone AC 316 522-2206. If confidential custody is desired, please note Rule 82-2-125. Drillers Logs will be on an open file in the Oil and Gas Division, State Geological Survey of Kansas, Lawrence, Kansas 66044.

Operator Aspen Oil, Inc.		DESIGNATE TYPE OF COMP.: OIL, GAS, DRY HOLE, SWDW, ETC.:
Well No. #1	Lease Name Urban	Oil Well
13 T 16 R 17W E W		

WELL LOG

Show all important zones of porosity and contents thereof; cored intervals, and all drill-stem tests, including depth interval tested, cushion used, time tool open, flowing and shut-in pressures, and recoveries.

SHOW GEOLOGICAL MARKERS, LOGS RUN, OR OTHER DESCRIPTIVE INFORMATION.

FORMATION DESCRIPTION, CONTENTS, ETC.	TOP	BOTTOM	NAME	DEPTH
Topsoil	450'	887'	<u>LOG TOPS</u>	
Shale	887'	1290'		
Sand & Shale	1290'	1300'	Anhydrite	1129'
Shale	1300'	1840'	Topeka	3002'
Shale & Lime	1840'	2047'	Queen Hill	3140'
Shale	2047'	2307'	Heebner	3233'
Shale & Lime	2307'	2441'	Toronto	3250'
Lime & Shale	2441'	2557'	Douglas	3267'
Shale & Lime	2557'	2685'	Lansing	3286'
Lime & Shale	2685'	2869'	Base/KC	3511'
Lime	2869'	2961'	Penn. Sand	3528'
Lime & Shale	2961'	3403'	Base/Penn. Sand	3536'
Lime	3403'	3459'	Arbuckle	3561'
Shale	3459'	3489'	LTD	3581'
Lime & Shale	3489'	3580'		
Shale & Lime	3580'	TD		
DST #1				
Interval Tested:	3414'	3459'		
Times: 35" - 30" - 30" - 60"				
Initial Flow Pressure: 223 - 797 PSI				
Final Flow Pressure: 867 - 1045 PSI				
Initial Shut-In Pressure: 1155 PSI				
Final Shut-In Pressure: 1162 PSI				
Recovery: 80' VSLO & GCM				
350' O & GCM				
360' HO & GCM				
1300' Oily Wtr (70% Oil)				
390' VSLO & GC Wtr.				
Bottom Hole Temperature: 105°				
OPEN HOLE LOGS:				
RADIATION GUARD	3000'	3580'		

USE ADDITIONAL SHEETS, IF NECESSARY, TO COMPLETE WELL RECORD.

Date Received	Signature
	Title
	Date