

KANSAS DRILLERS LOG

S. 2 T. 28 R. 17 ^E/_W
 Loc. 700 EWL 500 NSL SE

API No. 15 — 133 — 20,391
 County Number

County Neosho

Operator L. F. Kepley
 Address 4226 South Gold
Wichita, Kansas

Well No. #1 Lease Name L. F. Kepley

Footage Location
500 feet from ~~the~~ (S) line 700 feet from (W) line SE/4

Principal Contractor Dobbie Drilling Co Geologist Max S. Hoy

Spud Date October 7, 1974 Total Depth 1008 P.B.T.D. 854

Date Completed JUNE 27 1975 Oil Purchaser NICO-AMERICA

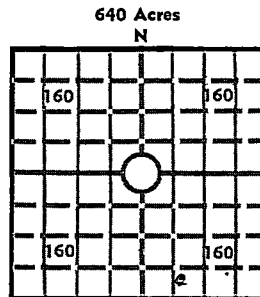

Locate well correctly

Elev.: Gr. _____

DF _____ KB _____

CASING RECORD

Report of all strings set — surface, intermediate, production, etc.

Purpose of string	Size hole drilled	Size casing set (in O.D.)	Weight lbs/ft.	Setting depth	Type cement	Sacks	Type and percent additives
Surface	8 1/4"	7"		35'			
Oil string	2"	4 1/4"		865'	BULK	100	

LINER RECORD

PERFORATION RECORD

Top, ft.	Bottom, ft.	Sacks cement	Shots per ft.	Size & type	Depth interval
<u>NONE</u>			<u>Total - 17</u>	<u>1 1/2" - 13 5/8"</u>	<u>691 - 707</u>
			<u>" - 10</u>	<u>1 1/8" - 13 5/8"</u>	<u>821 - 827</u>

TUBING RECORD

Size	Setting depth	Packer set at
<u>1"</u>	<u>814</u>	<u>NONE</u>

ACID, FRACTURE, SHOT, CEMENT SQUEEZE RECORD

Amount and kind of material used	Depth interval treated
<u>4000# sand in 80 Bbls Oil</u>	<u>691-707</u>
<u>3500# sand in 110 Bbls gelled water</u>	<u>821-827</u>

INITIAL PRODUCTION

Date of first production <u>June 5 1975</u> <u>June 25 1975 - lower</u>	Producing method (flowing, pumping, gas lift, etc.) <u>PUMPING</u>
RATE OF PRODUCTION PER 24 HOURS Oil <u>lower 12</u> <u>upper 4</u> bbls.	Gas <u>-0-</u> <u>-0-</u> MCF
Water <u>1</u> <u>2</u> bbls.	Gas-oil ratio CFPB
Disposition of gas (vented, used on lease or sold)	Producing interval (s) <u>691-707 and 821-827</u>

INSTRUCTIONS: As provided in KCC Rule 82-2-125, within 90 days after completion of a well, one completed copy of this Drillers Log shall be transmitted to the State Geological Survey of Kansas, 4150 Monroe Street, Wichita, Kansas 67209. Copies of this form are available from the Conservation Division, State Corporation Commission, 3830 So. Meridian (P.O. Box 17027), Wichita, Kansas 66217. Phone AC 316-522-2206. If confidential custody is desired, please note Rule 82-2-125. Drillers Logs will be on open file in the Oil and Gas Division, State Geological Survey of Kansas, Lawrence, Kansas 66044.

Operator

L. F. KEPLEY

DESIGNATE TYPE OF COMP.: OIL, GAS, DRY HOLE, SWDW, ETC.:

Well No.

1

Lease Name

L. F. KEPLEY

Oil

S 2 T 28 R 17 E

WELL LOG

Show all important zones of porosity and contents thereof; cored intervals, and all drill-stem tests, including depth interval tested, cushion used, time tool open, flowing and shut-in pressures, and recoveries.

SHOW GEOLOGICAL MARKERS, LOGS RUN, OR OTHER DESCRIPTIVE INFORMATION.

FORMATION DESCRIPTION, CONTENTS, ETC.

TOP

BOTTOM

NAME

DEPTH

Gamma Ray - Neutron Log Enclosed

USE ADDITIONAL SHEETS, IF NECESSARY, TO COMPLETE WELL RECORD.

Date Received

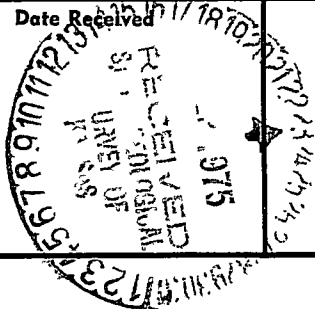

Signature

Title

Date

2-28-17E

State Geological Survey
WICHITA, BRANCH

L. F. KEPLEY

KEPLEY NO. 1

500'FSL-700'FWL SE/4 Sec. 2-28S-17E

NEOSHO CO., KANSAS

<u>FORMATION</u>	<u>TOP</u>	<u>BOTTOM</u>
Top Soil	0	3
Clay	3	8
Shale	8	35
Lime	35	44
Sandy Sh & Ls	44	74
Shale-ss&ls	74	172
Lime	172	256
Sandy sh	256	289
Lime	289	301
Shale	301	305
Lime	305	319
Shale	319	323
Lime	323	362
Shale-Gas Odor	362	365
Lime	365	370
Shale	370	410
Ss & sh	410	440
Lime	440	480
Shale	480	560
Lime	560	564
Shale	564	570
Lime	570	600
Shale	600	636
Lime	636	654
Shale	654	660
Lime	660	666
Black Shale	666	668
Shale	668	686
Sand (squirrel)	686	710
Shale	710	740



Lime	740	744
Shale	744	770
Sandy Sh	770	792
Sandy (U. Cattleman)	792	800
Shale	800	818
Sand (L. Cattleman)	818	826
Sandy Sh	826	844
Black Shale	844	849
Sandy Shale	849	860
Shale	860	868
Sand (L.B.)	868	876
Sandy Sh	876	896
Sand & Sandy Sh (Tucker)	896	1008 T. D.

