

25-32-3E

KANSAS DRILLERS LOG

State Geological Survey
WICHITA, BRANCH

S. 25 T. 32 R. 3 E
Loc. 75 E of C S $\frac{1}{2}$ NW SW
County Cowley

API No. 15 — 035 — 20,562
County Number

Operator
Sun Range Resources Company

Address 240 Page Court, 220 West Douglas
Wichita, Kansas 67202

Well No. #1 Lease Name Beekman

Footage Location
990 feet from (N) $\frac{1}{4}$ line 660 feet from XEX (W) line

Principal Contractor DNB Drilling, Inc. Geologist R. Kenneth Smith

Spud Date 8-28-73 Total Depth 3325' P.B.T.D. 3325

Date Completed 9-8-73 Oil Purchaser

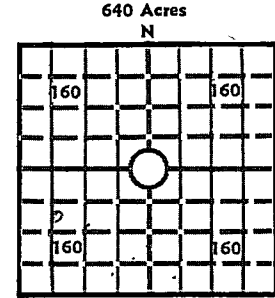

Locate well correctly
Elev.: Gr. 1192

DF 1194 KB 1197

CASING RECORD

Report of all strings set— surface, intermediate, production, etc.

Purpose of string	Size hole drilled	Size casing set (in O.D.)	Weight lbs/ft.	Setting depth	Type cement	Sacks	Type and percent additives
Surface		8 5/8"		192'		100	

LINER RECORD

PERFORATION RECORD

Top, ft.	Bottom, ft.	Sacks cement	Shots per ft.	Size & type	Depth interval

Size	Setting depth	Packer set at

ACID, FRACTURE, SHOT, CEMENT SQUEEZE RECORD

Amount and kind of material used	Depth interval treated

INITIAL PRODUCTION

Date of first production		Producing method (flowing, pumping, gas lift, etc.)			
RATE OF PRODUCTION PER 24 HOURS	Oil	Gas	Water	Gas-oil ratio	
	bbls.	MCF	bbls.	CFPB	
Disposition of gas (vented, used on lease or sold)			Producing interval (s)		

INSTRUCTIONS: As provided in KCC Rule 82-2-125, within 90 days after completion of a well, one completed copy of this Drillers Log shall be transmitted to the State Geological Survey of Kansas, 4150 Monroe Street, Wichita, Kansas 67209. Copies of this form are available from the Conservation Division, State Corporation Commission, 3830 So. Meridian (P.O. Box 17027), Wichita, Kansas 66217. Phone AC 316-522-2206. If confidential custody is desired, please note Rule 82-2-125. Drillers Logs will be on open file in the Oil and Gas Division, State Geological Survey of Kansas, Lawrence, Kansas 66044.

Operator

Sun Range Resources Co

DESIGNATE TYPE OF COMP.: OIL, GAS, DRY HOLE, SWDW, ETC.:

D & A

Well No.

#1

Lease Name

Beekman

S 25 T 32 R 3 E
XK

WELL LOG

Show all important zones of porosity and contents thereof; cored intervals, and all drill-stem tests, including depth interval tested, cushion used, time tool open, flowing and shut-in pressures, and recoveries.

SHOW GEOLOGICAL MARKERS, LOGS RUN, OR OTHER DESCRIPTIVE INFORMATION.

FORMATION DESCRIPTION, CONTENTS, ETC.	TOP	BOTTOM	NAME	DEPTH
Hoover Sand	1724			
Iatan	2078			
Perry Sand	2319		DST #1	2312-29
Layton	2523			
Kansas City	2679		DST #2	2737-44
BKC	2784			
Oswego	2869			
Bartlesville	3154		DST #3	3155-68
Mississippian	3175			

USE ADDITIONAL SHEETS, IF NECESSARY, TO COMPLETE WELL RECORD

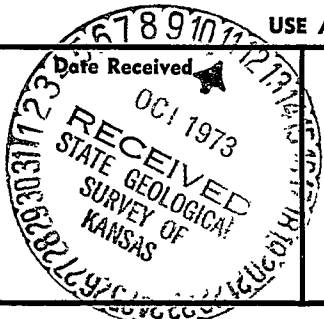

[Handwritten Signature]

Signature

President, Range Oil Company, Inc.

Title

September 10, 1973

Date

25-32-3E
C 1/2 NW SW

DRILLERS' LOG

API # 15-035-20562

RANGE OIL COMPANY
No. 1 Beekman
C S/2 NW SW, Sec. 25-32S-3E
Cowley County, Kansas

Elevation: 1197 K.B.

Commenced: 9-2-73
Completed: 9-8-73

Surface Casing: 193' of
8-5/8" cemented w/100 sx
cement, 2% cc. 9-2-73

FORMATION

DEPTH

Surface Hole	0 - 200
Lime & Shale	200 - 740
Shale & Lime	740 - 2110
Sand	2110 - 2210
Shale & Lime	2210 - 2319
Sand	2319 - 2329
Shale & Lime	2329 - 2705
Lime	2703 - 2758
Lime & Shale	2758 - 2890
Lime	2890 - 2978
Shale & Lime	2978 - 3119
Lime & Shale	3119 - 3168
Lime	3167 - 3225 T.D.

Smp tops

sev sd	1391
hoover sd	1724
iatan	2078
stal	2131
perry sd	2319
lay sd	2523
kc	2679
bkc	2784
clev sd	2815
oswego	2869
cher	2981
bart sd	3144
miss	3175
rt	3225

I do hereby certify that the foregoing statements are true and correct to the best of my knowledge and belief.

D N B DRILLING, INC.

James L. Donelson
JAMES L. DONELSON

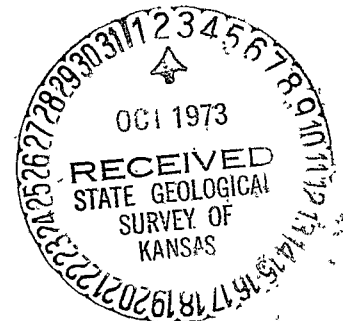

STATE OF KANSAS: ss:

Subscribed and sworn to before me, the undersigned, a Notary Public in and for said state, this 11th day of September, 1973.

My Commission Expires:
8-25-76

Ella Priess
Ella Priess, Notary Public

Ella Priess
STATE NOTARY PUBLIC
Sedgwick County, Kansas
My Com. Expires Aug. 25, 1976