

PI

KANSAS

25-16-21W

State Geological Survey
WICHITA BRANCH

WELL COMPLETION REPORT AND DRILLER'S LOG

API No. 15 — 135 — 21,921
County Number

Operator
A. L. Abercrombie, Inc.

Address
801 Union Center, Wichita, KS. 67202

Well No. #3 Lease Name GRUMBETN #3

Footage Location
2310 feet from (N) line 990' feet from (E) line

Principal Contractor Abercrombie Drilling, Inc. Geologist Steve Frankamp

Spud Date 1/05/81 Date Completed 1/13/81 Total Depth 4160' P.B.T.D.

Directional Deviation Oil and/or Gas Purchaser

Loc. SW SE NE
County Ness County

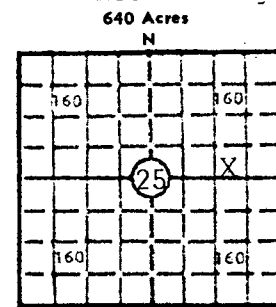

Elev.: Gr. 2199'

DF KB

CASING RECORD

Report of all strings set—surface, intermediate, production, etc.

Purpose of string	Size hole drilled	Size casing set (in O.D.)	Weight lbs/ft.	Setting depth	Type cement	Socks	Type and percent additives
Surface	12 1/2"	8 5/8"	20#	289' KB	common	200 sx.	2% gel, 3% c.c.

LINER RECORD

PERFORATION RECORD

Top, ft.	Bottom, ft.	Socks cement	Shots per ft.	Size & type	Depth interval

TUBING RECORD		
Size	Setting depth	Packer set at

ACID, FRACTURE, SHOT, CEMENT SQUEEZE RECORD

Amount and kind of material used	Depth interval treated

INITIAL PRODUCTION

Date of first production	Producing method (flowing, pumping, gas lift, etc.)			
RATE OF PRODUCTION PER 24 HOURS	Oil bbls.	Gas MCF	Water bbls.	Gas-oil ratio CFPB
Disposition of gas (vented, used on lease or sold)			Producing interval(s) D & A	

INSTRUCTIONS: As provided in KCC Rule 82-2-125, within 90 days after completion of a well, one completed copy of this Drillers Log shall be transmitted to the State Geological Survey of Kansas, 4150 Monroe Street, Wichita, Kansas 67209. Copies of this form are available from the Conservation Division, State Corporation Commission, 245 No. Water, Wichita, Kansas 67202. Phone AC 316-522-2206. If confidential custody is desired, please note Rule 82-2-125. Drillers Logs will be on open file in the Oil and Gas Division, State Geological Survey of Kansas, Lawrence, Kansas 66044.

Operator A. L. Abercrombie, Inc.		DESIGNATE TYPE OF COMP.: OIL, GAS, DRY HOLE, SWDW, ETC.:
Well No. #3	Lease Name GRUMBEIN	Dry Hole
S 25 T 16SR 21W ^E _W		

WELL LOG

Show all important zones of porosity and contents thereof; cored intervals, and all drill-stem tests, including depth interval tested, cushion used, time tool open, flowing and shut-in pressures, and recoveries.

SHOW GEOLOGICAL MARKERS, LOGS RUN, OR OTHER DESCRIPTIVE INFORMATION.

FORMATION DESCRIPTION, CONTENTS, ETC.	TOP	BOTTOM	NAME	DEPTH
Sand & Shale	0	1480	<u>SAMPLE TOPS:</u>	
Anhydrite	1480	1516		
Sand & Shale	1516	2455	Anhydrite	1480'
Shale & Lime	2455	4160	B/Anhydrite	1515'
Rotary Total Depth		4160	Heebner	3581' (-1377)
			Lansing	3625' (-1421)
DST #1 (4016'-4066') 30", 45", 60", 45". Rec. 30' OCM (10% oil), 60' SOCM (3% oil) 60' watery mud, 235' MW. IFP 95#-157#, IBHP 891#, FFP 189#-222#, FBHP 795#.			B/KC	3887' (-1423)
			Pawnee	3962' (-1758)
			Cher. Shale	4026' (-1822)
DST #2 (4069'-4080') Misrun.			<u>ELECTRIC LOG TOPS:</u>	
DST #3 (4072'-4080') Packers Failed, Misrun.			Anhydrite	1482' (+722)
			B/Anhydrite	1516' (+688)
			Heebner	3576' (-1372)
DST #4 (4097'-4140') Straddle Packers. 30", 45", 30", 45". Rec. 5' mud. IFP 31#-31#, IBHP 1273#, FFP 31#-63#, FBHP 957#.			Toronto	3596' (-1392)
			Lansing	3621' (-1417)
			B/KC	3883' (-1423)
			Pawnee	3957' (-1753)
			Cher. Shale	4024' (-1820)
			Arbuckle	4134' (-1930)
			LTD	
			DTD	

USE ADDITIONAL SHEETS, IF NECESSARY, TO COMPLETE WELL RECORD.

Date Received	 Jack L. Partridge <small>Signature</small> Assistant Secretary/Treasurer <small>Title</small> January 20, 1981 <small>Date</small>
---------------	--