

WICHITA BRANCH  
KANSAS DRILLERS LOG

API No. 15 — \_\_\_\_\_ County \_\_\_\_\_ Number \_\_\_\_\_

S. 4 T. 16S R. 21W E W  
Loc. C NW SW  
County \_\_\_\_\_ Ness \_\_\_\_\_

Operator  
Beren Corporation

Address  
970 Fourth Financial Center, Wichita, Kansas 67202

Well No. 2 Lease Name (See original Drillers Log for)  
BUSTER OWWO Pickrell's Elmore "J" #1

Footage Location NOTE: Production pipe was already set.  
feet from (N) (S) line feet from (E) (W) line

Principal Contractor \_\_\_\_\_ Geologist \_\_\_\_\_

Spud Date \_\_\_\_\_ Total Depth \_\_\_\_\_ P.B.T.D. \_\_\_\_\_

Date Completed \_\_\_\_\_ Oil Purchaser \_\_\_\_\_

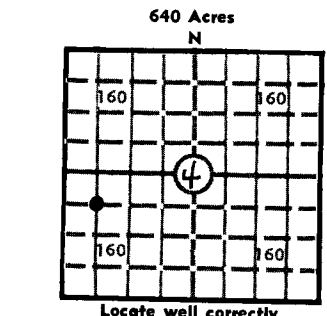

Elev.: Gr. \_\_\_\_\_  
DF \_\_\_\_\_ KB \_\_\_\_\_

CASING RECORD

Report of all strings set — surface, intermediate, production, etc.

Purpose of string	Size hole drilled	Size casing set (in O.D.)	Weight lbs/ft.	Setting depth	Type cement	Sacks	Type and percent additives

LINER RECORD

PERFORATION RECORD

Top, ft.	Bottom, ft.	Sacks cement	Shots per ft.	Size & type	Depth interval

TUBING RECORD

Size	Setting depth	Packer set at

ACID, FRACTURE, SHOT, CEMENT SQUEEZE RECORD

Amount and kind of material used	Depth interval treated

INITIAL PRODUCTION

Date of first production _____	Producing method (flowing, pumping, gas lift, etc.) _____
RATE OF PRODUCTION PER 24 HOURS	Oil _____ Gas _____ Water _____ Gas-oil ratio _____
Disposition of gas (vented, used on lease or sold) _____	Producing interval(s) _____

INSTRUCTIONS: As provided in KCC Rule 82-2-125, within 90 days after completion of a well, one completed copy of this Drillers Log shall be transmitted to the State Geological Survey of Kansas, 4150 Monroe Street, Wichita, Kansas 67209. Copies of this form are available from the Conservation Division, State Corporation Commission, 3830 So. Meridian (P.O. Box 17027), Wichita, Kansas 66217. Phone AC 316-522-2206. If confidential custody is desired, please note Rule 82-2-125. Drillers Logs will be on open file in the Oil and Gas Division, State Geological Survey of Kansas, Lawrence, Kansas 66044.

Operator

DESIGNATE TYPE OF COMP.: OIL, GAS, DRY HOLE, SWDW, ETC.:

Well No.

Lease Name

S \_\_\_\_\_ T \_\_\_\_\_ R \_\_\_\_\_ E \_\_\_\_\_ W \_\_\_\_\_

### WELL LOG

Show all important zones of porosity and contents thereof; cored intervals, and all drill-stem tests, including depth interval tested, cushion used, time tool open, flowing and shut-in pressures, and recoveries.

SHOW GEOLOGICAL MARKERS, LOGS RUN, OR OTHER DESCRIPTIVE INFORMATION.

FORMATION DESCRIPTION, CONTENTS, ETC.	TOP	BOTTOM	NAME	DEPTH

USE ADDITIONAL SHEETS, IF NECESSARY, TO COMPLETE WELL RECORD.

Date Received

*Don W. Beauchamp*

Signature

Don Beauchamp - Geologist

Title

December 1, 1978

Date