

State

Kansas

County

Barber

Company

Sinclair O. &amp; G. Co.

Well No. 1

Farm

Welsh

Survey

Block No.

Sec. 7

Twp. 32<sup>s</sup>Range 15<sup>w</sup>

Co-Ord.

Elev.

See well sec

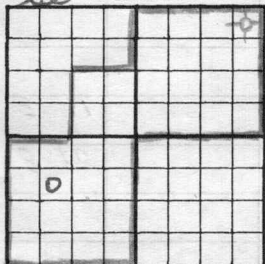

M.R., et al royalty

NOTE: Show Sketch of Lease and Well Location in Above Space

Ft. from N. Line

Ft. from S. Line

Ft. from W. Line

Ft. from E. Line

Date	Depth	
	4799	Miss (-2847) (16' lower than Perry Ranch #1)
D.S.G. #1	4799 - 4830	sp. 3 kw Gas in 3 1/2", stabilized @ 1,020,000 ccy., Res. 130' geom, BHP 1715-1698 <sup>2</sup> 3.P. - 100 - 155 <sup>#</sup>

Date	Depth	715419
	D.S.J. #2 - 4830 - 70 - Op. 3 hrs.	Gas in 2'45", too small to measure, Rec. 60' gem F.P. - 15-15#, BHP - 815-1690#
	D.S.J. #3 - 4870 - 4900 - Op. 3 hrs.	Rec 60' sli gem w/oil spots, F.P. - 30-30# BHP - 1645 - 1355#
3-9		(To drill to 4985' & run log) To perf. 4918-24 w/2 ft Treated w/500 gal. m.a. Subd back & had rainbow show of oil on acid water & odor of gas (1 1/2 bbls)
3-10		Treated w/500 gal m.a.
3-11		Subd. back - <del>sub.</del> 1/2 bbls w/trace oil & flowed 187/14 hrs (load) 400,000 cfs & trace oil To test (44 bbls load to go)
3-12		24 hrs. - flowed 22 bbls. load - 3 bo (25°) 3/4 bbl. load/hr. + trace oil 350,000 cfs. Set plug + perf 4811-27



