

WICHITA BRANCH

KANSAS DRILLERS LOG

IMPORTANT
 Kans. Geo. Survey request
 samples on this well.

15-135-21407

API No. 15 — 135 — 21,407
 County Number

Operator
Pickrell Drilling Company

Address
205 Litwin Building Wichita, Kansas 67202

Well No. #1 Lease Name
Sidebottom "B"

Footage Location
 feet from (N) (S) line feet from (E) (W) line

Principal Contractor Geologist
PICKRELL DRILLING COMPANY DICK LINEHAN

Spud Date Total Depth P.B.T.D.
12-30-78 4509

Date Completed Oil Purchaser
1-28-78

S. 33 T. 16 R. 24 ^{NE}/_W
 Loc. SW SW
 County Ness

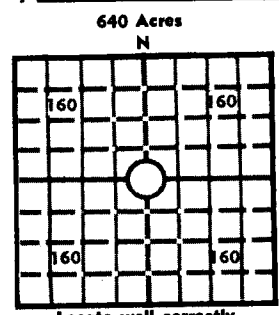

Elev.: Gr. 2484
 DF 2486 KB 2489

CASING RECORD

Report of all strings set — surface, intermediate, production, etc.

| Purpose of string | Size hole drilled | Size casing set (in O.D.) | Weight lbs./ft. | Setting depth | Type cement | Sacks | Type and percent additives |
|-------------------|-------------------|---------------------------|-----------------|---------------|-------------|-------|----------------------------|
| Surf. casing | | 8 5/8 | | 215 | | 150 | |
| Prod. casing | | 4 1/2 | | 4488 | | 150 | |
| | | | | | | | |
| | | | | | | | |

LINER RECORD

PERFORATION RECORD

| Top, ft. | Bottom, ft. | Sacks cement | Shots per ft. | Size & type | Depth interval |
|----------|-------------|--------------|---------------|-------------|----------------|
| | | | | | |
| | | | | | |

TUBING RECORD

| Size | Setting depth | Pecker set at |
|------|---------------|---------------|
| | | |

ACID, FRACTURE, SHOT, CEMENT SQUEEZE RECORD

| Amount and kind of material used | Depth interval treated |
|--|------------------------|
| Acidize down 4 1/2 casing with 250 gal. 15% reg. NE Acid. | |
| Adicize down 4 1/2 casing with 1000 gallons 15% re. NE Acid. | |
| | |

INITIAL PRODUCTION

| | |
|--|--|
| Date of first production | Producing method (flowing, pumping, gas lift, etc.) <u>Well was P&A</u> |
| RATE OF PRODUCTION PER 24 HOURS | Oil Gas Water Gas-oil ratio bbls. MCF bbls. CFPB |
| Disposition of gas (vented, used on lease or sold) | Producing interval(s) |

INSTRUCTIONS: As provided in KCC Rule 82-2-125, within 90 days after completion of a well, one completed copy of this Drillers Log shall be trans-
 mitted to the State Geological Survey of Kansas, 4150 Monroe Street, Wichita, Kansas 67209. Copies of this form are available from the Conservation
 Division, State Corporation Commission, 3830 So. Meridian (P.O. Box 17027), Wichita, Kansas 66217. Phone AC 316-522-2206. If confidential custody
 is desired, please note Rule 82-2-125. Drillers Logs will be on open file in the Oil and Gas Division, State Geological Survey of Kansas, Lawrence, Kansas
 66044.

Operator **PICKRELL DRILLING COMPANY** DESIGNATE TYPE OF COMP.: OIL, GAS, DRY HOLE, SWDW, ETC.: **DRY HOLE**

Well No. **1** Lease Name **SIDEBOTTOM "B"**

S 33 T 16S R 24W E
W

WELL LOG

Show all important zones of porosity and contents thereof; cored intervals, and all drill-stem tests, including depth interval tested, cushion used, time tool open, flowing and shut-in pressures, and recoveries.

SHOW GEOLOGICAL MARKERS, LOGS RUN, OR OTHER DESCRIPTIVE INFORMATION.

| FORMATION DESCRIPTION, CONTENTS, ETC. | TOP | BOTTOM | NAME | DEPTH |
|---------------------------------------|------|--------|------|-------|
| Top Soil & Clay | 20 | 20 | | |
| Shale | 20 | 217 | | |
| Shale | 217 | 1211 | | |
| Blaine | 1211 | 1219 | | |
| Shale | 1219 | 1410 | | |
| Sand & Shale | 1410 | 1824 | | |
| Sand & Shale | 1824 | 1835 | | |
| Shale | 1835 | 1864 | | |
| Shale | 1864 | 2190 | | |
| Shale & Lime | 2190 | 2489 | | |
| Lime & Shale | 2489 | 2610 | | |
| Shale & Lime | 2610 | 2820 | | |
| Lime & Shale | 2820 | 2970 | | |
| Shale & Lime | 2970 | 3165 | | |
| Lime & Shale | 3165 | 3320 | | |
| Lime & Shale | 3320 | 3495 | | |
| Shale & Lime | 3495 | 3690 | | |
| Lime | 3690 | 3880 | | |
| Lime | 3880 | 4020 | | |
| Lime & Shale | 4020 | 4135 | | |
| Lime | 4135 | 4235 | | |
| Lime | 4235 | 4335 | | |
| Lime | 4335 | 4390 | | |
| Lime & Sand | 4390 | 4470 | | |
| Lime | 4470 | 4490 | | |
| Lime | 4490 | 4509 | | |

USE ADDITIONAL SHEETS, IF NECESSARY, TO COMPLETE WELL RECORD.

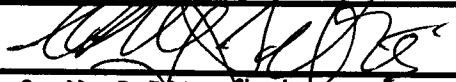
| | |
|---------------|--|
| Date Received |  |
| | C. W. Sebitts Partner |
| | Title |
| | 3-24-78 |
| | Date |