

12-25-21 E ✓

**KANSAS DRILLERS LOG**

State Geological Survey  
WICHITA, BRANCH

S. 12 T. 25 R. 21 <sup>E</sup><sub>W</sub>  
Loc. 330' SNL & 330' EWL NE

API No. 15 — 011 — 20,212  
County Number

County Bourbon

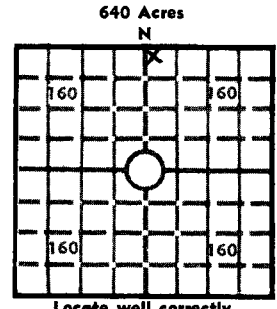

Elev.: Gr. \_\_\_\_\_  
DF \_\_\_\_\_ KB \_\_\_\_\_

Operator  
Hillenburg Oil Company

Address  
116th and South Lynn Lane Road Broken, Arrow, Okla 74012

Well No. #34 Lease Name Woodward

Footage Location 330 feet from (N) (S) line 330 feet from (E) (W) line

Principal Contractor Don Eastwood Geologist Oilfield Research

Spud Date 12-16-75 Total Depth 715' P.B.T.D. \_\_\_\_\_

Date Completed 12-19-75 Oil Purchaser Producers Pipe Line

**CASING RECORD**

Report of all strings set— surface, intermediate, production, etc.

Purpose of string	Size hole drilled	Size casing set (in O.D.)	Weight lbs/ft.	Setting depth	Type cement	Sacks	Type and percent additives
<u>Surface</u>	<u>8"</u>	<u>7"</u>		<u>21.60'</u>		<u>5</u>	
<u>Prod.</u>	<u>6 1/4"</u>	<u>4 1/2"</u>		<u>705'</u>		<u>115</u>	

**LINER RECORD**

**PERFORATION RECORD**

Top, ft.	Bottom, ft.	Sacks cement	Shots per ft.	Size & type	Depth interval

Size	Setting depth	Packer set at

**ACID, FRACTURE, SHOT, CEMENT SQUEEZE RECORD**

Amount and kind of material used	Depth interval treated

**INITIAL PRODUCTION**

Date of first production \_\_\_\_\_ Producing method (flowing, pumping, gas lift, etc.) \_\_\_\_\_

RATE OF PRODUCTION PER 24 HOURS	Oil	Gas	Water	Gas-oil ratio
	bbis.	MCF	bbis.	CFPB

Disposition of gas (vented, used on lease or sold) \_\_\_\_\_ Producing interval (s) \_\_\_\_\_

INSTRUCTIONS: As provided in KCC Rule 82-2-125, within 90 days after completion of a well, one completed copy of this Drillers Log shall be transmitted to the State Geological Survey of Kansas, 4150 Monroe Street, Wichita, Kansas 67209. Copies of this form are available from the Conservation Division, State Corporation Commission, 3830 So. Meridian (P.O. Box 17027), Wichita, Kansas 66217. Phone AC 316-522-2206. If confidential custody is desired, please note Rule 82-2-125. Drillers Logs will be on open file in the Oil and Gas Division, State Geological Survey of Kansas, Lawrence, Kansas 66044.