

12-25-21 E ✓

State Geological Survey
WICHITA, BRANCH

KANSAS DRILLERS LOG

S. 12 T. 25 R. 21 E
W
Loc. 2180' EWL & 1100' NSL NW
County Bourbon

API No. 15 — 011 — 20,224
County Number

Operator
Hillenburg Oil Company

Address
116th St. & South Lynn Lane Road Broken Arrow, Okla 74012

Well No. #36 Lease Name Woodward

Footage Location 1100 feet from (N) (S) line 3190 feet from (E) (W) line

Principal Contractor Spradling Hrdg. Ind. Geologist Citfield Research

Spdd Date 3-2-76 Total Depth 710' P.B.T.D.

Date Completed Oil Purchaser Produced Pipe Line

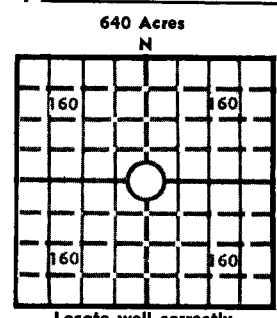

Elev.: Gr. _____
DF _____ KB _____

CASING RECORD

Report of all strings set — surface, intermediate, production, etc.

Purpose of string	Size hole drilled	Size casing set (in O.D.)	Weight lbs/ft.	Setting depth	Type cement	Sacks	Type and percent additives
<u>Surf.</u>				<u>25'</u>			
<u>Prod.</u>	<u>6 1/4</u>	<u>4 1/2</u>		<u>682</u>		<u>110</u>	

LINER RECORD

PERFORATION RECORD

Top, ft.	Bottom, ft.	Sacks cement	Shots per ft.	Size & type	Depth interval

Size	Setting depth	Packer set at

ACID, FRACTURE, SHOT, CEMENT SQUEEZE RECORD

Amount and kind of material used	Depth interval treated

INITIAL PRODUCTION

Date of first production		Producing method (flowing, pumping, gas lift, etc.)			
RATE OF PRODUCTION PER 24 HOURS	Oil bbls.	Gas MCF	Water bbls.	Gas-oil ratio CFPB	
Disposition of gas (vented, used on lease or sold)			Producing interval(s)		

INSTRUCTIONS: As provided in KCC Rule 82-2-125, within 90 days after completion of a well, one completed copy of this Drillers Log shall be transmitted to the State Geological Survey of Kansas, 4150 Monroe Street, Wichita, Kansas 67209. Copies of this form are available from the Conservation Division, State Corporation Commission, 3830 So. Meridian (P.O. Box 17027), Wichita, Kansas 66217. Phone AC 316-522-2206. If confidential custody is desired, please note Rule 82-2-125. Drillers Logs will be on open file in the Oil and Gas Division, State Geological Survey of Kansas, Lawrence, Kansas 66044.