

KANSAS CORPORATION COMMISSION

WELL RECORD

API# 15-135-20,584

(Mail to Kansas Geological Survey, 4150 Monroe Street, Wichita, Kansas 67209)

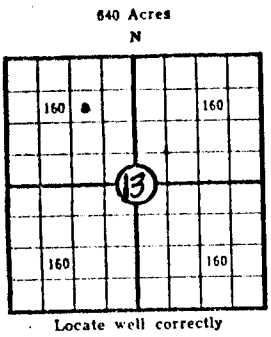

Lease Name: Sargent Well No. 1  
 Well Located: SW NE NW  
Ness SEC 13 TWP 16S RGE 25W  
 Operator: Thunderbird Drilling Company  
 Address: P. O. Box 18407 Wichita, Kansas 67218  
 Elevation: Ground 2527 D.F. 2529 K.B. 2532  
 Type Well: (Oil, gas, dry hole) Temp. Aban. 5/11/72  
 Contractor: Rains + Williamson Oil Co., Inc.

Drilling Commenced: 3-18 1972 Drilling Completed: 3-28 1972  
 Well Completed: 4-8 1972 Total Depth 4525  
 Initial Production: Temporarily Abandoned

Casing Record

Size: 8 5/8" Set at 335' Size: \_\_\_\_\_ Set at \_\_\_\_\_  
 Size: 5 1/2" Set at 4512' Size: \_\_\_\_\_ Set at \_\_\_\_\_

Liner Record

Size: None Set from \_\_\_\_\_ To \_\_\_\_\_

Cementing

Casing Size	Sacks	Type Cement and Additives
<u>8 5/8"</u>	<u>200</u>	<u>2% Gel, 3% CC</u>
<u>5 1/2"</u>	<u>100</u>	<u>Common 2% Gel</u>

Perforations

Formation	Perforated Interval and Number Shots
_____	<u>No perforations</u>
_____	_____
_____	_____
_____	_____

Electric Log Run (Show type log and depths covered)

Radiation Guard - Frac Finder

Formation	Top	Bottom		
Marmaton	4188	4308	DST #1	Weak blow for 6 min. Flushed tool 5 min. after 2nd opening. Rec. 15' of mud, IFP 80, FFP 100, FSIP 104.
Pawnee-Ft. Scott	4380	4420	DST #2	Weak blow for 8 min. Rec. 20' of mud, IFP 64, FFP 74, FSIP 90.
Mississippi	4487	4519	DST #3	Weak steady blow throughout test. Rec. 150' of oil cut mud, IFP 64, FFP 99, FSIP 843.
Miss. Warsaw	4493	4525	DST #4	Fair blow throughout test. Rec. 180' of oil cut mud, IFP 55, FFP 99, FSIP 798.

TOPS

Heebner	3856	-1324
Toronto Ls.	3875	-1343
Lansing Ls.	3894	-1362
B/Kansas City Ls.	4191	-1659
Marmaton Ls.	4227	-1685
Pawnee Ls.	4315	-1783
Ft. Scott Ls.	4392	-1860
Cherokee Sh.	4420	-1888
Mississippi	4484	-1952
Miss. Warsaw	4512	-1980

Surface Clay	40
Shale	70
Sand and Shale	340
Shale and Sand	590
Shale	1435
Sand	1645
Shale	1904
Anhydrite	1944
Shale	2505
Shale and Lime	3360
Lime and Shale	3940
Lime	4525
Rotary Total Depth	4525



LOG TOPS	
ANHY	1902
*B ANHY	1944
HEEB	3855
TOR	3875
LKC	3894
BKC	4192
MARM	4228
PAWN	4316
FT SC	4396
CHER	4420
MISS	4488
LTD	4525
* SMP TOP	