

KANSAS DRILLERS LOG

S. 20 T. 16S R. 25W E
W
Loc. C SW/4
County Ness

API No. 15 — 135 — 21,618
County Number

Operator
Chief Drilling Co., Inc.

Address
905 Century Plaza, Wichita, Kansas 67202

Well No. #7 Lease Name Michaelis

Footage Location
feet from (N) (S) line feet from (E) (W) line

Principal Contractor Warrior Drilling, Inc. Geologist Tom Wesselowski

Spud Date April 30, 1979 Total Depth 4514' P.B.T.D.

Date Completed June 13, 1979 Oil Purchaser Clear Creek, Inc.

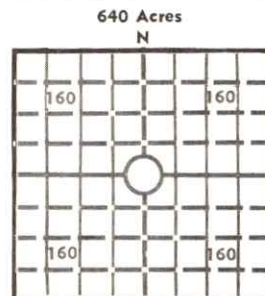

Locate well correctly
Elev.: Gr. _____
DF _____ KB _____

CASING RECORD

Report of all strings set — surface, intermediate, production, etc.

Purpose of string	Size hole drilled	Size casing set (in O.D.)	Weight lbs/ft.	Setting depth	Type cement	Sacks	Type and percent additives
	12 1/4"	8 5/8"	28 lb.	312'	Common	170	3% c.c., 2% gel.
		5 1/2"		4505'	50/50 posmix 60/40 posmix	500/top 250 bot.	6% gel salt satur.

LINER RECORD

PERFORATION RECORD

Top, ft.	Bottom, ft.	Sacks cement	Shots per ft.	Size & type	Depth interval

Size	Setting depth	Packer set at
2 3/8"	4502'	none

ACID, FRACTURE, SHOT, CEMENT SQUEEZE RECORD

Amount and kind of material used	Depth interval treated
2000 gals	Open hole

INITIAL PRODUCTION

Date of first production <u>June 19, 1979</u>	Producing method (flowing, pumping, gas lift, etc.) <u>Pumping</u>			
RATE OF PRODUCTION PER 24 HOURS	Oil <u>70</u> bbls.	Gas <u>None</u> MCF	Water <u>19%</u> XXX	Gas-oil ratio <u>None</u> CFPB
Disposition of gas (vented, used on lease or sold)		Producing interval (s) <u>4504-4514'</u>		

INSTRUCTIONS: As provided in KCC Rule 82-2-125, within 90 days after completion of a well, one completed copy of this Drillers Log shall be transmitted to the State Geological Survey of Kansas, 4150 Monroe Street, Wichita, Kansas 67209. Copies of this form are available from the Conservation Division, State Corporation Commission, 3830 So. Meridian (P.O. Box 17027), Wichita, Kansas 66217. Phone AC 316-522-2206. If confidential custody is desired, please note Rule 82-2-125. Drillers Logs will be on open file in the Oil and Gas Division, State Geological Survey of Kansas, Lawrence, Kansas 66044.

Operator Chief Drilling Co., Inc. DESIGNATE TYPE OF COMP.: OIL, GAS, DRY HOLE, SWDW, ETC.:

Well No. #7 Lease Name Michaelis Oil Well

S 20 T16S R25W E W

WELL LOG

Show all important zones of porosity and contents thereof; cored intervals, and all drill-stem tests, including depth interval tested, cushion used, time tool open, flowing and shut-in pressures, and recoveries.

SHOW GEOLOGICAL MARKERS, LOGS RUN, OR OTHER DESCRIPTIVE INFORMATION.

FORMATION DESCRIPTION, CONTENTS, ETC.	TOP	BOTTOM	NAME	DEPTH
DST #1 4376-4435'			Anhydrite	1946
30-30 30-30			Base Anhy.	1978
Weak blow 15"			Heebner	3848
Rec. 5' Mud			Lansing	3881
IBHP: 72# FBHP: 51#			Ft. Scott	4389
FP: 30-30#			Miss. Dolo.	4504
			RTD	4514
DST #2 4457-4514'				
30-30 90-60				
Fair blow				
Rec. 120' GIP; 220' C1oil; 240' OCM				
IBHP: 1070# FBHP: 1030# FP: 40-183#				

FORMATION	FROM	TO	ELEVATIONS
Surface Sand & Clay	0	317	2569 Gr.
Shale	317	1944	2571 D.F.
Anhydrite	1944	1978	2574 K.B.
Shale	1978	2260	
Shale & Lime	2260	2930	
Shale	2930	3350	
Lime & Shale	3350	3920	
Shale & Lime	3920	4360	
Lime	4360	4514	
RTD	4514		

5 1/2" @ 4505' w/750 sx

RECEIVED STATE CORPORATION COMMISSION

USE ADDITIONAL SHEETS, IF NECESSARY, TO COMPLETE WELL RECORD.

Date Received	<p><i>Bill Lahar</i> Signature</p> <p>Bill G. Lahar, Manager of Exploration Title</p> <p>August 28, 1979 Date</p>
---------------	---