

KANSAS DRILLERS LOG

RECEIVED
MAR 4 1974
WICHITA
GEOLOGICAL SURVEY

S. 20 T. 16 R. 25 E W

Loc. C NE SE

County Ness

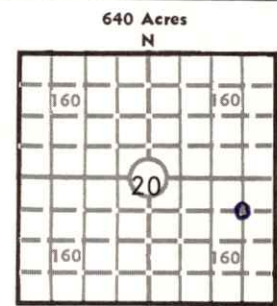

Elev.: Gr. 2594

DF 2596 KB 2599

API No. 15 — 135 — 20,843
County Number

Operator
Petroleum, Inc.

Address 300 West Douglas
Wichita, Kansas 67202 State Geological Survey
WICHITA, BRANCH

Well No. #1 Lease Name Michaelis "B"

Footage Location
1980 feet from XX (S) line 660 feet from (E) XX line

Principal Contractor Strata Drilling, Inc. Geologist H. Deane Jirrels

Spud Date February 11, 1974 Total Depth RTD 4528 P.B.T.D.

Date Completed Feb. 28, 1974 Oil Purchaser Clear Creek, Inc.

CASING RECORD

Report of all strings set — surface, intermediate, production, etc.

Purpose of string	Size hole drilled	Size casing set (in O.D.)	Weight lbs/ft.	Setting depth	Type cement	Sacks	Type and percent additives
Surface	12-1/4"	8-5/8"	20#	325'	Common	200	2% Gel, 3% CC
Production	7-7/8"	5-1/2"	14#	4523'	50/50 Poz	125	friction reducer 18% salt & 10% gilsonite

LINER RECORD

PERFORATION RECORD

Top, ft.	Bottom, ft.	Sacks cement	Shots per ft.	Size & type	Depth interval
			None		

TUBING RECORD

Size	Setting depth	Packer set at
2-3/8" OD	4516'	

ACID, FRACTURE, SHOT, CEMENT SQUEEZE RECORD

Amount and kind of material used	Depth interval treated
None	

INITIAL PRODUCTION

Date of first production March 8, 1974 Producing method (flowing, pumping, gas lift, etc.) Pumping

RATE OF PRODUCTION PER 24 HOURS	Oil	Gas	Water	Gas-oil ratio
	102 bbls.		None bbls.	

Disposition of gas (vented, used on lease or sold) None Producing interval (s) 24 hr.

INSTRUCTIONS: As provided in KCC Rule 82-2-125, within 90 days after completion of a well, one completed copy of this Drillers Log shall be transmitted to the State Geological Survey of Kansas, 4150 Monroe Street, Wichita, Kansas 67209. Copies of this form are available from the Conservation Division, State Corporation Commission, 3830 So. Meridian (P.O. Box 17027), Wichita, Kansas 66217. Phone AC 316-522-2206. If confidential custody is desired, please note Rule 82-2-125. Drillers Logs will be on an open file in the Oil and Gas Division, State Geological Survey of Kansas, Lawrence, Kansas 66044.

Operator
Petroleum, Inc.

DESIGNATE TYPE OF COMP.: OIL, GAS,
DRY HOLE, SWDW, ETC.:

Well No. 1 Lease Name MICHAELIS 'B' Oil

S 20 T 16S R 25W^E W C. NE SE

WELL LOG

Show all important zones of porosity and contents thereof; cored intervals, and all drill-stem tests, including depth interval tested, cushion used, time tool open, flowing and shut-in pressures, and recoveries.

SHOW GEOLOGICAL MARKERS, LOGS RUN,
OR OTHER DESCRIPTIVE INFORMATION.

FORMATION DESCRIPTION, CONTENTS, ETC.	TOP	BOTTOM	NAME	DEPTH
DST #1: 4415-70: 30-30-30-60; 60' oil cut mud; 1FP 56#-74#, 1BHP 870#, 2FP 74#-93#, 2BHP 1018#			Dresser Atlas	GR-N-LL
			E.L. TOPS:	
DST #2: 4487-4521: 30-30-30-30; 20' oil specked mud; 1FP 27#-36#, 1BHP 64#, 2FP 36#-36#, 2BHP 73#			Anhydrite	1968
			Heebner	3875
			Lansing	3916
			Stark	4162
			BKC	4225
			Marmaton	4266
			Pawnee	4346
			Fort Scott	4420
			Cherokee	4446
			Mississippi	4508
			ELTD	4527

USE ADDITIONAL SHEETS, IF NECESSARY, TO COMPLETE WELL RECORD.

Date Received



Richard H. Dumes

Signature

Office Manager

Title

March 19, 1974

Date