

WICHITA BRANCH
KANSAS DRILLERS LOG

IMPORTANT
Kans. Geo. Survey request
samples on this well.

S. 6 T. 28 R. 17 ^E/_W
Loc. C NW SE
County Wilson

API No. 15 — 205 — 20,309
County Number

Operator
Robert G. Hall

Address
1400 United Founders Life Tower Okla City, Okla 73112

Well No. #1 Lease Name
G. Murlin Welch

Footage Location
1980 feet from ~~W~~ (S) line 1980 feet from (E) ~~E~~ line

Principal Contractor
Dobbie Drilling Co. Geologist

Spud Date
8/8/77 Total Depth
1185 P.B.T.D.

Date Completed
8/10/77 Oil Purchaser

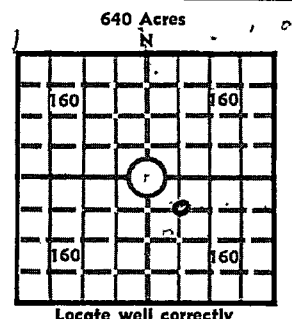

Locate well correctly
Elev.: Gr. _____
DF _____ KB _____

CASING RECORD

Report of all strings set— surface, intermediate, production, etc.

| Purpose of string | Size hole drilled | Size casing set (in O.D.) | Weight lbs/ft. | Setting depth | Type cement | Sacks | Type and percent additives |
|-------------------|-------------------|---------------------------|----------------|---------------|-------------|-------|----------------------------|
| SURFACE | 9" | 6 1/4" | | 52 | port. | 15 | 3% cal. |
| PRODUCTION | 5 1/4" | | | | | | |
| | | | | | | | |
| | | | | | | | |

LINER RECORD

PERFORATION RECORD

| Top, ft. | Bottom, ft. | Sacks cement | Shots per ft. | Size & type | Depth interval |
|----------|-------------|--------------|---------------|-------------|----------------|
| | | | | | |

| Size | Setting depth | Packer set at |
|------|---------------|---------------|
| | | |

ACID, FRACTURE, SHOT, CEMENT SQUEEZE RECORD

| Amount and kind of material used | Depth interval treated |
|----------------------------------|------------------------|
| | |
| | |
| | |

INITIAL PRODUCTION

| | |
|--|---|
| Date of first production | Producing method (flowing, pumping, gas lift, etc.) |
| RATE OF PRODUCTION PER 24 HOURS | Oil bbls. Gas MCF Water bbls. Gas-oil ratio CFPB |
| Disposition of gas (vented, used on lease or sold) | Producing interval (s) |

INSTRUCTIONS: As provided in KCC Rule 82-2-125, within 90 days after completion of a well, one completed copy of this Drillers Log shall be transmitted to the State Geological Survey of Kansas, 4150 Monroe Street, Wichita, Kansas 67209. Copies of this form are available from the Conservation Division, State Corporation Commission, 3830 So. Meridian (P.O. Box 17027), Wichita, Kansas 66217. Phone AC 316-522-2206. If confidential custody is desired, please note Rule 82-2-125. Drillers Logs will be on open file in the Oil and Gas Division, State Geological Survey of Kansas, Lawrence, Kansas 66044.

Operator ROBERT G. HALL

DESIGNATE TYPE OF COMP.: OIL, GAS, DRY. HOLE, SWDW, ETC.:

Well No. 1 Lease Name G. Murlin Welch

Dry hole

s 6 T28 R17E^E W

WELL LOG

Show all important zones of porosity and contents thereof; cored intervals, and all drill-stem tests, including depth interval tested, cushion used, time tool open, flowing and shut-in pressures, and recoveries.

SHOW GEOLOGICAL MARKERS, LOGS RUN, OR OTHER DESCRIPTIVE INFORMATION.

| FORMATION DESCRIPTION, CONTENTS, ETC. | TOP | BOTTOM | NAME | DEPTH |
|---------------------------------------|------|--------|------|-------|
| soil | 0 | 2 | | |
| clay | 2 | 18 | | |
| shale | 18 | 38 | | |
| lime | 38 | 42 | | |
| shale | 42 | 144 | | |
| lime | 144 | 164 | | |
| shale | 164 | 245 | | |
| lime | 245 | 354 | | |
| shale | 354 | 358 | | |
| lime | 358 | 362 | | |
| shale | 362 | 392 | | |
| lime | 392 | 458 | | |
| shale | 458 | 484 | | |
| lime | 484 | 491 | | |
| sand | 491 | 498 | | |
| shale | 498 | 508 | | |
| sand | 508 | 523 | | |
| sandy shale | 523 | 537 | | |
| lime | 569 | 579 | | |
| shale | 579 | 582 | | |
| sand | 582 | 593 | | |
| lime | 593 | 597 | | |
| sandy shale | 597 | 672 | | |
| lime | 672 | 675 | | |
| shale | 675 | 678 | | |
| osw. lime | 678 | 707 | | |
| sandy shale | 707 | 733 | | |
| osw. lime | 733 | 751 | | |
| shale | 751 | 755 | | |
| osw. lime | 755 | 763 | | |
| shale | 763 | 1067 | | |
| sand | 1089 | 1108 | | |
| sand water | 1108 | 1120 | | |
| sandy shale | 1120 | 1120 | | |
| Miss. chat | 1169 | 1185 | | |

USE ADDITIONAL SHEETS, IF NECESSARY, TO COMPLETE WELL RECORD.

Date Received

Robert G. Hall

Signature

OWNER

Title

8-26-77

Date