

WICHITA BRANCH
KANSAS DRILLERS LOG

S. 3 T. 16 R. 26W^E_W

Loc. NE SE NW

County Ness

API No. 15 ————— County _____ Number _____

Operator
Donald C. Slawson

Address
200 Douglas Building, Wichita, Kansas 67202

Well No. #1 Lease Name Thornburg 'M'

Footage Location
1450' feet from (N) ~~XX~~line 2250 feet from (W) line

Principal Contractor Slawson Drilling Co., Inc. Geologist George Mueller

Spud Date September 30, 1977 Total Depth 4560' P.B.T.D. 4513

Date Completed October 7, 1977 Oil Purchaser Koch

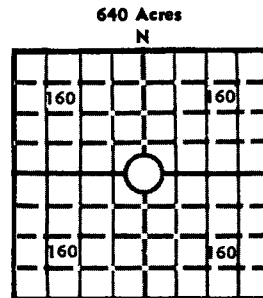

Locate well correctly
Elev.: Gr. 2554

DF 2557 KB 2559

CASING RECORD

Report of all strings set — surface, intermediate, production, etc.

Purpose of string	Size hole drilled	Size casing set (in O.D.)	Weight lbs./ft.	Setting depth	Type cement	Sacks	Type and percent additives
Surface	12 1/4"	8 5/8"	28#	245'	60/40 poz	175 sx	2% gel, 3% cc
Production	7 7/8"	4 1/2"	10/5#	4559'	50/50 poz	150 sx	18% salt, 3/4 of 1% CFR2, 250 gal mud flush, 10# sugar

LINER RECORD

PERFORATION RECORD

Top, ft.	Bottom, ft.	Sacks cement	Shots per ft.	Size & type	Depth interval
			2	golden jets	4472-78

TUBING RECORD

Size	Setting depth	Packer set at
2 3/8"	4458	

ACID, FRACTURE, SHOT, CEMENT SQUEEZE RECORD

Amount and kind of material used	Depth interval treated
500 gal MOD-202	4472-78

INITIAL PRODUCTION

Date of first production October 20	Producing method (flowing, pumping, gas lift, etc.) Swab
RATE OF PRODUCTION PER 24 HOURS Oil 204 bbls.	Gas none MCF
Water nil bbls.	Gas-oil ratio CFPB
Disposition of gas (vented, used on lease or sold)	Producing interval (s) 4472-78

INSTRUCTIONS: As provided in KCC Rule 82-2-125, within 90 days after completion of a well, one completed copy of this Drillers Log shall be transmitted to the State Geological Survey of Kansas, 4150 Monroe Street, Wichita, Kansas 67209. Copies of this form are available from the Conservation Division, State Corporation Commission, 3830 So. Meridian (P.O. Box 17027), Wichita, Kansas 66217. Phone AC 316-522-2206. If confidential custody is desired, please note Rule 82-2-125. Drillers Logs will be on open file in the Oil and Gas Division, State Geological Survey of Kansas, Lawrence, Kansas 66044.

Operator Donald C. Slawson DESIGNATE TYPE OF COMP.: OIL, GAS, DRY HOLE, SWDW, ETC.: oil

Well No. #1 Lease Name Thornburg 'M'

S 3 T 16 R 26 W E W

WELL LOG

Show all important zones of porosity and contents thereof; cored intervals, and all drill-stem tests, including depth interval tested, cushion used, time tool open, flowing and shut-in pressures, and recoveries.

SHOW GEOLOGICAL MARKERS, LOGS RUN, OR OTHER DESCRIPTIVE INFORMATION.

FORMATION DESCRIPTION, CONTENTS, ETC.	TOP	BOTTOM	NAME	DEPTH
0 - 250 Surface hole				
250 - 1815 Shale and shells				
1815 - 1990 Shale				
1990 - 2022 Anhydrite				
2022 - 2475 Shale and Lime				
2475 - 3074 Shale				
3074 - 4390 Shale and Lime				
4390 - 4560 Lime				
4560 RTD				
<p>DST #1 4404-4489 (MISS) 30-45-45-60, F-GB, Rec. 723' TF, 345' HOGCM (60% O, 40% M), 315' MO, 63' OCM (42% M, 38% O, 20% W), IFP 79-223# sli plug, ISIP 1259#, FFP 243-155#, FSIP 1239#</p>			<p>LOG TOPS ANH 1988 (+571) HEEB 3815 (-1256) TORO 3835 (-1276) LANS 3858 (-1299) STK 4100 (-1541) B/KC 4162 (-1603) L/CK 4382 (-1823) MISS 4454 (-1895) LTD 4559 (-2000)</p>	

USE ADDITIONAL SHEETS, IF NECESSARY, TO COMPLETE WELL RECORD.

Date Received

Signature: *R.J. Thatcher*
 Title: *ENG*
 Date: *1/21/78*