

STATE CORPORATION COMMISSION OF KANSAS  
OIL & GAS CONSERVATION DIVISION

WELL COMPLETION OR RECOMPLETION FORM  
ACO-1 WELL HISTORY

DESCRIPTION OF WELL AND LEASE

Operator: license # 6331  
name Taurexco, Inc.  
address 125 N. Market - Suite 1210  
Wichita, KS 67202  
City/State/Zip

Operator Contact Person Thomas C. Hyde  
Phone 316-262-8339

Contractor: license # 5146  
name Rains & Williamson Oil Co., Inc.

Wellsite Geologist Monte Marrs  
Phone 316-262-8339

PURCHASER

Describe Type of Completion  
 New Well  Re-Entry  Workover

Oil  SWD  Temp Abd  
 Gas  Inj  Delayed Comp.  
 Other (Core, Water Supply etc.)

If OWWO: old well info as follows:  
Operator  
Well Name  
Comp. Date Old Total Depth

WELL HISTORY

Drilling Method:  Mud Rotary  Air Rotary  Cable  
4-85 8-1-85 8-1-85  
Spud Date Date Reached TD Completion Date

4281' PBDT  
Total Depth

Amount of Surface Pipe Set and Cemented at 349' feet

Multiple Stage Cementing Collar Used?  Yes  No

If Yes, Show Depth Set feet

If alternate 2 completion, cement circulated  
from feet depth to w/ SX cmt

API NO. 15 135-22,876  
County Ness  
S/2 SW NE Sec. 22 Twp 16S Rge 21

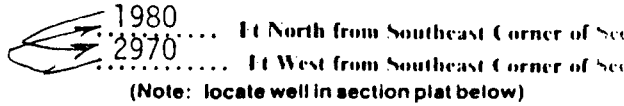

Lease Name Lamer Well# 1

Field Name

Producing Formation

Elevation: Ground 2303 KB 2312

Section Plat

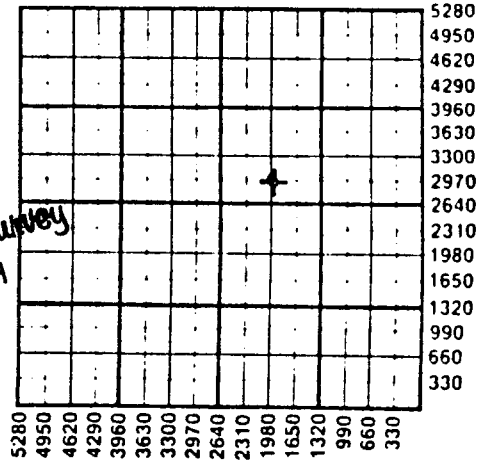

AUG 20 1985  
State Geological Survey  
WICHITA BRANCH

WATER SUPPLY INFORMATION

Source of Water:

Division of Water Resources Permit #

Groundwater (Well) Ft North From Southeast Corner  
Ft West From Southeast Corner  
Sec Twp Rge  East  West

Surface Water (Stream, Pond etc.) Ft North From Southeast Corner  
Ft West From Southeast Corner  
Sec Twp Rge  East  West

Other (explain) (purchased from city, R.W.D.#)

Disposition of Produced Water:  Disposal  Repressuring

Docket #

INSTRUCTIONS: This form shall be completed in duplicate and filed with the Kansas Corporation Commission, 200 Colorado Derby Building, Wichita, Kansas 67202, within 90 days after completion or recompletion of any well. Rules 82-3-130 and 82-3-107 apply.

Information on side two of this form will be held confidential for a period of 12 months if requested in writing and submitted with the form. See rule 82-3-107 for confidentiality in excess of 12 months.

Name Taurexco, Inc. Lease Name Lamer Well# 1 SEC 22 TWP 16S RGE 21

**WELL LOG**

**INSTRUCTIONS:** Show important tops and base of formations penetrated. Detail all cores. Report all drill stem test giving interval tested, time tool open and closed, flowing and shut-in pressures, whether shut-in pressure reached level, hydrostatic pressures, bottom hole temperature, fluid recovery, and flow rates if gas to surface during test. Attach extra sheet if more space is needed. Attach copy of log.

Drill Stem Tests Taken  Yes  No  
 Samples Sent to Geological Survey  Yes  No  
 Cores Taken  Yes  No

Formation Description  
 Log  Sample

DST #1: 4179'-4191'  
 Mis-run.

DST #2: 4222'-4240'  
 Mis-run.

DST #3: 4243'-4281' (Cong. Sand)  
 40" 30" 30" 30"  
 Weak blow build to fair blow  
 Rec. 330' muddy water  
 ifp 75#-108# ffp 140#-155#  
 isip 1205# fsip 1184#  
 ihp 2243#  
 fhp 2210#  
 temp. 118°

DST #4: 4134'-4190' (Cherokee 'A' Sand)  
 30" 30" 30" 30"  
 Weak blow, died in 10" on initial flow  
 2nd open. weak blow died in 10"  
 flushed tool on final flow period - no help.  
 Rec. 65' drilling mud  
 ifp 21# - 21# ffp 43# - 43#  
 isip invalid fsip invalid  
 ihp 2177#  
 fhp 2167#  
 temp. 117°

Plug @ 1630' w/50 sx; plug @ 650' w/50 sx;  
 plug @ 360' w/40 sx; plug @ 40' w/10 sx; 15' sx  
 rathole. (total 165 sx 60/40 Poz. 6% gel)  
 PD 4:00 p.m. 8/1/85 by Halliburton  
 State Plugger Richard Lacey

Name	Top	Bottom
Anhydrite	1588	(+ 72)
Heebner	3693	(-138)
Lansing	3740	(-142)
B/KC	4004	(-159)
Pawnee	4082	(-177)
Ft. Scott	4176	(-186)
Cherokee Sh.	4182	(-187)
Cherokee Sd.	4184	(-187)
Cong. Sd.	4231	(-194)
LTD	4279	(-199)
RTD	4281	(-199)

MISSOURI  
 Geological Survey  
 BRANCH

CASING RECORD <input checked="" type="checkbox"/> New <input type="checkbox"/> used							
Report all strings set - conductor, surface, intermediate, production, etc.							
Purpose of string	size hole drilled	size casing set (in O.D.)	weight lbs/ft.	setting depth	type of cement	# sacks used	type and percent additives
Surface	12 1/4"	8 5/8"	23#	349'	60/40 poz.	200 sx	3% cc

PERFORATION RECORD		Acid, Fracture, Shot, Cement Squeeze Record	
shots per foot	specify footage of each interval perforated	(amount and kind of material used)	Depth