

State Geological Survey  
WICHITA, BRANCH

**KANSAS DRILLERS LOG**

S. 27 T. 16 R. 25 ~~W~~  
W

API No. 15 — 135 — 20,763  
County Number

Loc. C N<sup>1</sup>/<sub>2</sub> NW NW

County Ness

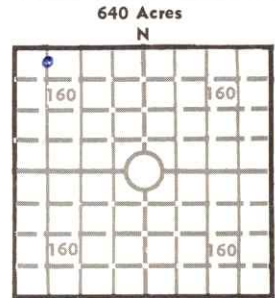

Elev.: Gr. 2549

DF 2551 KB 2554

Operator <b>D N B Drilling, Inc.</b>		
Address <b>701 First National Bank Building, Wichita, Kansas</b>		
Well No. <b>#1</b>	Lease Name <b>Conkright "C"</b>	
Footage Location <b>330' fr N.L. and 660' FWL</b> <small>feet from (N) (S) line                      feet from (E) (W) line</small>		
Principal Contractor <b>D N B Drilling, Inc.</b>	Geologist <b>Robert B. Jinkins</b>	
Spud Date <b>6-4-73</b>	Total Depth <b>4510'</b>	P.B.T.D.
Date Completed <b>6-11-73</b>	Oil Purchaser <b>Clear Creek, Inc.</b>	

**CASING RECORD**

Report of all strings set — surface, intermediate, production, etc.

Purpose of string	Size hole drilled	Size casing set (in O.D.)	Weight lbs/ft.	Setting depth	Type cement	Sacks	Type and percent additives
Surface	12 <sup>1</sup> / <sub>4</sub> "	8-5/8"		310	Regular	200	3% cc
Production	7-7/8"	5-1/2"		4500	Regular	75	

**LINER RECORD**

**PERFORATION RECORD**

Top, ft.	Bottom, ft.	Sacks cement	Shots per ft.	Size & type	Depth interval
<b>TUBING RECORD</b>					
Size <b>2-3/8"</b>	Setting depth <b>4' off btm.</b>	Packer set at <b>None</b>			

**ACID, FRACTURE, SHOT, CEMENT SQUEEZE RECORD**

Amount and kind of material used	Depth interval treated
<b>1000 Gallons regular acid</b>	<b>OH 4500-4510</b>

**INITIAL PRODUCTION**

Date of first production <b>6-25-73</b>	Producing method (flowing, pumping, gas lift, etc.) <b>Pumping</b>			
RATE OF PRODUCTION PER 24 HOURS	Oil <b>75 BO</b> bbls.	Gas <b>MCF</b>	Water <b>NW</b> bbls.	Gas-oil ratio <b>CFPB</b>
Disposition of gas (vented, used on lease or sold)		Producing interval (s) <b>OH 4500-4510</b>		

**INSTRUCTIONS:** As provided in KCC Rule 82-2-125, within 90 days after completion of a well, one completed copy of this Drillers Log shall be transmitted to the State Geological Survey of Kansas, 4150 Monroe Street, Wichita, Kansas 67209. Copies of this form are available from the Conservation Division, State Corporation Commission, 3830 So. Meridian (P.O. Box 17027), Wichita, Kansas 66217. Phone AC 316-522-2206. If confidential custody is desired, please note Rule 82-2-125. Drillers Logs will be on open file in the Oil and Gas Division, State Geological Survey of Kansas, Lawrence, Kansas 66044.

Operator D N B DRILLING, INC.

DESIGNATE TYPE OF COMP.: OIL, GAS, DRY HOLE, SWDW, ETC.:

Well No.

1

Lease Name

Conkright 'C'

Oil

S 27 T 16 R 25 EX W

WELL LOG

Show all important zones of porosity and contents thereof; cored intervals, and all drill-stem tests, including depth interval tested, cushion used, time tool open, flowing and shut-in pressures, and recoveries.

SHOW GEOLOGICAL MARKERS, LOGS RUN, OR OTHER DESCRIPTIVE INFORMATION.

FORMATION DESCRIPTION, CONTENTS, ETC.	TOP	BOTTOM	NAME	DEPTH
Surface Hole	0	310	Sample	Tops
Shale	310	730		
Shale & Sand	730	1308	Anhydrite	1923 +631
Blaine Anhydrite	1308	1320	Heebner	3860 -1306
Red Bed & Sand	1320	1720	Toronto	3878 -1324
Red Bed & Shale	1720	1923	Lansing	3900 -1346
Stone Corral	1923	1954	B/K.C.	4206 -1652
Shale & Shells	1954	2240	Marmaton	4248 -1694
Lime & Shale	2240	4095	Pawnee	4329 -1775
Lime	4095	4430	Ft. Scott	4403 -1849
Lime & Chert	4430	4495	Cherokee Sh	4432 -1878
Lime	4495	4510	T. Mississippi	4497 -1943
			T.D	4510 -1956
<p>DST #1, 4390-4430, 15-30-60-45, Strong blow, rec 1620' GIP and 650' clean oil, 420' muddy oil, 70' HO)GCM. FO 75# - 431# SIP 871# - 769#.</p> <p>DST #2, 3340-4510, 30-30-50-50, weak blow, dies 62". Rec 50' GIP, 50' GIP, 50' clean gassy oil, 30' HO)GCM, 30' M w/tr oil. FP 44#-68#. SIP 809# -898#.</p>				

USE ADDITIONAL SHEETS, IF NECESSARY, TO COMPLETE WELL RECORD.

Date Received

SEP 1973 RECEIVED STATE GEOLOGICAL SURVEY OF KANSAS

James L. Donelson Signature

James L. Donelson, President Title

August 27, 1973 Date