

SIDE ONE

AFFIDAVIT OF COMPLETION FORM

State Geological Survey (KGS) ACO-1
WICHITA BRANCH
12-28-78
4 Jrd

This form shall be filed in duplicate with the Kansas Corporation Commission, 200 Colorado Derby Building, Wichita, Kansas 67202, within ten days after the completion of the well, regardless of how the well was completed.

Attach separate letter of request if the information is to be held confidential. If confidential, only file one copy. Information on side one will be of public record and side two will then be held confidential.

Circle one: Oil Gas, Dry, SWD, OWWO, Injection. Type and complete ALL sections. Applications must be filed for dual completion, commingling, SWD and injection, T.A.

Attach wireline logs (i.e. electrical log, sonic log, gamma ray neutron log, etc.). KCC # (316) 263-3238. (Rules 82-2-105 & 82-2-125)

OPERATOR Katana Resources, Inc.
ADDRESS P.O. Box 483
Bartlesville, OK 74005

API NO. 133-22,029
COUNTY Neosho
FIELD Humboldt-Chanute
PROD. FORMATION Tucker
LEASE Willis
WELL NO. C-14

**CONTACT PERSON Mr. John E. Joseph
PHONE 918-335-0900

PURCHASER Square Deal Oil
ADDRESS P.O. Box 883
Chanute, KS 66720

WELL LOCATION SW SE NW NE
1155 Ft. from North Line and
925 Ft. from East Line of
the SEC. 12 TWP. 28S RGE. 17E

DRILLING CONTRACTOR Circle W Drilling, Inc.
ADDRESS P.O. Box 483
Bartlesville, OK 74005

WELL PLAT

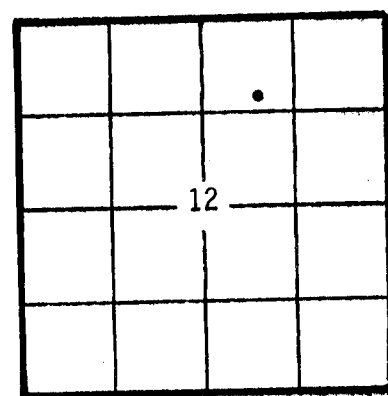

KCC _____
KGS _____
(Office Use)

PLUGGING None
CONTRACTOR ADDRESS _____

TOTAL DEPTH 925' PBTD _____
SPUD DATE 10-02-80 DATE COMPLETED 11-10-80
ELEV: GR 948.5' DF _____ KB _____

DRILLED WITH (CABLE) (ROTARY) (AIR) TOOLS

Amount of surface pipe set and cemented _____ to surface. DV Tool Used? No

A F F I D A V I T

STATE OF Oklahoma, COUNTY OF Washington SS, I, _____

Mr. John E. Joseph OF LAWFUL AGE, BEING FIRST DULY SWORN UPON HIS OATH, DEPOSES THAT HE IS V.P. Exploration & Eng. (FOR)(OF) Katana Resources, Inc. OPERATOR OF THE Willis LEASE, AND IS DULY AUTHORIZED TO MAKE

THIS AFFIDAVIT FOR AND ON THE BEHALF OF SAID OPERATOR, THAT WELL NO. C-14 ON SAID LEASE HAS BEEN COMPLETED AS OF THE 10th DAY OF November, 1980, AND THAT

ALL INFORMATION HEREIN WITH RESPECT TO SAID WELL IS TRUE AND CORRECT.

RECEIVED
STATE CORPORATION

SIDE TWO

WELL LOG

12-28-17E

Show all important zones of porosity and contents thereof; cored intervals, and all drill-stem tests, including depth interval tested, cushion used, time tool open, flowing and shut-in pressures, and recoveries.

SHOW GEOLOGICAL MARKERS, LOGS RUN, OR OTHER DESCRIPTIVE INFORMATION.

FORMATION DESCRIPTION, CONTENTS, ETC.	TOP	BOTTOM	NAME	DEPTH
SHALE & LIME	0	614	FT. SCOTT	
LIME	614	632		
SHALE	632	638		
LIME	638	646	CATTLEMAN	
SHALE	646	786		
SAND	786	794		
SHALE	794	826	TUCKER	
SANDY SHALE	826	875		
SAND	875	895		
SANDY SHALE	895	930		

ACID, FRACTURE, SHOT, CEMENT SQUEEZE RECORD

Amount and kind of material used		Depth interval treated
100 gals 15% MCA mud acid		876'-888'
1200# 10/20 sand		
ISIP 400 psi		
Date of first production	Producing method (flowing, pumping, gas lift, etc.)	Gravity
11-21-80	Pumping	
RATE OF PRODUCTION PER 24 HOURS	Oil	Gas
	6 bbls.	MCF
Disposition of gas (vented, used on lease or sold)	Water	Gas-oil ratio
	%	bbls.
	Perforations	CFPB

Report of all strings set — surface, intermediate, production, etc. CASING RECORD (New) or (Used)

Purpose of string	Size hole drilled	Size casing set (in O.D.)	Weight lbs/ft.	Setting depth	Type cement	Sacks	Type and percent additives
Surface	7-7/8"	7"	20	40'	Class A	20	
Production	6-1/4"	4-1/2"	9.0	923.1'	Class A	93	2% gel, 2% flocc

LINER RECORD

PERFORATION RECORD

Top, ft.	Bottom, ft.	Sacks cement	Shots per ft.	Size & type	Depth interval
			2	3-1/8" HSC	876'-888'

TUBING RECORD		
Size	Setting depth	Packer set at

KANSAS

WELL COMPLETION REPORT AND DRILLER'S LOG

API No. 15 - 133 - 22,029
County Number

State Geological Survey
WICHITA, BRANCH

S. 12 T. 28 R. 17 ^W
Loc. 1155 SNL, 1815 WEL
County Neosho

Operator
Burroughs Petroleum Inc

Address
Box 804 RR 3 Chanute, Ks

Well No. C-14 Lease Name Willis

Footage Location
1155 feet from ^(N) (S) line 1815 feet from ^(E) (W) line

Principal Contractor Circle W Drilling Inc Geologist

Spud Date 10-3-80 Date Completed 11-20-80 Total Depth 925 P.B.T.D.

Directional Deviation Oil and/or Gas Purchaser

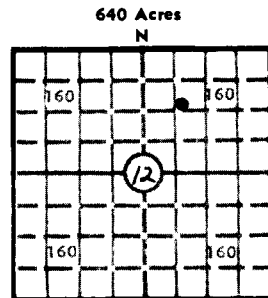

Locate well correctly
Elev.: Gr. _____
DF _____ KB _____

CASING RECORD

Report of all strings set — surface, intermediate, production, etc.

Purpose of string	Size hole drilled	Size casing set (in O.D.)	Weight lbs/ft.	Setting depth	Type cement	Sacks	Type and percent additives
<u>prod. use</u>		<u>4 1/2</u>	<u>9.0</u>	<u>923.1</u>	<u>const.</u>	<u>93</u>	<u>2% gel, 2% FS</u>

LINER RECORD

PERFORATION RECORD

Top, ft.	Bottom, ft.	Sacks cement	Shots per ft.	Size & type	Depth interval
					<u>876-888</u>

Size	Setting depth	Packer set at

ACID, FRACTURE, SHOT, CEMENT SQUEEZE RECORD

Amount and kind of material used	Depth interval treated
<u>100 gals 15% MCA acid</u>	
<u>1200 # 10-20 sand</u>	

INITIAL PRODUCTION

Date of first production <u>11-21-80</u>	Producing method (flowing, pumping, gas lift, etc.) <u>pump</u>
RATE OF PRODUCTION PER 24 HOURS	Oil <u>6</u> bbls. Gas <u>MCF</u> Water <u>bbls.</u> Gas-oil ratio <u>CFPB</u>
Disposition of gas (vented, used on lease or sold)	Producing interval(s) <u>Barberville</u>

INSTRUCTIONS: As provided in KCC Rule 82-2-125, within 90 days after completion of a well, one completed copy of this Drillers Log shall be transmitted to the State Geological Survey of Kansas, 4150 Monroe Street, Wichita, Kansas 67209. Copies of this form are available from the Conservation Division, State Corporation Commission, 245 No. Water, Wichita, Kansas 67202. Phone AC 316-522-2206. If confidential custody is desired, please note Rule 82-2-125. Drillers Logs will be on open file in the Oil and Gas Division, State Geological Survey of Kansas, Lawrence, Kansas 66044.

Operator *Burroughs Petroleum, Inc.* DESIGNATE TYPE OF COMP.: OIL, GAS, DRY HOLE, SWDW, ETC.:

Well No. *C-14* Lease Name *Willis* *oil*

S *12* T *28* R *19* [Ⓢ] W

WELL LOG

Show all important zones of porosity and contents thereof; cored intervals, and all drill-stem tests, including depth interval tested, cushion used, time tool open, flowing and shut-in pressures, and recoveries.

SHOW GEOLOGICAL MARKERS, LOGS RUN, OR OTHER DESCRIPTIVE INFORMATION.

FORMATION DESCRIPTION, CONTENTS, ETC.	TOP	BOTTOM	NAME	DEPTH

USE ADDITIONAL SHEETS, IF NECESSARY, TO COMPLETE WELL RECORD.

Date Received _____

[Signature]

Signature

Geologist

Title

1-26-81

Date

WELL RECORD

12-28-17E P/

WELL No.: C 14 FARM; Willis OPERATOR; Burroughs
 LOCATION; 12 - 28S - 17E
 ELEVATION: _____ STATE: Kansas COUNTY: Neosho
 DRILLING CONTRACTOR: Circle W Drilling Inc. RIG #: 2
 PRODUCTION FORMATION: _____ TOP: _____ BOTTOM: _____
 PERFORATED: _____

TOTAL DEPTH: 925' HOLE SIZE: 6 1/8"

CASING DETAILS: _____

PUMP EQUIPMENT: _____

RODS & PUMP: _____

Thick ness	FORMATION	Depth	Thick ness	FORMATION	Dep
10'	Mud & Clay	10'	9'	Sandstone	321
62'	Shale	72'	15'	Lime	336
3'	Hard Lime	75'	17'	Shale	353
9'	Soft Lime	84'	2'	Lime	355
3'	Sandstone	87'	6'	Shale	371
9'	Soft Lime	96'	2'	Lime	373
2'	Hard Lime	98'	42'	Shale	415
56'	Shale	154'	37'	Lime	452
2'	Lime	156'	12'	Shale	464
5'	Shale	161'	6'	Lime	470
5'	Hard Lime	166'	59'	Gray Shale	529
12'	Soft Lime	178'	5'	Hard Lime	534
15'	Hard Lime	193'	9'	Shale with Lime breaks	543
5'	Soft Lime	198'	30'	Hard Lime	574
9'	Hard Lime	226'	26'	Shale	600
12'	Lime & Sand	238'	5'	Broken Lime	605
2'	Hard Lime	240'	25'	Hard Lime	630
6'	Shale	246'	6'	Shale	636
3'	Coal	249'	7'	Hard Lime	643
6'	Hard Lime	255'		Shale	
4'	Shale	259'			
12'	Lime	271'			
5'	Soft Lime or calamite	276'			
6'	Hard Lime	282'			
8'	Shale	290'			
22'	Broken Lime	312'			