

KANSAS DRILLERS LOG

State Geological Survey
WICHITA BRANCH

S. 33 T. 16 R. 25 ^{EX} W

Loc. C NE SE

County Ness

API No. 15 — 135 — 21,519
County Number

Operator
Gear Petroleum Co., Inc.

Address
300 Sutton Place, Wichita, Kansas 67202

Well No. 1 Lease Name Miner

Footage Location
660 feet from (N) 35 line 660 feet from (E) 30 line

Principal Contractor Slawson Drilling Co. Geologist Benny Singleton

Spud Date 9-30-78 Total Depth 4510 P.B.T.D.

Date Completed 10-8-78 Oil Purchaser Koch Oil Co.

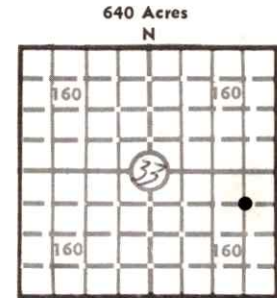

Locate well correctly
Elev.: Gr. 2558

DF KB 2563

CASING RECORD

Report of all strings set — surface, intermediate, production, etc.

Purpose of string	Size hole drilled	Size casing set (in O.D.)	Weight lbs/ft.	Setting depth	Type cement	Sacks	Type and percent additives
Surface	12 1/4"	8 5/8	23	263	60/40 Pozmix	175	2% Gel, 3% CaCl
Production	7 7/8	5 1/2	14	4496	70/30 Pozmix	125	3% Gel

LINER RECORD

PERFORATION RECORD

Top, ft.	Bottom, ft.	Sacks cement	Shots per ft.	Size & type	Depth interval
			None		

Size	Setting depth	Packer set at
2	4490	

ACID, FRACTURE, SHOT, CEMENT SQUEEZE RECORD

Amount and kind of material used	Depth interval treated
2000 gals. MOD 202; 3000 gals MOD 202	4496-4510

INITIAL PRODUCTION

Date of first production <u>1/79</u>		Producing method (flowing, pumping, gas lift, etc.) <u>Pumping</u>			
RATE OF PRODUCTION PER 24 HOURS	Oil <u>20</u> bbls.	Gas <u>None</u> MCF	Water <u>5</u> bbls.	Gas-oil ratio	CFPB
Disposition of gas (vented, used on lease or sold)			Producing interval (s) <u>4496-4510</u>		

INSTRUCTIONS: As provided in KCC Rule 82-2-125, within 90 days after completion of a well, one completed copy of this Drillers Log shall be transmitted to the State Geological Survey of Kansas, 4150 Monroe Street, Wichita, Kansas 67209. Copies of this form are available from the Conservation Division, State Corporation Commission, 3830 So. Meridian (P.O. Box 17027), Wichita, Kansas 66217. Phone AC 316-522-2206. If confidential custody is desired, please note Rule 82-2-125. Drillers Logs will be on open file in the Oil and Gas Division, State Geological Survey of Kansas, Lawrence, Kansas 66044.

Operator Gear Petroleum Co., Inc.		DESIGNATE TYPE OF COMP.: OIL, GAS, DRY HOLE, SWDW, ETC.:
Well No. 1	Lease Name Miner	Oil Well
S 33 T 16 R 25 ^{EX} W		

WELL LOG

Show all important zones of porosity and contents thereof; cored intervals, and all drill-stem tests, including depth interval tested, cushion used, time tool open, flowing and shut-in pressures, and recoveries.

SHOW GEOLOGICAL MARKERS, LOGS RUN, OR OTHER DESCRIPTIVE INFORMATION.

FORMATION DESCRIPTION, CONTENTS, ETC.	TOP	BOTTOM	NAME	DEPTH
DST #1 30-30-60-60", weak blow increasing to strong, 170' GIP, rec. 250' GO, 120' MO, 60' OM, 70' O&WCM, SIP 1109-1066#, FP 65-97#, 154-194#	4471	4510	<u>SAMPLE TOPS</u>	
			Anhydrite	1906 +657
			B/Anhydrite	1937 +626
			Heebner	3857 -1294
			Toronto	3875 -1312
			Lansing	3898 -1335
			3' low to Stutz #1	
			23' low to Stutz #2	
			B/KC	4207 -1644
			Pawnee	4329 -1766
			Ft. Scott	4402 -1839
			Cherokee	4427 -1864
Mississippi	4494 -1931			

USE ADDITIONAL SHEETS, IF NECESSARY, TO COMPLETE WELL RECORD.

Date Received	 _____ Jim Thatcher Signature Engineer
	_____ Title
	_____ Date Oct 3 / 81