



Cawley

FORM 252A-5M-12-28-PETROL

Map No. **KANSAS** Sec. 7 Twp. 33 R. 3E

Well No. 1 - Roberts Farm

~~McNabb et al~~ Company  
Armer et al

990 Ft. from N. Line

\_\_\_\_\_ Ft. from S. Line

330 Ft. from E. Line

\_\_\_\_\_ Ft. from W. Line

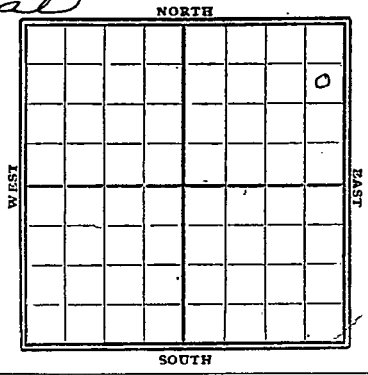

1929

Date	REPORT	O. W. D. D
6/5	Location well	1122 L&S
6/12	Timbers	
6/19	Wdly Rig	
6/26	Wdly rig	
7/2	Spdy.	
7/10	Wdly	650'
7/17	"	1200'
7/24	"	1705'
7/31	"	1910'
8/7	"	2360'
8/14	"	2644'
8/21	"	2790
8/28	"	3156
9/4	Top line	3152'
	dily	3268'
9/11	Top Silc. line	3487-95
	50 bbl oil & 10 bbl water in 12 hrs.	
9/18	Top line	3152'
	" Wilcox	3481'
	Silc line	3487-99 T.D.
	155 bbl oil - shs water	Comp.

over

1935

O. W. D. D

6/19 C. O.

6/26 T 7 3515.

ABANDONED

*Cowley*

Map No. ~~KANSAS~~ Sec. 7 Twp. 33 R. 3 <sup>E</sup>

Well No. 1 *Roberts*

*The Kabb et al* Company

Contractor

**FIRST REPORTS**

**SECTION PLAT**

990 Ft. from N. Line  
 \_\_\_\_\_ Ft. from S. Line  
330 Ft. from E. Line  
 \_\_\_\_\_ Ft. from W. Line

			0

Location  \_\_\_\_\_  
 Rig up \_\_\_\_\_  
 Drilling and Remarks:  
 \_\_\_\_\_  
 \_\_\_\_\_  
 \_\_\_\_\_

**RECORD**

Cased \_\_\_\_\_ in., \_\_\_\_\_ ft.  
 Sand \_\_\_\_\_  
 Gas \_\_\_\_\_  
 Oil \_\_\_\_\_  
 Total Depth \_\_\_\_\_

**PRODUCTION**

1st 24 hrs. Nat. \_\_\_\_\_  
 1st 24 hrs. after shot \_\_\_\_\_  
 Gas \_\_\_\_\_ Cu. Ft.  
 Dry Hole \_\_\_\_\_  
 Abandoned \_\_\_\_\_

Date JUN 5 1929

**CHAS. L. SHERWOOD**  
 Scout

192

*Cowley*  
KANSAS  
Map No. \_\_\_\_\_ Sec. *7* Twp. *33* R. *3<sup>E</sup>*  
Well No. *1 Roberts*  
*The Kalk et al* Company

Contractor

COMPLETE

SECTION PLAT

*990* Ft. from N. Line  
\_\_\_\_\_ Ft. from S. Line  
*330* Ft. from E. Line  
\_\_\_\_\_ Ft. from W. Line

			<i>0</i>

Location \_\_\_\_\_

Rig up \_\_\_\_\_ *Silencers*

Drilling and Remarks:

*Top line 315r-*  
*Top Wilcox 3481'*

*155 lbs.*  
*show water*

RECORD

Cased \_\_\_\_\_ in. \_\_\_\_\_ ft.  
Sand *3487-3499*  
Gas \_\_\_\_\_  
Oil \_\_\_\_\_  
Total Depth *3499'*

PRODUCTION

1st 24 hrs. Nat. \_\_\_\_\_  
1st 24 hrs. after shot \_\_\_\_\_  
Gas \_\_\_\_\_ Cu. Ft.  
Dry Hole \_\_\_\_\_  
Abandoned \_\_\_\_\_

Date

SEP 18 1929

192 **CHAS. L. SHERWOOD**  
Scout

KANSAS

Map No. 1 Sec. 7 Twp. 33 R. 3E

Well No. 1 - Roberts

Armer et al (McKinnitt) company

Contractor

FIRST REPORTS

SECTION PLAT

990 Ft. from N. Line

..... Ft. from S. Line

330 Ft. from E. Line

..... Ft. from W. Line

			0

C.O.P.D.

RECORD

Location.....

Rig up.....

Drilling and Remarks:

OTU 3499

C.O.

Cased..... in., ..... ft.

Sand.....

Gas.....

Oil.....

Total Depth.....

PRODUCTION

1st 24 hrs. Nat.....

1st 24 hrs. after shot.....

Gas..... Cu. Ft.

Dry Hole.....

Abandoned.....

Date

6-19-35

192.....

**ORVAL MANSCHKE**

Scout

KANSAS

Map No. 1 J Sec. 7 Twp. 33 R. 3E

Well No. 1 Roberts

M. B. Ammer & Co. Company

Contractor

SECTION PLAT

990 Ft. from N. Line

..... Ft. from S. Line

230 Ft. from E. Line

..... Ft. from W. Line

			<u>2</u>

ABANDONED

Location.....

Rig up.....

Drilling and Remarks:

RECORD

Cased..... in., ..... ft.

Sand.....

Gas.....

Oil.....

Total Depth 357.5

PRODUCTION

1st 24 hrs. Nat.....

1st 24 hrs. after shot.....

Gas..... Cu. Ft.

Dry Hole.....

Abandoned.....

Date

6/26/35 192.....

ORVAL MANNSCHRECK

Scr