

KANSAS Geological Survey
WICHITA, BRANCH

API No. 15 — 135 — 20,933
 County Number

S. 11 T. 16 R. 26 ^E _W

Loc. C SW SWNW

County Ness

Operator
Mull Drilling Co.

Address 415 Page Court Wichita, Kansas 67202

Well No. #2 Lease Name Snyder

Footage Location
2310 feet from (N) 15 line 330 feet from 15 (W) line

Principal Contractor Rains & Williamson Geologist Benny Singleton

Spud Date October 15, 1974 Total Depth 4538 P.B.T.D.

Date Completed October 24, 1974 Oil Purchaser Permian

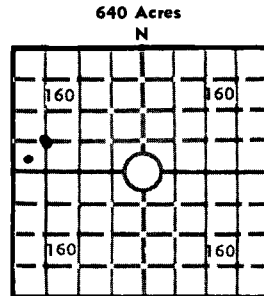

Locate well correctly
 Elev.: Gr. 2608

DF _____ KB 2613

CASING RECORD

Report of all strings set — surface, intermediate, production, etc.

Purpose of string	Size hole drilled	Size casing set (in O.D.)	Weight lbs/ft.	Setting depth	Type cement	Sacks	Type and percent additives
Surface	12-1/4"	8-5/8"	24#	247	Common	175	2% gel, 3% CC
Production	7-7/8"	4-1/2"	10.5#	4524	60-40 pozmix	100	Salt saturated

LINER RECORD

PERFORATION RECORD

Top, ft.	Bottom, ft.	Sacks cement	Shots per ft.	Size & type	Depth interval

Size	Setting depth	Packer set at	Open Hole	4524-38
2-3/8	4534	---		

ACID, FRACTURE, SHOT, CEMENT SQUEEZE RECORD

Amount and kind of material used	Depth interval treated
None	

INITIAL PRODUCTION

Date of first production <u>12/1/74</u>	Producing method (flowing, pumping, gas lift, etc.) <u>2 x 1 1/2 x 14' BHD insert pump</u>
RATE OF PRODUCTION PER 24 HOURS Oil <u>70</u> Gas <u>-0-</u> Water <u>-0-</u> Gas-oil ratio <u>-0-</u>	Producing interval (s) <u>4524-38 (Open Hole)</u>
Disposition of gas (vented, used on lease or sold) <u>None</u>	

INSTRUCTIONS: As provided in KCC Rule 82-2-125, within 90 days after completion of a well, one completed copy of this Drillers Log shall be transmitted to the State Geological Survey of Kansas, 4150 Monroe Street, Wichita, Kansas 67209. Copies of this form are available from the Conservation Division, State Corporation Commission, 3830 So. Meridian (P.O. Box 17027), Wichita, Kansas 66217. Phone AC 316-522-2206. If confidential custody is desired, please note Rule 82-2-125. Drillers Logs will be on open file in the Oil and Gas Division, State Geological Survey of Kansas, Lawrence, Kansas 66044.

Operator Mull Drilling Company, INC. DESIGNATE TYPE OF COMP.: OIL, GAS, DRY HOLE, SWDW, ETC.: Oil

Well No. 2 Lease Name Snyder

S 11 T 16 R 26 ~~W~~ W

WELL LOG

Show all important zones of porosity and contents thereof; cored intervals, and all drill-stem tests, including depth interval tested, cushion used, time tool open, flowing and shut-in pressures, and recoveries. SHOW GEOLOGICAL MARKERS, LOGS RUN, OR OTHER DESCRIPTIVE INFORMATION.

FORMATION DESCRIPTION, CONTENTS, ETC.	TOP	BOTTOM	NAME	DEPTH
<p>DST #1 4496-4538 (Miss)</p> <p>TO 90", recovered 120' GIP, 180 GO and 540' GCMO. IFP 69-219/30" FFP 230-323/60" ISIP 1097/45" FSIP 1097/60"</p>			Sample Tops:	
			Anhydrite	2032
			Heebner	3881
			Lansing	3923
			BKC	4225
			Pawnee	4363
			Ft. Scott	4427
			Cherokee	4456
		Miss	4521	
		RTD	4538	

USE ADDITIONAL SHEETS, IF NECESSARY, TO COMPLETE WELL RECORD.

Date Received	<i>Dan Range</i>	Signature
	<i>Engineer</i>	Title
	<i>6/16/75</i>	Date