

Gift of
W. L. Stryker Estate
State Geological Survey of Kansas
1970

36-32-4E
Pl

GEOLOGICAL DEPARTMENT
SOUTHWESTERN GAS COMPANY
INDEPENDENCE, KANSAS

LOG OF WELL

Company Empire Oil & Refrig. Farm Hedges Well No. 2
 State Kansas County Cowley S. 36 T. 32 R. 4
 Commenced Drilling 7-8-19 Completed 8-5-1919 Elev. 1205
 Shot _____ Qts. from _____ to _____ I. P. _____ R. P. _____
 Casing: 560' 10" Casing: 925' 8" Casing: 1405' 6-5/8"
 Casing: _____ Casing: _____ Casing: _____
 Tubing _____ Caged at _____ Packer at _____
 Contractor _____

lime	125	slate	615
mud	135	lime	630
red rock	140	slate	640
lime	155	slate sand	650
slate	165	slate	660
lime	170	sand	670 gas
mud	180	slate	700
mud pink	185	lime	710
lime	230	slate	800
red rock	245	lime	805
lime	255	slate	830
slate	260	sand	850
lime	285	sand	870 water
slate	305	slate	880
red rock	310	slate	885
slate	320	lime	890
lime	330	slate	925
slate	340	lime	930
lime	350	slate	965
slate	355	slate	1010
red rock	375	lime	1015
slate	390	shale	1050
red rock	410	lime	1055
slate	415	shale	1100
lime	435	lime	1140
slate	455	slate	1145
lime	475	lime	1150
slate	480	slate	1160
red rock	485	lime	1165
lime	520	slate	1315
slate	540	lime	1320
lime	560	slate	1355
slate	570	red rock	1360
lime	575	shale	1395
slate	580	lime broken	1450
lime	590	shale	1455

002483

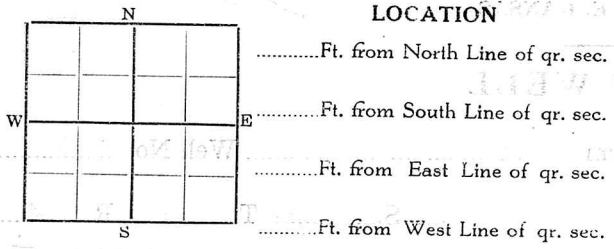

36-32-4E
 page 2

shale sandy 1460
 sand 1464 oil

TEST

Through	Pitot Tube Test of 192			Open Gauge Test Shows Lbs.
In. Tubing	Used	Mercury	Water	
	Reading			
In. Casing	Vol. Cu. Ft.			

FRANK HEDGES # 2 36-32-4
 E.G.&F.CO. Cowley Co. Kans.

Drilling commenced 7/8/19
 Drilling completed 8/5/19

20808

Casing record
 15 1/2 22
 12 1/2 146
 10 561 pulled
 8 1/4 938 14"
 6 5/8 1416
 2" tubing 1429
 5/8 rods 1425

20

Initial Production 24 bbls. 24 hrs.
 Elevation 1238/46

lime	white	hard	0	125
mud	blue	soft	125	135
rock	red	soft	135	140
lime	white	hard	140	155
shale	blue	soft	155	165
lime	blue	soft	165	170
mud	blue	soft	170	180
mud	pink	soft	180	185
lime	white	hard	185	230
rock	red	soft	230	245
lime	white	hard	245	255
slate	blue	soft	255	260
lime	white	hard	260	285
slate	blue	soft	285	305
rock	red	soft	305	310
slate	blue	soft	310	320
lime	white	hard	320	330
slate	blue	soft	350	355
rock	red	soft	355	365
slate	blue	soft	375	390
rock	red	soft	390	410
slate	blue	soft	410	415
lime	white	hard	415	435
slate	blue	soft	435	455
lime	white	hard	455	475
slate	blue	soft	475	480
rock	red	soft	480	485
lime	white	hard	485	520
slate	blue	soft	520	550
lime	white	hard	550	560
slate	blue	soft	560	575
lime	white	hard	570	575
slate	blue	soft	575	580
lime	white	hard	580	590
slate	blue	soft	590	615
lime	white	hard	615	630
slate	blue	soft	630	640
sand	gas	sift	640	650
slate	blue	soft	650	660
sand	gas	soft	660	670
slate	blue	dogy	670	700
lime	white	hard	700	710
slate	blue	soft	710	800
lime	white	hard	800	805
slate	blue	soft	805	830
sand	water	soft	830	870
slate	blue	soft	870	885
lime	white	hard	885	890
slate	blue	soft	890	925
lime	white	hard	925	930
slate	blue	soft	930	985
shale	blue	soft	985	1010

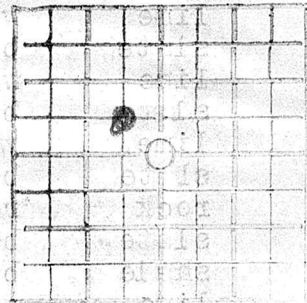

10 hrs. H2O

Boys cannot locate the well.

HPW

