

IMPORTANT
Kans. Geo. Survey request
samples on this well.

KANSAS

**WELL COMPLETION REPORT AND
DRILLER'S LOG**

State Geological Survey
WICHITA, BRANCH

S. 14 T. 28 R. 18 ^N _W E
Loc. NW NW NW
County Neosho

API No. 15 — 133 — 22,356
County Number

Operator
G. D. Vaughn

Address
1012 North 9th Lamesa, Texas 79331

Well No. #1 Lease Name Triple "C"

Footage Location
165 feet from (N) ~~line~~ 2440 feet from (E) ~~line~~

Principal Contractor CHASE DRILLING CO. Geologist

Spud Date 2-22-81 Date Completed 3-31-81 Total Depth 765 ft P.B.T.D.

Directional Deviation Oil and/or Gas Purchaser

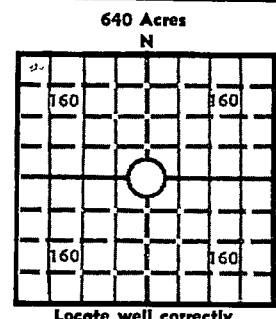

Elev.: Gr. _____
DF _____ KB _____

CASING RECORD

Report of all strings set — surface, intermediate, production, etc.

Purpose of string	Size hole drilled	Size casing set (in O.D.)	Weight lbs/ft.	Setting depth	Type cement	Sacks	Type and percent additives
surface		75' casing		75 ftn	Portland		
8 - 765		2 7/8		760 ft	Portland		

LINER RECORD

PERFORATION RECORD

Top, ft.	Bottom, ft.	Sacks cement	Shots per ft.	Size & type	Depth interval
0 - 760	760		2	2 1/8 alum	750-754

Size	Setting depth	Packer set at
2 7/8	760	

ACID, FRACTURE, SHOT, CEMENT SQUEEZE RECORD

Amount and kind of material used	Depth interval treated
Frac-20sacks : 120 barrels of fluid	750-754

INITIAL PRODUCTION

Date of first production <u>none</u>		Producing method (flowing, pumping, gas lift, etc.)			
RATE OF PRODUCTION PER 24 HOURS	Oil bbls.	Gas MCF	Water bbls.	Gas-oil ratio	CFPB
Disposition of gas (vented, used on lease or sold)			Producing interval (s)		

INSTRUCTIONS: As provided in KCC Rule 82-2-125, within 90 days after completion of a well, one completed copy of this Drillers Log shall be transmitted to the State Geological Survey of Kansas, 4150 Monroe Street, Wichita, Kansas 67209. Copies of this form are available from the Conservation Division, State Corporation Commission, 245 No. Water, Wichita, Kansas 67202. Phone AC 316-522-2206. If confidential custody is desired, please note Rule 82-2-125. Drillers Logs will be on an open file in the Oil and Gas Division, State Geological Survey of Kansas, Lawrence, Kansas 66044.

Operator **G.D. Vaughn** DESIGNATE TYPE OF COMP.: OIL, GAS, DRY HOLE, SWDW, ETC.: **Oil**

Well No. **1** Lease Name **THIPLE "E"**

S14 T28 R18 E

WELL LOG

Show all important zones of porosity and contents thereof; cored intervals, and all drill-stem tests, including depth interval tested, cushion used, time tool open, flowing and shut-in pressures, and recoveries.

SHOW GEOLOGICAL MARKERS, LOGS RUN, OR OTHER DESCRIPTIVE INFORMATION.

FORMATION DESCRIPTION, CONTENTS, ETC.	TOP	BOTTOM	NAME	DEPTH
0- Cl-Sh	0	22		
Ls	22	100		
Sh	100	106		
Ls	106	111		
sh -ls	111	141		
Ls	141	168		
Sh	168	176		
Ls	176	192		
Sh (hard) - Coal	192	197		
Ls (hard)	197	271		
Sh-Coal	271	280		
Ls	280	282		
Sh-(black)	282	320		
Sh-Ls(320	354		
Ls	354	361		
Sa	361	439		
Ls	439	444		
Sh-Ls	444	453		
Ls	453	483		
Sh	483	506		
Sh	506	527		
Coal-Ls	527	530		
Ls-Sh	530	550		
Ls-Sh	550	605		
Ls-Sh	605	637		
OK Ls	637	669		
Sh	669	695		
sa-(trace)	695	701		
Sa-coal	701	705		
Sa stringers-Sh	705	716		
Sh,Sa-Coal	716	725		
Sh-Ls, stringers	725	749		
Sa,Sh-stringers	749	760		
		<i>Dry</i>		

USE ADDITIONAL SHEETS, IF NECESSARY, TO COMPLETE WELL RECORD.

Date Received	Signature
	Title
	Date