

State Geological Survey

WICHITA, BRANCH

KANSAS DRILLERS LOG

IMPORTANT
Kans. Geo. Survey request samples on this well.

API No. 15 — 133 — 20,491
County Number

S. 20 T. 28 R. 18 ^E_W
Loc. 700' FNL & 510' FWL NW
County Neosho

Operator
Rock Oil, Inc.

Address
Box 556 Chabute 66720

Well No. #3 Lease Name George Converse

Footage Location
700 feet from (N) (S) line 510 feet from (E) (W) line

Principal Contractor Osage Drilling, Inc. Geologist _____

Spud Date Jan. 24, 1975 Total Depth 840' P.B.T.D. _____

Date Completed April 26, 1975 Oil Purchaser Mid-America Refining Co., Inc.

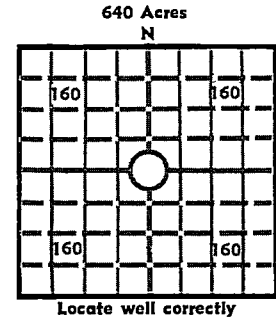

Elev.: Gr. _____
DF _____ KB _____

CASING RECORD

Report of all strings set — surface, intermediate, production, etc.

Purpose of string	Size hole drilled	Size casing set (in O.D.)	Weight lbs/ft.	Setting depth	Type cement	Sacks	Type and percent additives
Surface	5 7/8"	6 1/4"		30'			
Oil String		2 1/2"		826'	Portland Bulk	127	

LINER RECORD

PERFORATION RECORD

Top, ft.	Bottom, ft.	Sacks cement	Shots per ft.	Size & type	Depth interval
None			Total 15 holes	1 11/16 Glass Jets	766 - 780'

Size	Setting depth	Packer set at

ACID, FRACTURE, SHOT, CEMENT SQUEEZE RECORD

Amount and kind of material used	Depth interval treated
1 Drum Acid - 3900 Lbs. Sand	766 - 780'

INITIAL PRODUCTION

Date of first production May 1975 Producing method (flowing, pumping, gas lift, etc.) Pumping

RATE OF PRODUCTION PER 24 HOURS	Oil	Gas	Water	Gas-oil ratio
	<u>3</u> bbls.			

Disposition of gas (vented, used on lease or sold) _____ Producing interval (s) _____

INSTRUCTIONS: As provided in KCC Rule 82-2-125, within 90 days after completion of a well, one completed copy of this Drillers Log shall be transmitted to the State Geological Survey of Kansas, 4150 Monroe Street, Wichita, Kansas 67209. Copies of this form are available from the Conservation Division, State Corporation Commission, 3830 So. Meridian (P.O. Box 17027), Wichita, Kansas 66217. Phone AC 316-522-2206. If confidential custody is desired, please note Rule 82-2-125. Drillers Logs will be on open file in the Oil and Gas Division, State Geological Survey of Kansas, Lawrence, Kansas 66044.

