

HUMBOLDT-CHANUTE

# WELL COMPLETION REPORT AND DRILLER'S LOG

## KANSAS State Geological Survey WICHITA BRANCH

S. 22 T. 28S R. 13 **E** W

Loc. CHANUTE

County NEOSHO

API No. 15 — NEOSHO County — 133-22.723 Number

Operator RATTLER RESOURCES, INC.

Address P.O. BOX C CHANUTE, KANSAS 66720

Well No. D10 Lease Name TUCKER

Footage Location 1225.8 feet from (N) (S) line 1283.5 feet from (E) (W) line

Principal Contractor SAME AS ABOVE Geologist

Spud Date 04-06-81 Date Completed 04-09-81 Total Depth 1100 P.S.T.D. 1088

Directional Deviation N/A Oil and/or Gas Purchaser SQUARE DEAL

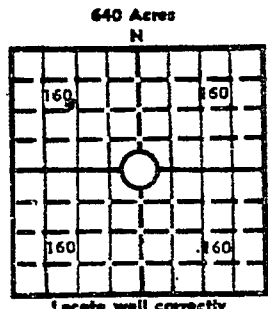

Elev.: Gr. 1100 5  
DF KB

### CASING RECORD

Report of all strings set — surface, intermediate, production, etc.

Purpose of string	Size hole drilled	Size casing set (in O.D.)	Weight lbs/ft.	Setting depth	Type cement	Sacks	Type and percent additives
SURFACE	9 5/8"	7"	20#	40	CLASS "A"	20	
PRODUCTION	6 1/4"	4 1/2"	8.9#.	1088	CLASS "A"	100	2% GEL

### LINER RECORD

### PERFORATION RECORD

Top, ft.	Bottom, ft.	Sacks cement	Shots per ft.	Size & type	Depth interval
			3 spf	3/8" jet /	1084-1090
			3 spf	3/8" jet	816-818
			3 spf	3/8" jet	809-812
			3 spf	3/8" jet	780-782
			3 spf	3/8" jet	633-642

### TUBING RECORD

Size	Setting depth	Packer set at

### ACID, FRACTURE, SHOT, CEMENT SQUEEZE RECORD

Amount and kind of material used	Depth interval treated
<u>WILDCAT</u>	

### INITIAL PRODUCTION

Date of first production <u>04-24-81</u>	Producing method (flowing, pumping, gas lift, etc.) <u>PUMPING</u>
RATE OF PRODUCTION PER 24 HOURS	Oil <u>1</u> bbls. Gas <u>TRACE</u> MCF Water <u>10</u> bbls. Gas-oil ratio <u>CFPB</u>
Disposition of gas (vented, used on lease or sold) <u>VENTED</u>	Producing interval (s) <u>ALL</u>

INSTRUCTIONS: As provided in KCC Rule 82-2-125, within 90 days after completion of a well, one completed copy of this Drillers Log shall be transmitted to the State Geological Survey of Kansas, 4150 Monroe Street, Wichita, Kansas 67209. Copies of this form are available from the Conservation Division, State Corporation Commission, 245 No. Water, Wichita, Kansas 67202. Phone AC 316-522-2206. If confidential custody is desired, please note Rule 82-2-125. Drillers Logs will be on open file in the Oil and Gas Division, State Geological Survey of Kansas, Lawrence, Kansas 66044.



# WELL RECORD

22-28-18E

WELL No.: D-10 FARM; Tucker OPERATOR; Rattler  
 LOCATION; 22-28S-18E  
 ELEVATION: \_\_\_\_\_ STATE: Kansas COUNTY: Neosho  
 DRILLING CONTRACTOR: Circle W Drilling, Inc. RIG #: 2  
 PRODUCTION FORMATION: \_\_\_\_\_ TOP: \_\_\_\_\_ BOTTOM: \_\_\_\_\_  
 PERFORATED: \_\_\_\_\_

TOTAL DEPTH: \_\_\_\_\_ HOLE SIZE: 6 1/4"

CASING DETAILS: Set 40' of 7" 20# surface casing

PUMP EQUIPMENT: \_\_\_\_\_

RODS & PUMP: \_\_\_\_\_

Thick ness	FORMATION	Depth	Thick ness	FORMATION	Depth
2'	SOIL	2'	20	SHALE	594
14	CLAY & GRAVEL	16	3	LIME	597
1	LIME	17	15	SHALE	612
2	SHALE	19	20	LIME	622
3	LIME	22	10	COAL	632
30	SHALE	52	5	LIME	637
4	LIME	56	4	COAL & SHALE	641
23	SHALE	79	5	SANDY SHALE	646
4	LIME	83	8	SAND	654
16	SAND	99	90	SHALE	744
3	LIME	102	4	LIME	748
15	SHALE	117	85	SHALE	833
61	LIME	178	15	SANDY SHALE	848
45	COAL AND SHALE	228	20	SHALE	868
25	LIME	248	45	SAND AND SHALE	913
6	SHALE	254	140	SHALE	1053
16	LIME	270	47	LIME	1100
12	SHALE	282			T.D.
15	LIME	297			
5	SANDSTONE	302			
40	LIME	342			
34	SHALE	426			
20	LIME	446			
81	SHALE	527			
47	LIME	574			