

KANSAS State Geological Survey  
WICHITA, BRANCH

WELL COMPLETION REPORT AND  
DRILLER'S LOG

S. 24 T. 28S R. 18 E  
Loc. S155N616SW1E LN W4  
County Neosho

API No. 15 - 133 - 21,589  
County Number

Operator  
Vera Cruz Petroleum Company Inc.

Address  
S. 6312 Helena, Spokane, WA 99203

Well No. T-1 Lease Name Chexney

Footage Location  
515 feet from (N) ST line 145 feet from (E) (W) line

Principal Contractor A.S.M. Geologist

Spud Date 5-14-80 Date Completed 5-16-80 Total Depth 749.6' P.B.T.D.

Directional Deviation Oil and/or Gas Purchaser Square Deal

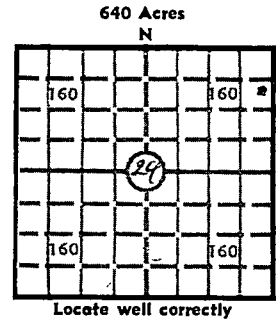

Elev.: Gr. \_\_\_\_\_  
DF \_\_\_\_\_ KB \_\_\_\_\_

CASING RECORD

Report of all strings set — surface, intermediate, production, etc.

Purpose of string	Size hole drilled	Size casing set (in O.D.)	Weight lbs/ft.	Setting depth	Type cement	Sacks	Type and percent additives
Surface	8"	6"	15	60	Port.	15	1% C
Casing	5"	2 7/8"	6 1/2	749	"	95	"

LINER RECORD

PERFORATION RECORD

Top, ft.	Bottom, ft.	Sacks cement	Shots per ft.	Size & type	Depth interval

TUBING RECORD		
Size	Setting depth	Packer set at
1"	715	

ACID, FRACTURE, SHOT, CEMENT SQUEEZE RECORD

Amount and kind of material used	Depth interval treated
Water & sand	722-738

INITIAL PRODUCTION

Date of first production <u>6-20-80</u>	Producing method (flowing, pumping, gas lift, etc.) <u>Pump</u>
RATE OF PRODUCTION PER 24 HOURS	Oil <u>1</u> bbls. Gas <u>—</u> MCF Water <u>8</u> bbls. Gas-oil ratio _____ CFPB
Disposition of gas ( <u>vented</u> ) used on lease or sold	Producing interval (s) <u>722-738</u>

INSTRUCTIONS: As provided in KCC Rule 82-2-125, within 90 days after completion of a well, one completed copy of this Drillers Log shall be transmitted to the State Geological Survey of Kansas, 4150 Monroe Street, Wichita, Kansas 67209. Copies of this form are available from the Conservation Division, State Corporation Commission, 245 No. Water, Wichita, Kansas 67202. Phone AC 316-522-2206. If confidential custody is desired, please note Rule 82-2-125. Drillers Logs will be on open file in the Oil and Gas Division, State Geological Survey of Kansas, Lawrence, Kansas 66044.

Operator Uera Cruz DESIGNATE TYPE OF COMP.: OIL, GAS, DRY HOLE, SWDW, ETC.: oil

Well No. 7-1 Lease Name Cheyney

S 24 T 28 S R 18 E

**WELL LOG**

Show all important zones of porosity and contents thereof; cored intervals, and all drill-stem tests, including depth interval tested, cushion used, time tool open, flowing and shut-in pressures, and recoveries.

SHOW GEOLOGICAL MARKERS, LOGS RUN, OR OTHER DESCRIPTIVE INFORMATION.

FORMATION DESCRIPTION, CONTENTS, ETC.	TOP	BOTTOM	NAME	DEPTH
Shale + lime	0	722		
Oil sand	722	738	Bartlesville	
Shale	738	TD		

USE ADDITIONAL SHEETS, IF NECESSARY, TO COMPLETE WELL RECORD.

Date Received \_\_\_\_\_  
Signature G. Moore  
Title Sec.  
Date 6-30-80