

WELL COMPLETION REPORT AND DRILLER'S LOG

API No. 15 — 133 — 21,743
County Number

State Geological Survey
 WICHITA BRANCH

S. 24 T. 28 R. 15
 Loc. 225 NSL 1654 EL. NE 4
 County Neosho

Operator Uera Cruz Petroleum
 Address 6312 S. Helena, Spokane WA.
 Well No. t-5 Lease Name Cheyney
 Footage Location
825 feet from (S) line 165 feet from (E) (W) line
 Principal Contractor AS M Drilling Geologist _____
 Spud Date 7-8 Date Completed 7-9 Total Depth 780 P.B.T.D. _____
 Directional Deviation _____ Oil and/or Gas Purchaser Sq. Deal

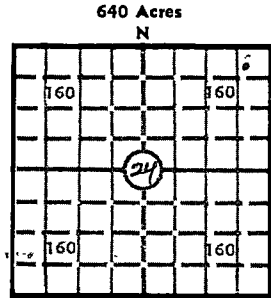

Locate well correctly
 Elev.: Gr. _____
 DF _____ KB _____

CASING RECORD

Report of all strings set — surface, intermediate, production, etc.

Purpose of string	Size hole drilled	Size casing set (in O.D.)	Weight lbs/ft.	Setting depth	Type cement	Sacks	Type and percent additives
CASING	5 1/2	2 7/8	4.5		PORT	80	1% cal. l.
SURFACE	8"	6	15	60	"	15	1% cal. l.

LINER RECORD

PERFORATION RECORD

Top, ft.	Bottom, ft.	Sacks cement	Shots per ft.	Size & type	Depth interval

TUBING RECORD		
Size	Setting depth	Packer set at
1 1/2	720	

ACID, FRACTURE, SHOT, CEMENT SQUEEZE RECORD

Amount and kind of material used	Depth interval treated
Water + Sand — 10,000#	732-746

INITIAL PRODUCTION

Date of first production 7-30-80 Producing method (flowing, pumping, gas lift, etc.) Pump

RATE OF PRODUCTION PER 24 HOURS	Oil	Gas	Water	Gas-oil ratio
	<u>1 1/2</u> bbls.	<u>—</u> MCF	<u>6</u> bbls.	

Disposition of gas (vented) used on lease or sold _____ Producing interval (s) 732-746

INSTRUCTIONS: As provided in KCC Rule 82-2-125, within 90 days after completion of a well, one completed copy of this Drillers Log shall be transmitted to the State Geological Survey of Kansas, 4150 Monroe Street, Wichita, Kansas 67209. Copies of this form are available from the Conservation Division, State Corporation Commission, 245 No. Water, Wichita, Kansas 67202. Phone AC 316-522-2206. If confidential custody is desired, please note Rule 82-2-125. Drillers Logs will be on open file in the Oil and Gas Division, State Geological Survey of Kansas, Lawrence, Kansas 66044.

Operator <i>Ueva Cruz</i>		DESIGNATE TYPE OF COMP.: OIL, GAS, DRY HOLE, SWDW, ETC.: <i>oil</i>
Well No. <i>T-5</i>	Lease Name <i>Cheway</i>	
S <i>24</i> T <i>283</i> R <i>18</i> E <i>1/2</i>		

WELL LOG

Show all important zones of porosity and contents thereof; cored intervals, and all drill-stem tests, including depth interval tested, cushion used, time tool open, flowing and shut-in pressures, and recoveries.

SHOW GEOLOGICAL MARKERS, LOGS RUN, OR OTHER DESCRIPTIVE INFORMATION.

FORMATION DESCRIPTION, CONTENTS, ETC.	TOP	BOTTOM	NAME	DEPTH
<i>Shale + Lime</i>	<i>0</i>	<i>732</i>		
<i>oil sand</i>	<i>732</i>	<i>746</i>	<i>Battosville</i>	
<i>Shale</i>	<i>746</i>	<i>TD</i>		

USE ADDITIONAL SHEETS, IF NECESSARY, TO COMPLETE WELL RECORD.

Date Received	<i>G. Throop</i>
	Signature
	<i>Sec.</i>
	Title
	<i>8-10-80</i>
	Date