

KANSAS

State Geological Survey
WICHITA, BRANCH
 S. 24 T. 28 R. 18 E
 W
 Loc. NW SE SE NE
 County Neosho

WELL COMPLETION REPORT AND DRILLER'S LOG

API No. 15 — 133 — 21,613
 County Number

Operator
Vera Cruz Petroleum Co.

Address
118 S. Garfield Chanute, Kansas 66720

Well No. #T-2 Lease Name Cheyney

Footage Location
495 feet from (N) (S) line 495 feet from (E) (W) line

Principal Contractor AS M Drill Geologist

Spud Date 5-27-80 Date Completed 5-29-80 Total Depth 740 P.B.T.D.

Directional Deviation Oil and/or Gas Purchaser Sq Deal

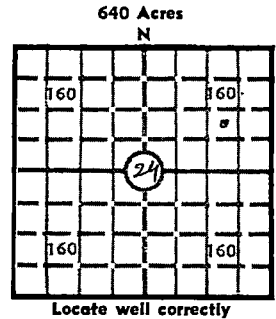

Elev.: Gr. _____
 DF _____ KB _____

CASING RECORD

Report of all strings set — surface, intermediate, production, etc.

Purpose of string	Size hole drilled	Size casing set (in O.D.)	Weight lbs/ft.	Setting depth	Type cement	Sacks	Type and percent additives
Surf	6"	6	15	60	PORT	15	1% cal
Casing	5"	2 3/8	6	700	PORT	85	"

LINER RECORD

PERFORATION RECORD

Top, ft.	Bottom, ft.	Sacks cement	Shots per ft.	Size & type	Depth interval

Size	Setting depth	Packer set at			
1"	730		3	2 1/8 glass	722-736.5

ACID, FRACTURE, SHOT, CEMENT SQUEEZE RECORD

Amount and kind of material used	Depth interval treated
water & sand - 10,000 #	722-736.5

INITIAL PRODUCTION

Date of first production <u>6-15-80</u>	Producing method (flowing, pumping, gas lift, etc.) <u>Pump</u>
RATE OF PRODUCTION PER 24 HOURS	Oil <u>1/2</u> bbls. Gas <u>—</u> MCF Water <u>5</u> bbls. Gas-oil ratio _____ CFPB
Disposition of gas (<u>vented</u> , used on lease or sold)	Producing interval (s) <u>722-736.5</u>

INSTRUCTIONS: As provided in KCC Rule 82-2-125, within 90 days after completion of a well, one completed copy of this Drillers Log shall be transmitted to the State Geological Survey of Kansas, 4150 Monroe Street, Wichita, Kansas 67209. Copies of this form are available from the Conservation Division, State Corporation Commission, 245 No. Water, Wichita, Kansas 67202. Phone AC 316-522-2206. If confidential custody is desired, please note Rule 82-2-125. Drillers Logs will be on open file in the Oil and Gas Division, State Geological Survey of Kansas, Lawrence, Kansas 66044.

Operator U-ora Cruz DESIGNATE TYPE OF COMP.: OIL, GAS, DRY HOLE, SWDW, ETC.: Oil

Well No. T-2 Lease Name Cherkey

S 24 T 28S R 18 E W

WELL LOG
 Show all important zones of porosity and contents thereof; cored intervals, and all drill-stem tests, including depth interval tested, cushion used, time tool open, flowing and shut-in pressures, and recoveries. **SHOW GEOLOGICAL MARKERS, LOGS RUN, OR OTHER DESCRIPTIVE INFORMATION.**

FORMATION DESCRIPTION, CONTENTS, ETC.	TOP	BOTTOM	NAME	DEPTH
shale + Limestone	0	722		
Oil Sand	722	736.5	Bartlesville	
Shale	736.5	TD		

USE ADDITIONAL SHEETS, IF NECESSARY, TO COMPLETE WELL RECORD.

Date Received _____

Signature G. Throop

Title Sec.

Date 6-30-80