

KANSAS

WELL COMPLETION REPORT AND *State Geological Survey*
DRILLER'S LOG

WICHITA BRANCH

API No. 15 - 133 - 22,218
County Number

S. 24 T. 28S R. 18 E
Loc. 330 FWL 330 SNL NE 4
County Neosho

Operator
Vera Cruz Petroleum

Address
S. 6312 Helena, Spokane, WA 99203

Well No. T29 Lease Name Cheney

Footage Location
330 feet from (N) line 330 feet from (E) line

Principal Contractor H + M Oil Geologist

Spud Date 12-10-80 Date Completed 12-12-80 Total Depth 774 P.B.T.D.

Directional Deviation Oil and/or Gas Purchaser
Producers' Group

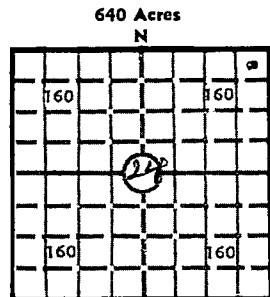

Locate well correctly
Elev.: Gr. _____
DF _____ KB _____

CASING RECORD

Report of all strings set— surface, intermediate, production, etc.

Purpose of string	Size hole drilled	Size casing set (in O.D.)	Weight lbs/ft.	Setting depth	Type cement	Sacks	Type and percent additives
Surface	8	6 5/8	17	60	Port	15	
Casing	6	2 7/8	6 1/2	774	"	85	

LINER RECORD

PERFORATION RECORD

Top, ft.	Bottom, ft.	Sacks cement	Shots per ft.	Size & type	Depth interval
			2	2 1/8 Glass	710-720

Size	Setting depth	Packer set at

ACID, FRACTURE, SHOT, CEMENT SQUEEZE RECORD

Amount and kind of material used	Depth interval treated
Sand + water	710-720

INITIAL PRODUCTION

Date of first production	Producing method (flowing, pumping, gas lift, etc.)				
RATE OF PRODUCTION PER 24 HOURS	Oil	Gas	Water	Gas-oil ratio	
	bbls.	MCF	bbls.	CFPB	
Disposition of gas (vented, used on lease or sold)			Producing interval (s)		

INSTRUCTIONS: As provided in KCC Rule 82-2-125, within 90 days after completion of a well, one completed copy of this Drillers Log shall be transmitted to the State Geological Survey of Kansas, 4150 Monroe Street, Wichita, Kansas 67209. Copies of this form are available from the Conservation Division, State Corporation Commission, 245 No. Water, Wichita, Kansas 67202. Phone AC 316-522-2206. If confidential custody is desired, please note Rule 82-2-125. Drillers Logs will be on open file in the Oil and Gas Division, State Geological Survey of Kansas, Lawrence, Kansas 66044.

Operator Vera Cruz Petroleum DESIGNATE TYPE OF COMP.: OIL, GAS, DRY HOLE, SWDW, ETC.: Oil

Well No. T-19 Lease Name Cheney

S 24 T 28 S R 18 E

WELL LOG

Show all important zones of porosity and contents thereof; cored intervals, and all drill-stem tests, including depth interval tested, cushion used, time tool open, flowing and shut-in pressures, and recoveries.

SHOW GEOLOGICAL MARKERS, LOGS RUN, OR OTHER DESCRIPTIVE INFORMATION.

FORMATION DESCRIPTION, CONTENTS, ETC.	TOP	BOTTOM	NAME	DEPTH
Shale & Limestone	200	710		
Oil Sand	710	720	Bartlesville	
Shale	720	TD		

USE ADDITIONAL SHEETS, IF NECESSARY, TO COMPLETE WELL RECORD.

Date Received _____

Signature Gloria Shoop

Title Sec. Treas.

Date 8-20-81