

IMPORTANT
 Kans. Geo. Survey request
 samples on this well.

15-209-20009
 24-10-246

WICHITA BRANCH
KANSAS DRILLERS LOG

S. 24 T. 10 R. 24
 Loc. NE SW NE
 County Wyandotte

API No. 15 — 209 — 20,009
 County Number

Operator
Charles L. Anderson

Address
4440 North 93rd Kansas City, Kansas 66109

Well No. #1 Lease Name Anderson

Footage Location
 feet from (N) (S) line feet from (E) (W) line

Principal Contractor A.G. GLAZE Geologist

Spud Date 12-30-77 Total Depth 657' P.B.T.D.

Date Completed 1-11-78 Oil Purchaser

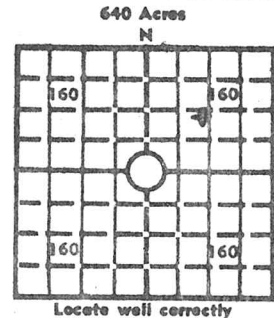

Elev.: Gr. _____
 DF _____ KB _____

CASING RECORD

Report of all strings set — surface, intermediate, production, etc.

Purpose of string	Size hole drilled	Size casing set (in O.D.)	Weight lbs./ft.	Setting depth	Type cement	Sacks	Type and percent additives
Set	8"	200'					
Set	6 1/4"	580'					
Dry hole Pulled All Casing + Plugged Well.							

LINER RECORD

PERFORATION RECORD

Top, ft.	Bottom, ft.	Sacks cement	Shots per ft.	Size & type	Depth interval

TUBING RECORD

Size	Setting depth	Packer set at

ACID, FRACTURE, SHOT, CEMENT SQUEEZE RECORD

Amount and kind of material used	Depth interval treated
Set brush + Rock Bridge + 530' + Cemented	6 SACKS
Set " " " 210' "	10 SACKS
Set " " " 30' "	5 SACKS

INITIAL PRODUCTION

Date of first production _____ Producing method (flowing, pumping, gas lift, etc.) _____

RATE OF PRODUCTION PER 24 HOURS	Oil	Gas	Water	Gas-oil ratio
	bbis.	MCF	bbis.	CFPB

Disposition of gas (vented, used on lease or sold) _____ Producing interval (s) _____

INSTRUCTIONS: As provided in KCC Rule 82-2-125, within 90 days after completion of a well, one completed copy of this Drillers Log shall be transmitted to the State Geological Survey of Kansas, 4150 Monroe Street, Wichita, Kansas 67209. Copies of this form are available from the Conservation Division, State Corporation Commission, 3830 So. Meridian (P.O. Box 17027), Wichita, Kansas 66217. Phone AC 316-522-2206. If confidential custody is desired, please note Rule 82-2-125. Drillers Logs will be on open file in the Oil and Gas Division, State Geological Survey of Kansas, Lawrence, Kansas 66044.

