

State Geological Survey

WICHITA BRANCH
KANSAS DRILLERS LOG

15-209-20013
27-10-256

S. 27 T. 10 R. 25 E
Loc. 1230' SNL 400' WEL
County Wyandotte

API No. 15 —————
County Number

Operator
Port Authority - City of Kansas City, Kansas

Address
c/o McCune Engineering Box 3283 Lawrence, Kansas

Well No. 1 Lease Name Fairfax Airport

Footage Location
1230 feet from (N) line 400 feet from (E) line

Principal Contractor Western Geodrill, Inc. Geologist McCune Engineering

Spud Date July 6, 1979 Total Depth 367' P.B.T.D. 367'

Date Completed July 14, 1979 Oil Purchaser -----

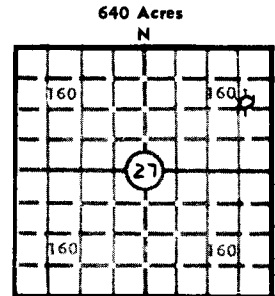

Locate well correctly
Elev.: Gr. 744

DF ----- KB -----

CASING RECORD

Report of all strings set — surface, intermediate, production, etc.

Purpose of string	Size hole drilled	Size casing set (in O.D.)	Weight lbs/ft.	Setting depth	Type cement	Sacks	Type and percent additives
Surface		7"		130'	Portland		
Production		4½"		346.5'	Portland		

LINER RECORD

PERFORATION RECORD

Top, ft.	Bottom, ft.	Sacks cement	Shots per ft.	Size & type	Depth interval
TUBING RECORD			Open-hole		347-367
Size	Setting depth	Packer set at			

ACID, FRACTURE, SHOT, CEMENT SQUEEZE RECORD

Amount and kind of material used	Depth interval treated

INITIAL PRODUCTION

Date of first production		Producing method (flowing, pumping, gas lift, etc.)			
RATE OF PRODUCTION PER 24 HOURS	Oil bbls.	Gas 191 MCF	Water bbls.	Gas-oil ratio CFPB	
Disposition of gas (vented, used on lease or sold)			Producing interval(s) Squirrel SS 347-367'		

INSTRUCTIONS: As provided in KCC Rule 82-2-125, within 90 days after completion of a well, one completed copy of this Drillers Log shall be transmitted to the State Geological Survey of Kansas, 4150 Monroe Street, Wichita, Kansas 67209. Copies of this form are available from the Conservation Division, State Corporation Commission, 3830 So. Meridian (P.O. Box 17027), Wichita, Kansas 66217. Phone AC 316-522-2206. If confidential custody is desired, please note Rule 82-2-125. Drillers Logs will be on open file in the Oil and Gas Division, State Geological Survey of Kansas, Lawrence, Kansas 66044.

Operator Port Authority - City of Kansas City, Kansas DESIGNATE TYPE OF COMP.: OIL, GAS, DRY HOLE, SWDW, ETC.: Gas

Well No. 1 Lease Name Fairfax Airport

S 27 T 10 R 25 E W

WELL LOG

Show all important zones of porosity and contents thereof; cored intervals, and all drill-stem tests, including depth interval tested, cushion used, time tool open, flowing and shut-in pressures, and recoveries.

SHOW GEOLOGICAL MARKERS, LOGS RUN, OR OTHER DESCRIPTIVE INFORMATION.

FORMATION DESCRIPTION, CONTENTS, ETC.	TOP	BOTTOM	NAME	DEPTH
River sand and Gravel	0	103		
Shale	103	117		
Lime	117	124		
Sandstone	124	128		
Shale	128	136		
Lime	136	139		
Shale	139	147		
Sandy Shale	147	149		
Red Bed	149	154		
Lime	154	166		
Sandstone	166	172	Show of free	oil
Shale	172	192		
Lime	192	197		
Black Shale	197	201		
Lime	201	205		
Shale	205	210		
Sandy Shale	210	214	Show of gas	
Shale	214	223		
Lime	223	230		
Shale	230	255		
Lime	255	257		
Black Shale	257	267		
Lime	267	269		
Shale	269	275		
Shaley Lime	275	280		
Shale	280	283		
Lime	283	285		
Shaley Lime	285	301		
Shale	301	303		
Sandy Shale	303	310		
Shale	310	312		
Lime	312	323		
Shale and Limestone	323	345		
Black Shale	345	349		
Sandy Shale	349	355		
Sandstone	355	367 TD	GAS	

USE ADDITIONAL SHEETS, IF NECESSARY, TO COMPLETE WELL RECORD.

Date Received	<p><i>Dwayne McCune</i> _____ Signature</p> <p>Consulting Petroleum Engineer _____ Title</p> <p>July 23, 1979 _____ Date</p>
---------------	--

33-10-322