

McPherson

KANSAS

SECTION 28 TOWNSHIP 19S RANGE 1W

WELL NO. #2 Bair

COMPANY K&P Oil

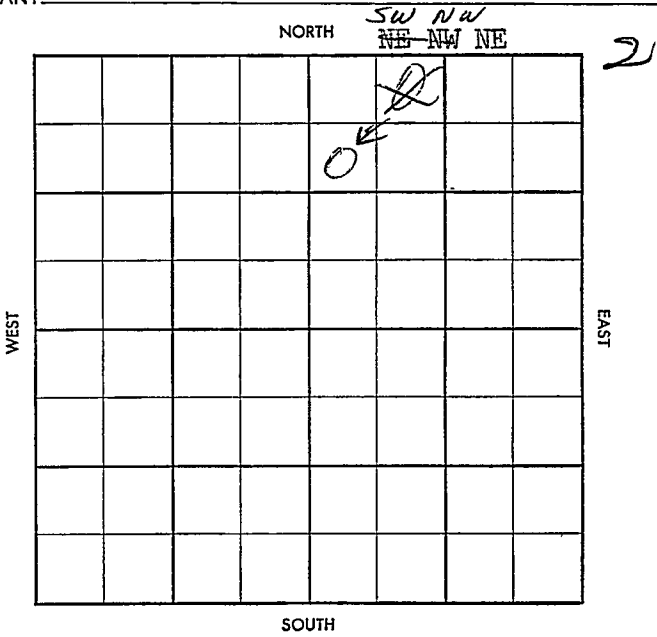

~~XX~~

CO. McPherson ELEV. \_\_\_\_\_  
 SEC. 28 TWP. 19 RGE. 1W  
 COMPANY K & P Oil Co. NO. 2

	0	
01234		
FIRST REPORT		

FARM Bair

LOC. NE NW NE

GEOL. \_\_\_\_\_  
 CONTR. Mallard Tools  
 POOL. Ritz-Canton  
 SPUD. Location

CO. \_\_\_\_\_  
 TWP. \_\_\_\_\_  
 RGE. \_\_\_\_\_  
 SEC. \_\_\_\_\_  
 NO. \_\_\_\_\_

CORRECTION H

5-513-A

CO. McIntosh ELEV. 1585 DF  
SEC. 22 TWP. 10 RGE. 7W  
COMPANY K & P Oil Co. NO. 2

JAN 2 '58

ABANDONED

FARM Bair

LOC. ~~\_\_\_\_\_~~ SWNW NE

GEOL. \_\_\_\_\_  
CONTR. Lallard Tools  
POOL Pitt-Canton  
10-28-57  
SPUD Location

RURT h  
8" 190/  
Miss 2923 RTD  
3017 5 1/2 3016  
woc wocT

net 4 37 LO CD 90/2989-99

1/2 B F Ph 2 hrs sci? \$  
1/4 B F Ph 1 hr soil PB  
2982 92/2951-2979  
\$ 4 B F Ph 4 hrs T  
1500A 7 B F Ph 5 hrs  
2010 oil decreased SBFP  
4 hrs 2010 oil

DEC 26 '57 JAN 2 '58

T.6A