

**KANSAS DRILLERS LOG** State Geological Survey  
WICHITA, BRANCH

API No. 15 — 041 — 20229  
County Number

S. 10 T. 26 R. 19W E  
W  
Loc. NE NE  
County Edwards

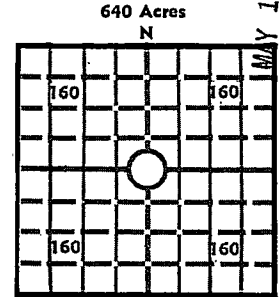

640 Acres  
N  
Locate well correctly  
Elev.: Gr. 2209  
DF 2211 KB 2214

Operator  
**PICKRELL DRILLING COMPANY**

Address  
**205 LITWIN BLDG., WICHITA, KS. 67202**

Well No. 1 Lease Name Schroeter "A"

Footage Location  
feet from (N) (S) line \_\_\_\_\_ feet from (E) (W) line \_\_\_\_\_

Principal Contractor **PICKRELL DRILLING COMPANY** Geologist Dick Linehan

Spud Date 11-27-76 Total Depth 4729 (Corrected RTD) P.B.T.D. \_\_\_\_\_

Date Completed 12-06-76 Oil Purchaser \_\_\_\_\_

**CASING RECORD**

Report of all strings set — surface, intermediate, production, etc.

Purpose of string	Size hole drilled	Size casing set (in O.D.)	Weight lbs/ft.	Setting depth	Type cement	Sacks	Type and percent additives
		8 5/8		320		225	

**LINER RECORD**

**PERFORATION RECORD**

Top, ft.	Bottom, ft.	Sacks cement	Shots per ft.	Size & type	Depth interval

**TUBING RECORD**

Size	Setting depth	Packer set at

**ACID, FRACTURE, SHOT, CEMENT SQUEEZE RECORD**

Amount and kind of material used	Depth interval treated

**INITIAL PRODUCTION**

Date of first production \_\_\_\_\_ Producing method (flowing, pumping, gas lift, etc.) \_\_\_\_\_

RATE OF PRODUCTION PER 24 HOURS	Oil	Gas	Water	Gas-oil ratio
	bbls.	MCF	bbls.	CFPB
Disposition of gas (vented, used on lease or sold)			Producing interval (s)	

**INSTRUCTIONS:** As provided in KCC Rule 82-2-125, within 90 days after completion of a well, one completed copy of this Drillers Log shall be transmitted to the State Geological Survey of Kansas, 4150 Monroe Street, Wichita, Kansas 67209. Copies of this form are available from the Conservation Division, State Corporation Commission, 3830 So. Meridian (P.O. Box 17027), Wichita, Kansas 66217. Phone AC 316-522-2206. If confidential custody is desired, please note Rule 82-2-125. Drillers Logs will be on open file in the Oil and Gas Division, State Geological Survey of Kansas, Lawrence, Kansas 66044.

Operator PICKRELL DRILLING COMPANY

DESIGNATE TYPE OF COMP.: OIL, GAS, DRY HOLE, SWDW, ETC.: Dry Hole

Well No.

1

Lease Name

Schrpeter "A" #1

S 10 T 26 R 19 E W

WELL LOG

Show all important zones of porosity and contents thereof; cored intervals, and all drill-stem tests, including depth interval tested, cushion used, time tool open, flowing and shut-in pressures, and recoveries.

SHOW GEOLOGICAL MARKERS, LOGS RUN, OR OTHER DESCRIPTIVE INFORMATION.

FORMATION DESCRIPTION, CONTENTS, ETC.	TOP	BOTTOM	NAME	DEPTH
Sand & Shale	0	163		
Sand & Shale	163	322		
Shale	322	510		
Shale	510	1115		
Shale	1115	1295		
Shale	1295	1317		
Shale & Lime Stks.,	1317	1840		
Lime & Shale	1840	2140		
Lime & Shale	2140	2410		
Lime & Shale	2410	2588		
Lime & Shale	2588	2840		
Lime & Shale	2840	2996		
Lime & Shale	2996	3156		
Lime & Shale	3156	3340		
Lime & Shale	3340	3505		
Lime & Shale	3505	3653		
Lime & Shale	3653	3825		
Lime & Shale	3825	3987		
Lime & Shale	3987	4128		
Lime & Shale	4128	4237		
Lime & Shale	4237	4318		
Lime & Shale	4318	4428		
Lime & Shale	4428	4505		
Lime & Shale	4505	4585		
Lime & Shale	4585	4674		
Lime & Shale	4674	4725		
Chert	4725	4740		
Corrected RTD 4729'				

USE ADDITIONAL SHEETS, IF NECESSARY, TO COMPLETE WELL RECORD.

Date Received

C. W. Sebitts  
Partner

Signature

Title

12-15-76

Date